



Original

Installation And Service Manual

On-Surface Scissors Lift

Model:XL-7

Cargo Claims

If there is any missing or damaged product during transportation, the buyer must not sign on the shipping paperwork or refuse the shipment. NOTATE ALL DAMAGE OR REFUSE DAMAGED SHIPMENT!



DANGER

Read the entire contents of this manual before using this product. Failure to follow instructions and safety precautions could result in serious injury or even death. Make sure all other operators also read this manual. Keep this manual near the machine so that it can be seen by all users. By proceeding with installation and operation, you agree that you are fully understand the contents of this manual and take full responsibility for the use of the product.

CONTENTS

PROFILE	1
IMPORTANT SAFETY INSTRUCTIONS	3
I. PRODUCT FEATURES AND SPECIFICATIONS	5
II. INSTALLATION REQUIREMENT	8
III. INSTALLATION STEPS	10
IV. EXPLODED VIEW	19
V. TEST RUN	26
VI. OPERATION INSTRUCTIONS	27
VII. MAINTENANCE SCHEDULE	28
VIII. TROUBLE SHOOTING	29
IX. CAR LIFT SAFETY TIPS	30
X. LIFT DISPOSAL	30

Explanation of the safety warning symbols used in this manual

-  DANGER Risk of death or injury
-  WARNING Dangerous or unsafe practices that may result in death or injury
-  CAUTION Dangerous or unsafe practices that may result in personal injury, product damage or property damage
- ATTENTION Conditions that may result in damage to products or property

PROFILE

This instruction manual is specially prepared for you. Your new lift is the product of over a decade of continuous research, testing and development and is the most technologically advanced lift on the market today.

Please make sure to read through this manual before operating the lift.

Record the information on the nameplate label here:

Model No.: _____

Serial No.: _____

Manufacturer date: _____

WARRANTY

The warranty period for the steel structure part of new car lift is 5 years, hydraulic components, bronze bushings, sliders and plastic parts are under warranty for 3 years, and electrical components and sync cable, lock release cable warranty for 2 year. Rubber pads are without warranty. During the warranty period, the manufacturer will repair or replace the defective parts free of charge including shipping costs.

This warranty does not cover damage caused by normal wear and tear, improper use, damage in transit, or damage caused by lack of maintenance.

This warranty is unique and supersedes what is expressed and implied in all other warranties. The manufacturer shall not be liable for any particular, indirect or accidental damage resulting in breach of or delay in the execution of the warranty. The manufacturer reserves the right to design and improve the product and has no obligation to make notice of the changes in advance.

The product warranty based on the above clause is based on the model number and serial number of the equipment. This information must be provided in conjunction with all warranty information at the time of service and warranty.

SAFETY WARNING LABEL



Fig.1

IMPORTANT SAFETY INSTRUCTIONS

In order to properly maintain your product and ensure operator safety, it is the responsibility of the product owner to read and follow these instructions!

1. Ensure product installation complies with all applicable local regulations and rules, such as Occupational Safety and Health Administration regulations and electrical codes.
2. Ensure that all operators are properly trained, know how to operate the unit safely, and are properly supervised.
3. Do not operate the lift until you are sure all parts are in place and operating correctly.
4. Keep your hands and feet away from the machine. Keep hands and feet away from any moving parts. Keep your feet away from the lift as it descends to avoid pressing on pointed objects.
5. Keep the work area clean. A cluttered workspace can lead to injuries.
6. The machine is only approved for indoor installation and use. Outdoor installation is prohibited.
7. Only trained operators are allowed to handle the lift machine. All untrained persons must stay away from the workplace. Never allow untrained persons to handle or operate the machine.
8. Use the lift properly. Use the lift in the correct way.
9. Warning! Keep persons and objects from the lift when lifting the a vehicle.
10. If the vehicle is at risk of falling, make sure no one is around the lift.
11. Before preparing to approach or service the vehicle, ensure that the safety device is in effect.
12. Dress appropriately when operating machines, and consider wearing non-slip steel-toe shoes for added safety.
13. Beware of electric shock. In order to protect the operator from electric shock, the lift in use must be grounded. Do not connect the green wire to the terminal. This is the ground wire.
14. Danger! The power supply used in this type of lift has high voltage. Please disconnect the power supply before any circuit repair. Unplug in case the power supply is accidentally switched on during maintenance.

15. Warning! There is a risk of explosion. There are parts in the equipment that produce arc light and spark. Do not operate near flammable gas. This machine should not be placed in the lounge or basement.
16. Maintain with care. Keep the machine clean for better and safer operation. Perform proper lubrication and maintenance procedures according to the manual. Keep handles or buttons clean, dry, and free of oil.
17. Stay alert. Use common sense to observe what you are doing and stay alert.
18. Check for damaged parts. Check for adjustments to moving parts, damage to parts, or anything that may affect their operation. Do not use the machine if the parts are damaged.
19. Do not remove relevant safety parts from the machine. Do not use a lift if it is damaged or missing.
20. Only operate the lift at temperature between 41°F to 104°F (5°C to 40°C).

 **DANGER** Be very careful when installing, operating, maintaining or repairing this equipment. Failure to comply may result in property damage, product damage, injury or (in very rare cases) death. Ensure that only authorized personnel operate the equipment. All repairs must be carried out by an authorized technician. Do not modify the machine, this voids the warranty and increases the probability of personal injury or property damage. Ensure to read and follow this instructions on the label.

I. PRODUCT FEATURES AND SPECIFICATIONS ON SURFACE SCISSORS LIFT MODEL XL-7

- Electronic control operating system, easy to operate.
- Anti-explosion design oil oil circuit with hydraulic lock.
- Four cylinders group structure and dual oil outlet synchronous system, ensure lifting synchronization.
- Pressure compensated flow restrictor control system, ensure the stable lower speed.
- Flip-lock ramps can be used as extended platforms to accommodate different wheelbases.



Fig. 2

DIMENSION

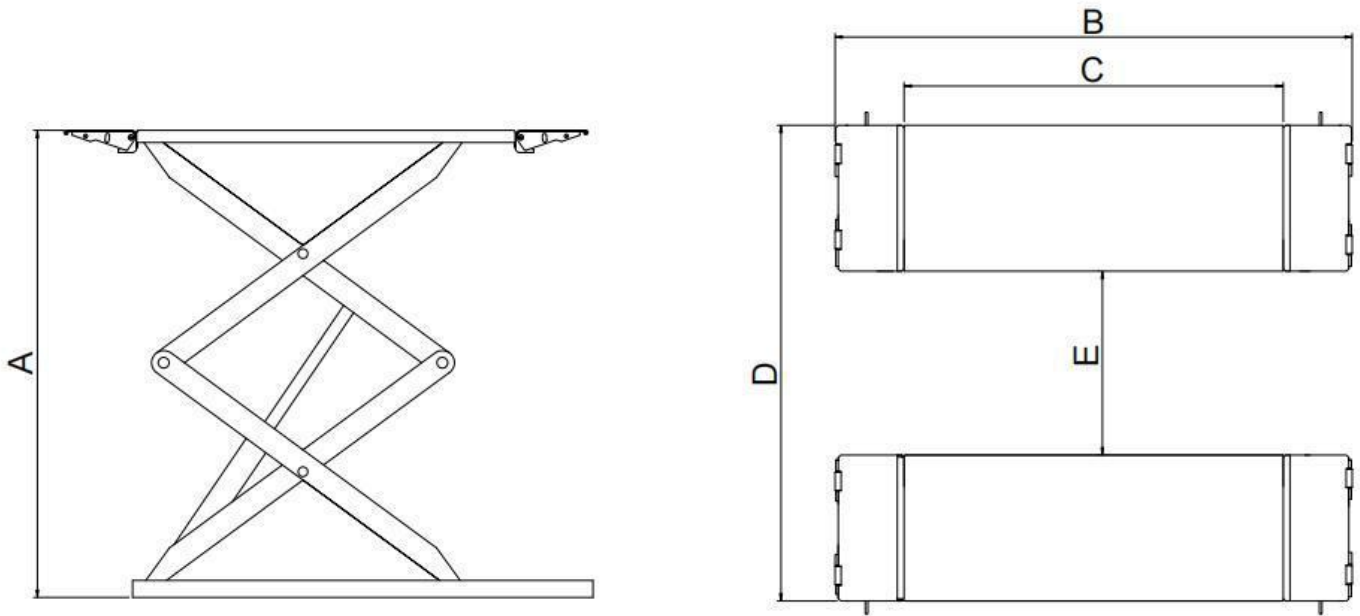

Fig. 3

MODEL XL-7 SPECIFICATIONS

Model	Capacity	Lifting time	A		B	C	D	E	Motor
			Lifting height	Min. Height	Overall Length (include ramps)	Overall Length (exclude ramps)	Overall Width	Width between Runways	
XL-7	7000lbs	50s	78 3/4"	4 5/8"	80"	57 5/8"	76 3/4"	29 1/2"	2.0HP

⚠ CAUTION When driving the vehicle, stay in the middle between the platforms. Any hit to any part of the lift, would cause damage to the lift or the vehicle.

A. Control cabinet placement diagram 1. see Fig.4

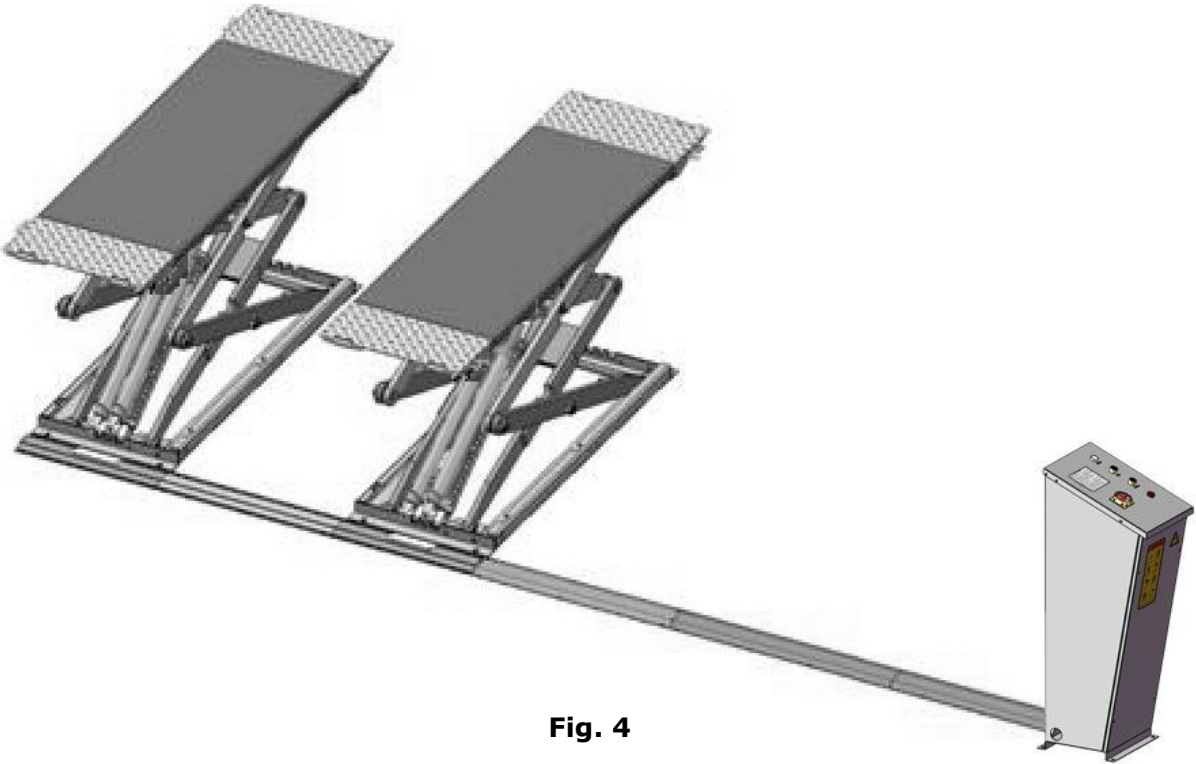

Fig. 4

B. Control cabinet placement diagram 2.see Fig.5

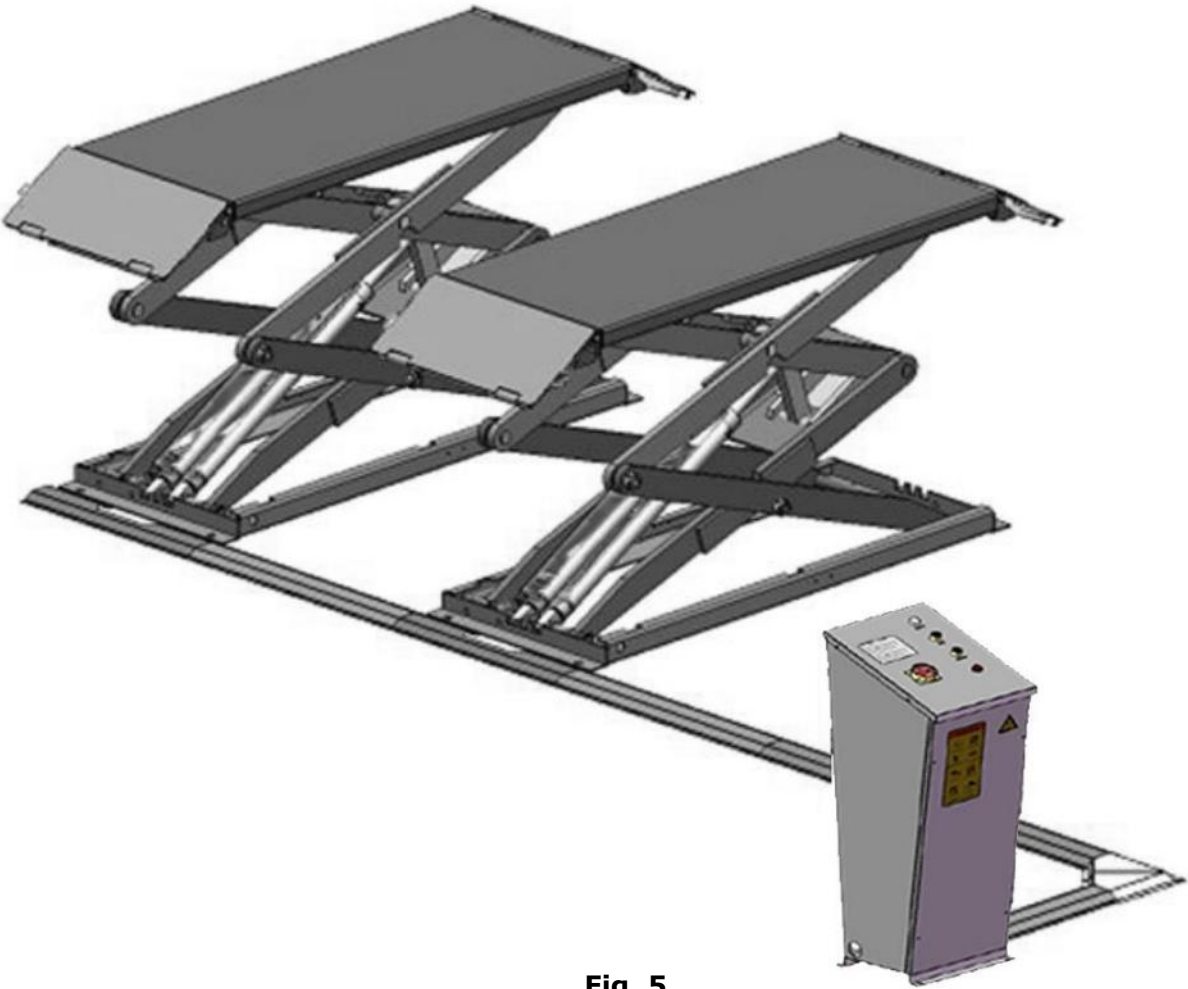

Fig. 5

II. INSTALLATION REQUIREMENT

A. TOOLS REQUIRED

↪ Rotary Hammer Drill ($\Phi 19$, $\Phi 10$, $\Phi 4$)



↪ Hammer



↪ Level Bar



↪ English Spanner (12")



↪ Wrench set (8#, 17#)



↪ Grease Gun



↪ Carpenter's Chalk



↪ Screw Sets



↪ Tape Measure (7.5m)



↪ Pliers



↪ Lock Wrench



↪ Ratchet Spanner With Socket (28#)



Fig. 6

B. Equipment storage and installation requirements.

1. Store the equipment in a dry, non-moldy, non-flammable environment.
2. The lift is only approved for indoor installation and use, and outdoor installation is prohibited.
3. When installing the device, take safety precautions according to the instructions to avoid device damage.
4. During installation, all parts should be fastened to ensure the stability and smooth operation of the machine.
5. After installation, the whole machine should be checked to make sure that every component is working properly.

C. The equipment should be unloaded and transferred by forklift.

Fig. 7

D. SPECIFICATIONS OF CONCRETE

Specifications of concrete must be adhered to the specifications as following.

Failure to do so may result in lift and/or vehicle falling.

1. Position of the lift: Design with a professional architect if possible. Check the required layout dimensions to ensure sufficient space.
2. Overhead obstruction: There should be no obstacles above the position of the lift, such as heat sources, building support columns and wires.
3. Concrete: floors must be level and contain no cracks or holes. Concrete must be of test strength 3,000psi (210kg/cm²) minimum, thickness 100mm minimum. Failure to comply with this requirement may cause injury.

E. POWER SUPPLY

1. You are required to use a licensed and qualified electrician for the installation process.
2. The power supply capacity must be more than 3.0HP, with a cord larger than 12AWG, and must be properly grounded.

⚠ DANGER All electrical wiring must be performed by a licensed and certified electrician. Attempting to connect the circuit without proper certification may result in damage to the lift or electrocution, resulting in serious injury or death.

III. INSTALLATION STEPS

A. Check the parts before assembly

1. Packaged lift and control cabinet (See Fig. 8).



Fig. 8

2. Move aside all parts to the installation site, open the outer packing and check the parts according to the shipment parts list (See Fig. 9).

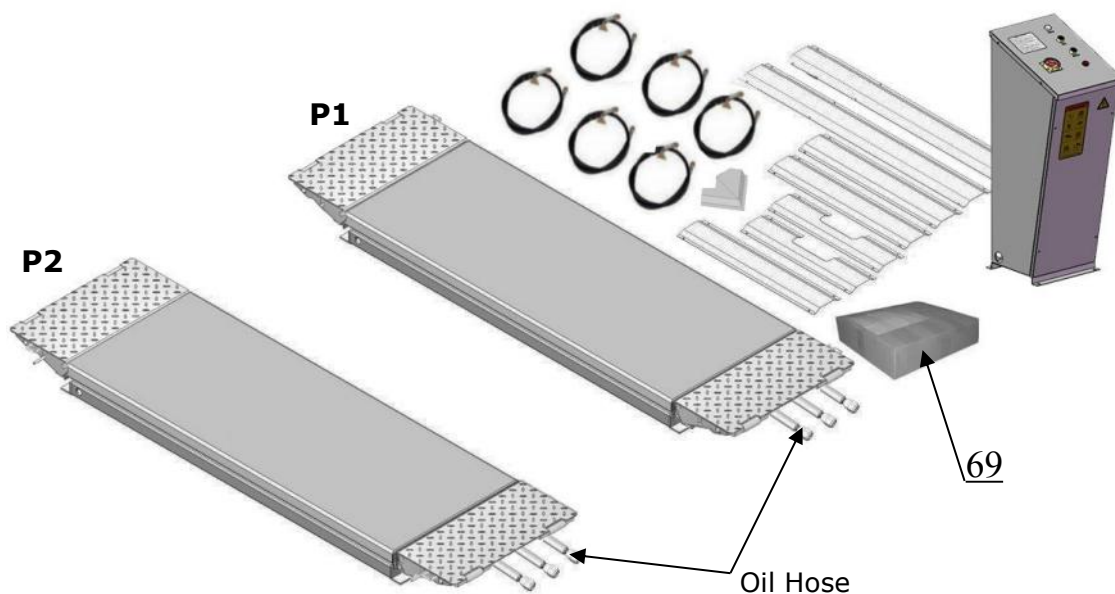

Fig. 9

3. Open the parts box, check the parts according to the part list (**See Fig. 10**).



Fig. 10

4. Check the parts of the parts bag according to the parts bag list (**See Fig.11**).

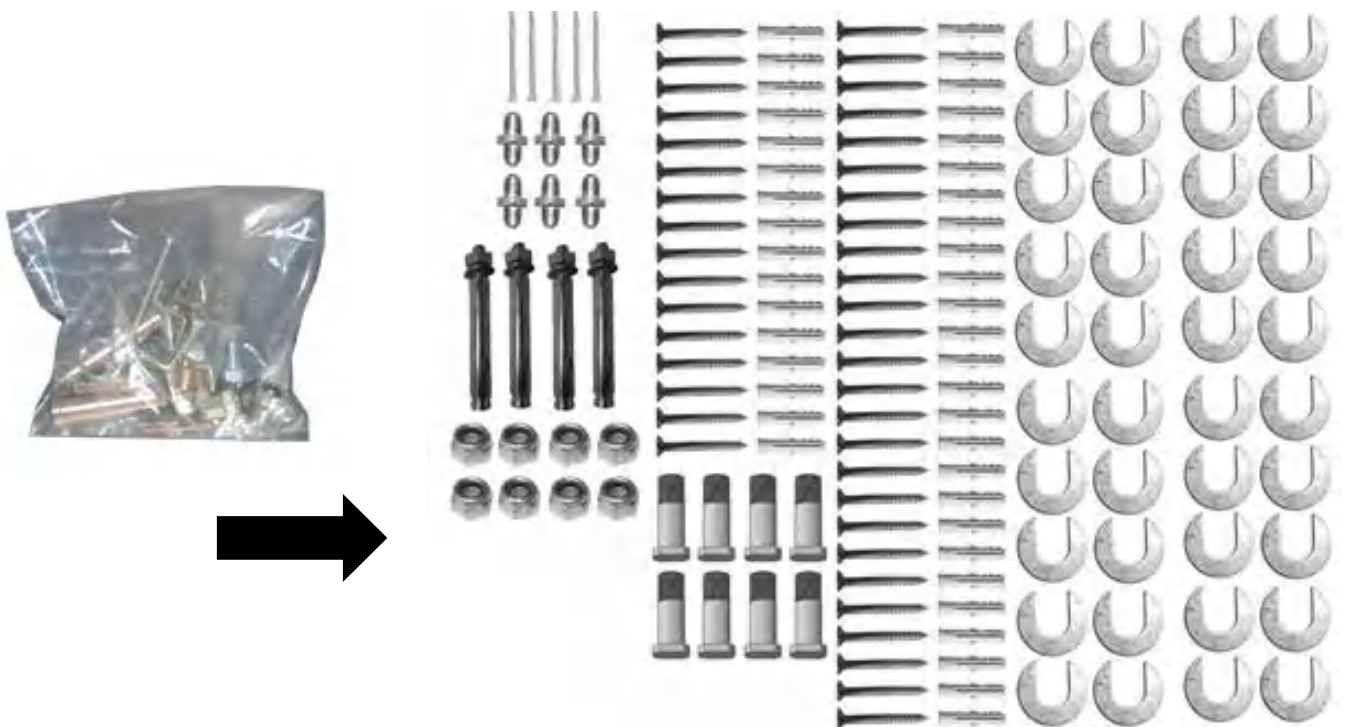

Fig. 11

B. Location of installation

Select a suitable location based on the foundation drawing and installation dimensions (see fig 12) , ensuring the space meets the requirements for your lift type before preparing the foundation.

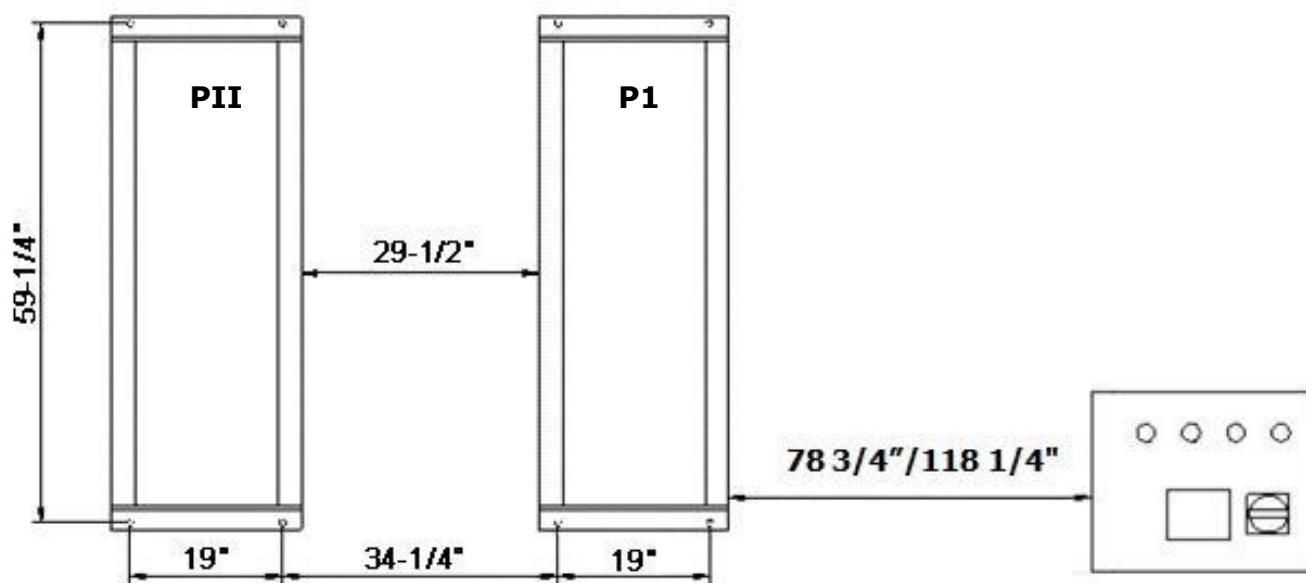
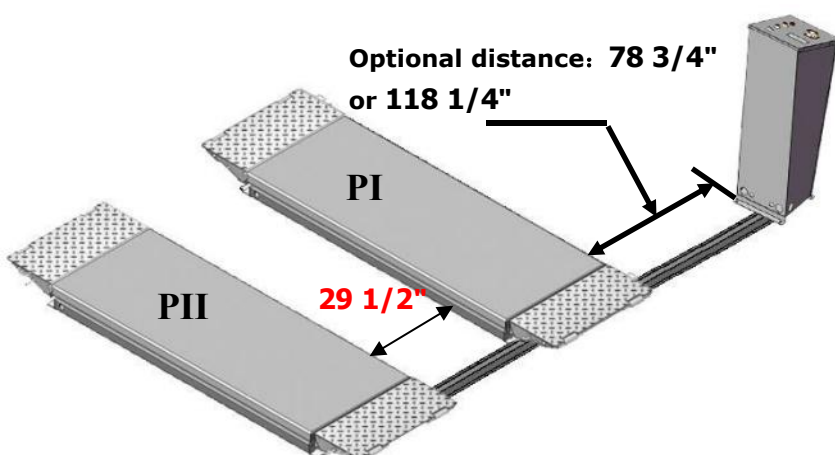

Fig. 12

C. Equipment layout and oil hose installation

1. Installation dimension and oil hose length.

Choose **78 3/4"** or **118 1/4"** installation distance according to the site and actual requirements.



No.	Part No.	Description
60	1003285009	⑦ Oil Hose 1/4*109 1/16"
58	1003285012	⑧ Oil Hose 1/4*103 1/8"
57	1003285008	⑨ Oil Hose 1/4* 99 5/8"
56	1003285010	⑩ Oil Hose 1/4* 148 13/16"
59	1003285013	⑪ Oil Hose 1/4*156 5/16"
61	1003285011	⑫ Oil Hose 1/4* 158 11/16"
71	1003105007	⑭ Oil Hose 1/4*37 3/8"

Fig. 13

2. Connect the oil hoses between control cabinet and the lift. No. ⑭ oil hose only used for **118 1/4"** installation distance.

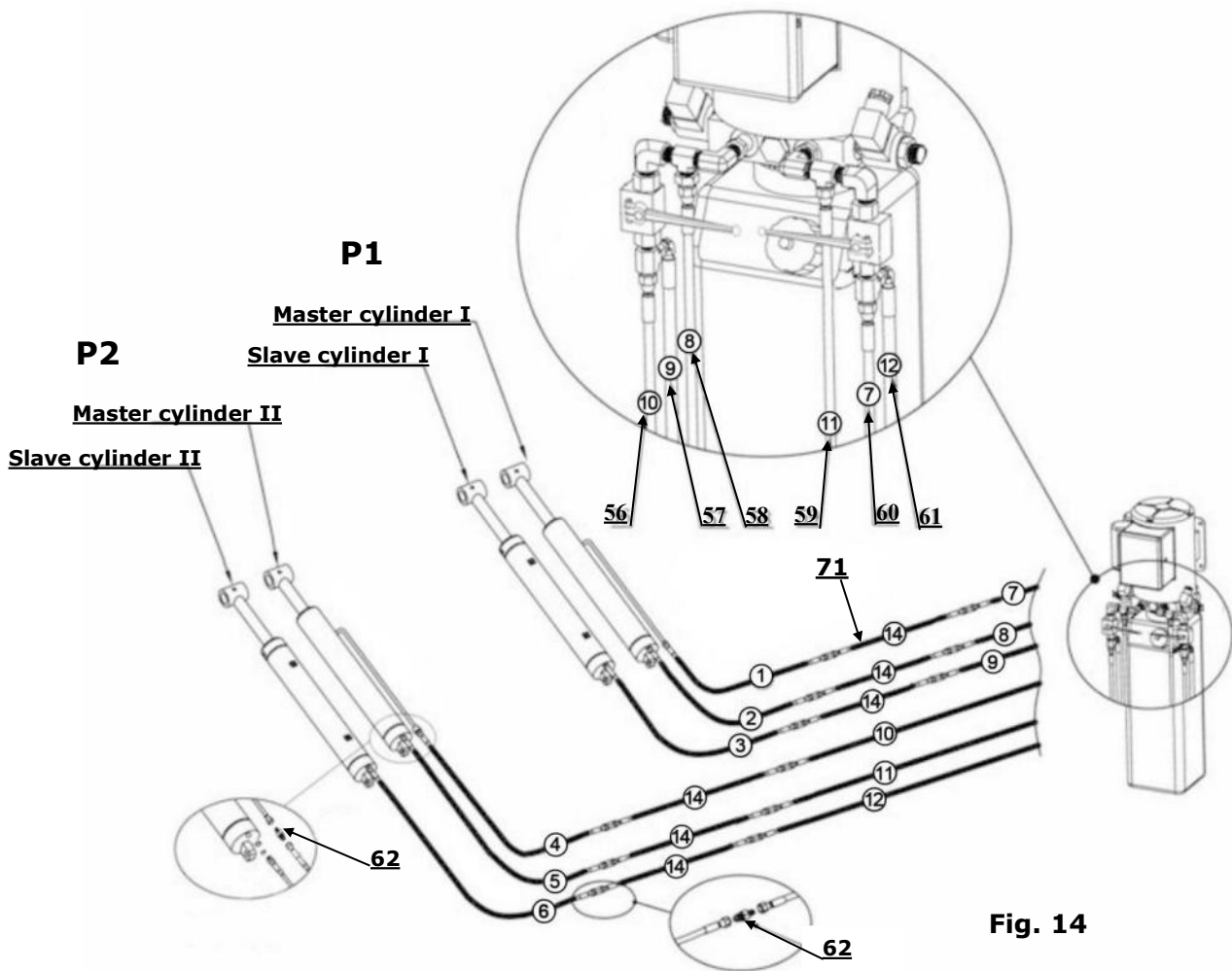

Fig. 14

D. Install electric system

1. Wire connection for power unit **(for Single phase motor)**

1.1 Connect the power wire and limit switch wire according to the wiring diagram (See **Fig. 15**).

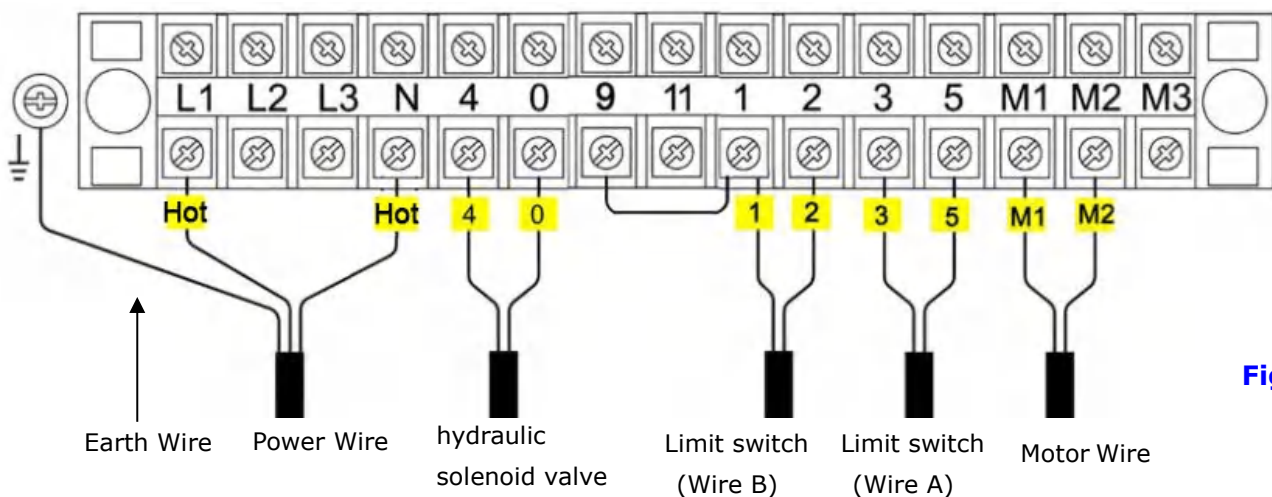

Fig. 15

1.2 Circuit Diagram (See Fig. 16).

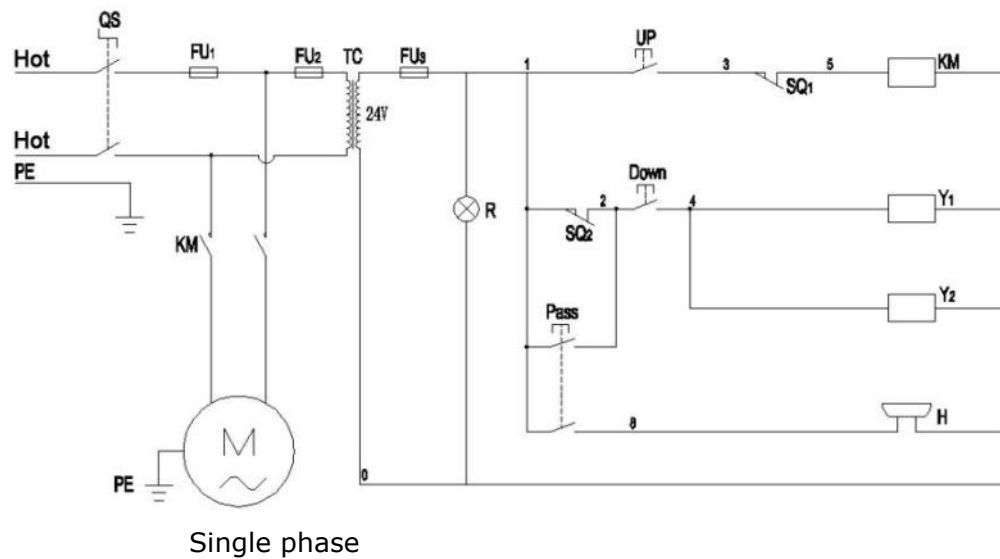

Fig. 16

Electric Component

Item	Name	Code	Specification
1	Power switch	QS	220V AC
2	Breaker	FU ₁	2P
3	Breaker	FU ₂	1P
4	Breaker	FU ₃	1P
5	AC contactor	KM	24V AC
6	Limit switch	SQ _(1~2)	10A
7	Hydraulic solenoid valve (Right)	Y ₂	24V AC
8	Hydraulic solenoid valve (Left)	Y ₁	24V AC
9	Push button	Down	Single
		Pass	Duplex
10	Push button	Up	Single
11	Motor	M	Single phase
12	Transformer	TC	24V AC
13	Alarm	H	24V AC
14	Power Indicator	R	24V AC

2. Limit switch installation instruction

2.1 High limit switch instruction (See Fig. 17)

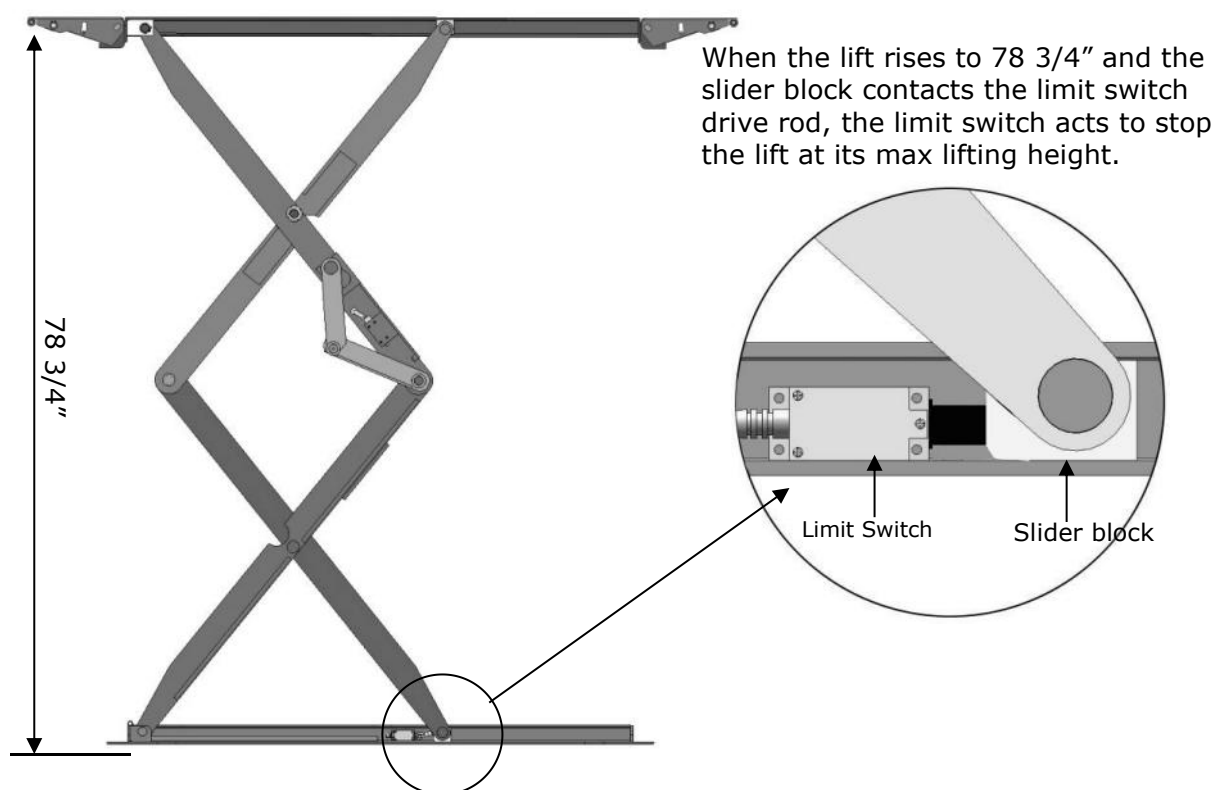

Fig. 17

3.2 Lower alarm device instruction (See Fig.18)

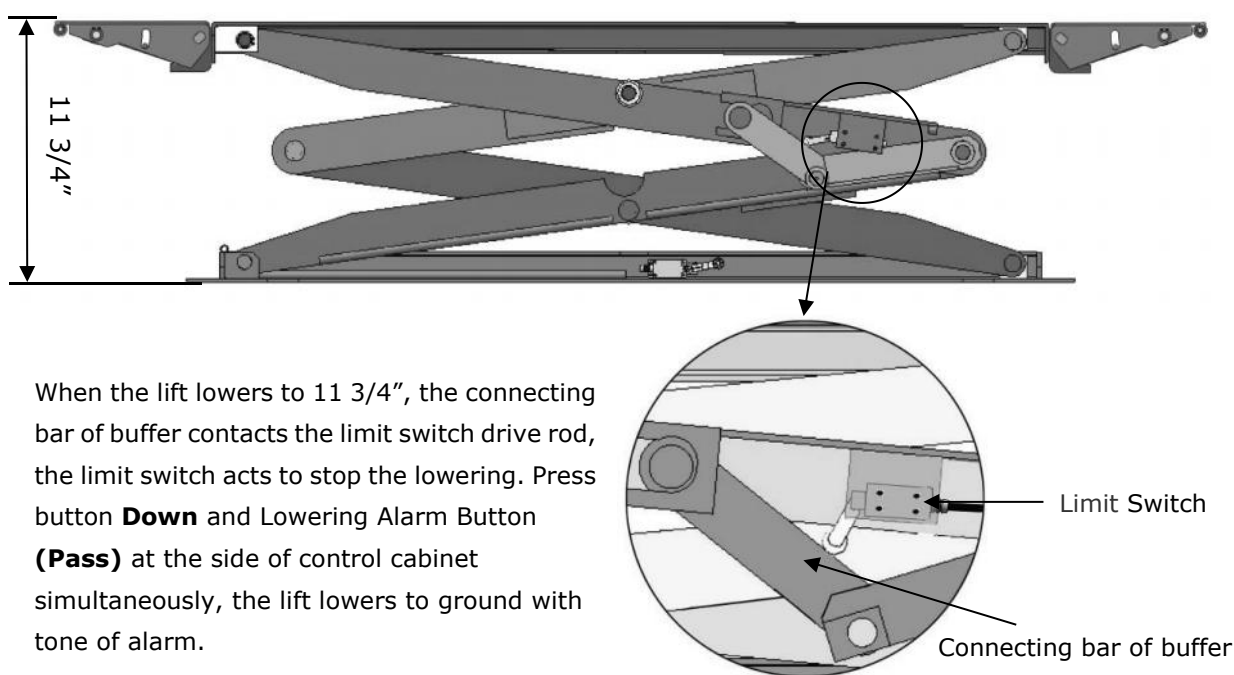

Fig. 18

E. Level the platforms and install anchor bolts

1. Measure the platforms with level bar and adjust with shims until two platforms are in the same level.

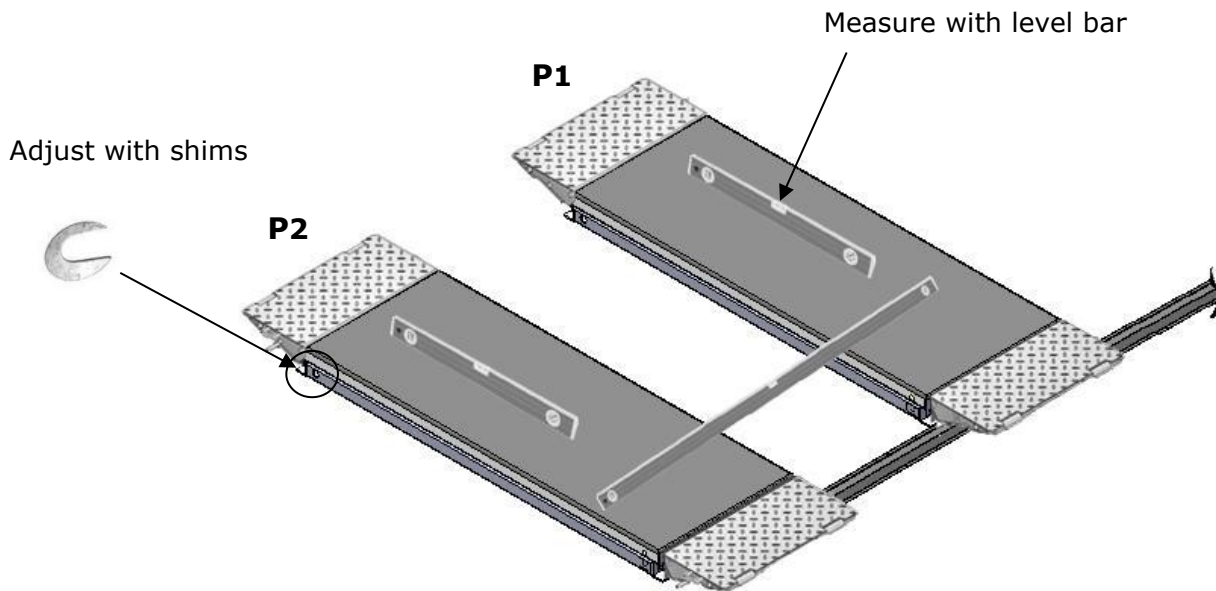

Fig. 19

2. Anchor bolts installation

- 2.1 Lift the machine to 40" for the anchor bolt installation.

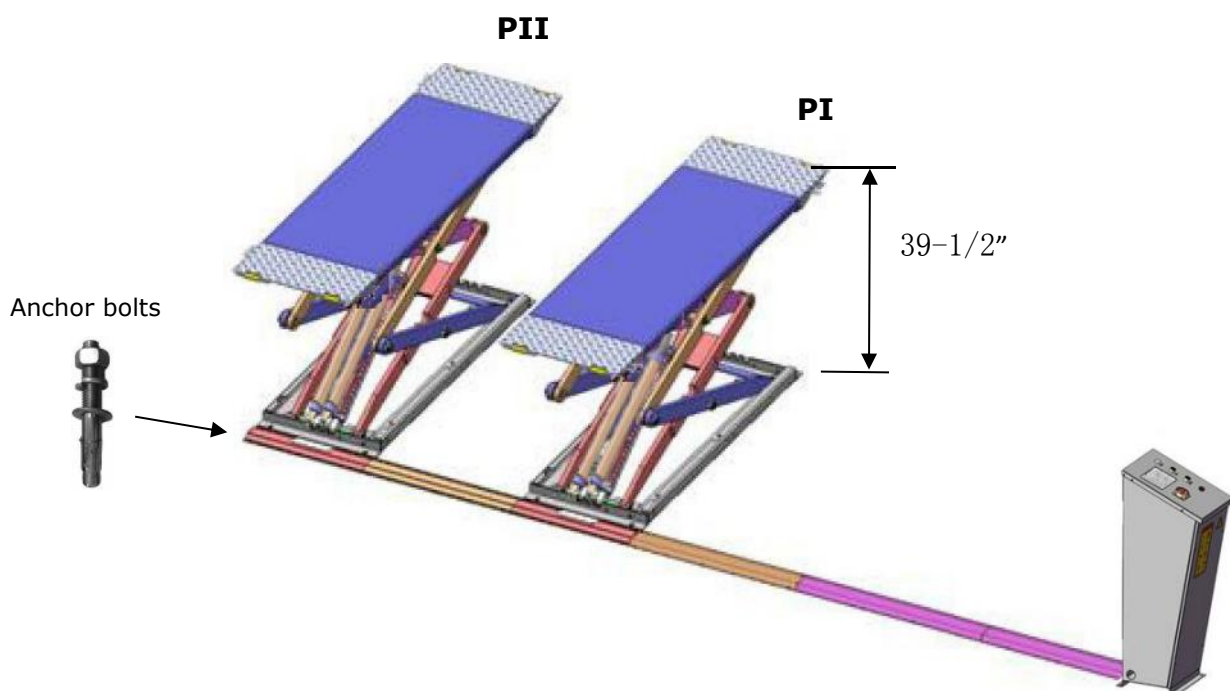

Fig. 20

2.2 Drill holes for the anchor bolt with the rotary hammer drill, type the anchor bolt into the ground, and then fasten it with ratchet spanner.

Note: The Torque of anchor bolt is 150 N.m, the length inside ground of anchor bolt must be 4 1/2" minimum.

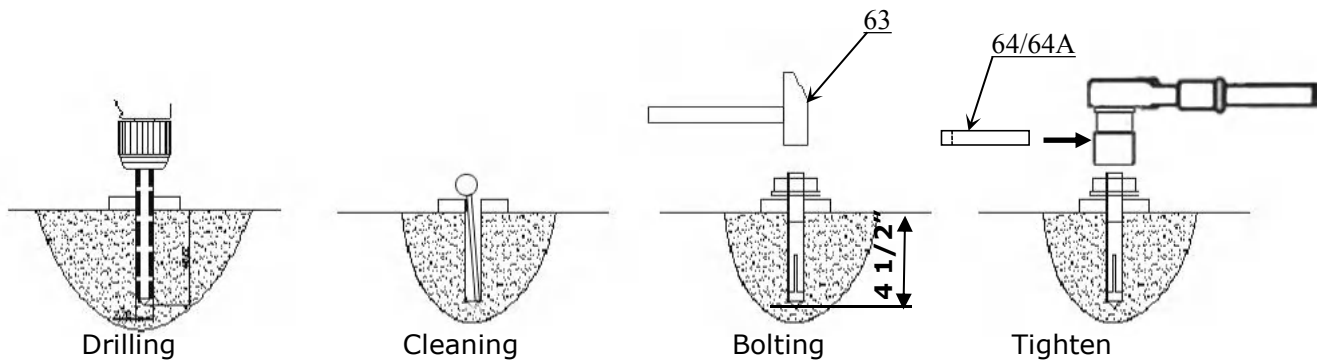

Fig. 21

F. Install oil hose protective cover and control cabinet anchor bolts.

1. Arrange the oil hoses and wires, cover the oil hose protective cover and set up the control cabinet. (See Fig. 22, Fig 23)

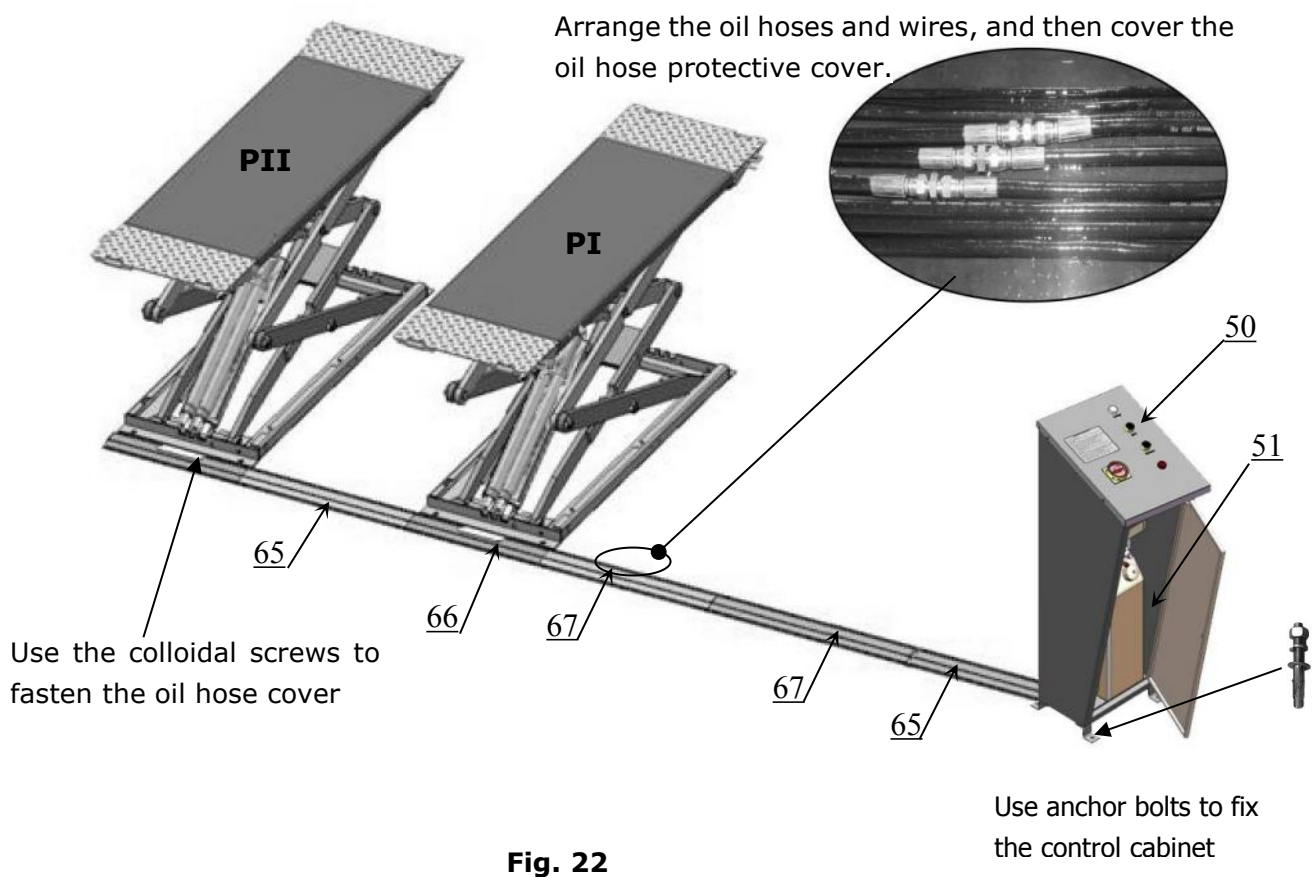
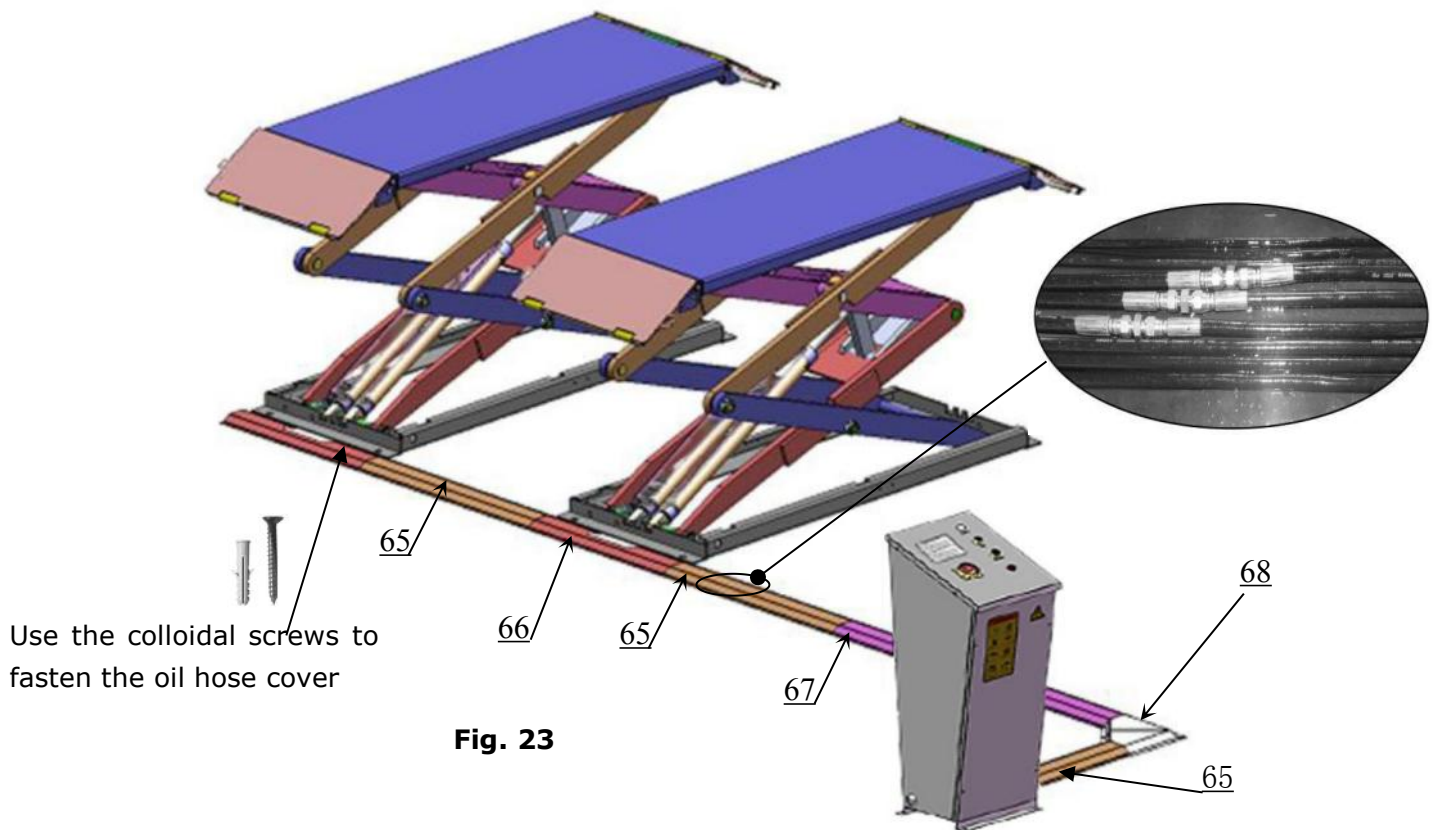

Fig. 22

Optional control cabinet placement



2. Install the colloidal screw of oil hose cover (**See Fig. 24**).

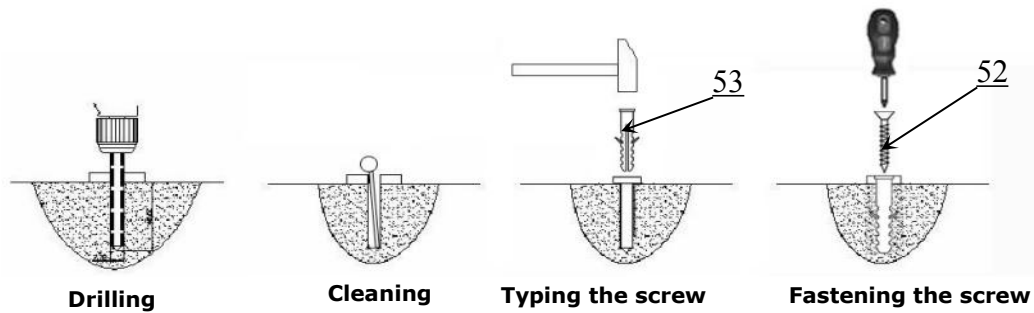

Fig. 24

3. Install the control cabinet anchor bolt (**See Fig. 25**)

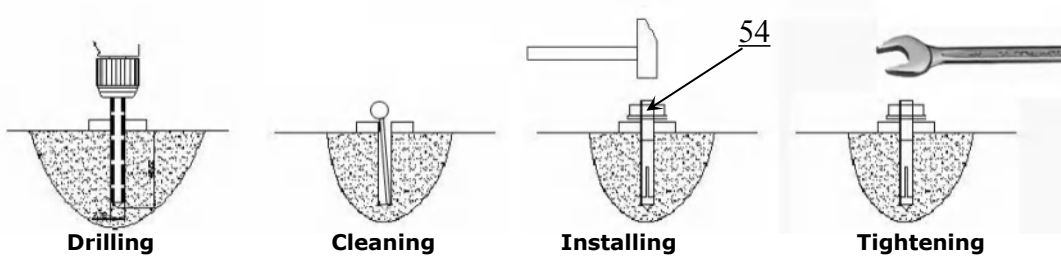

Fig. 25

IV. EXPLODED VIEW

MODEL XL-7

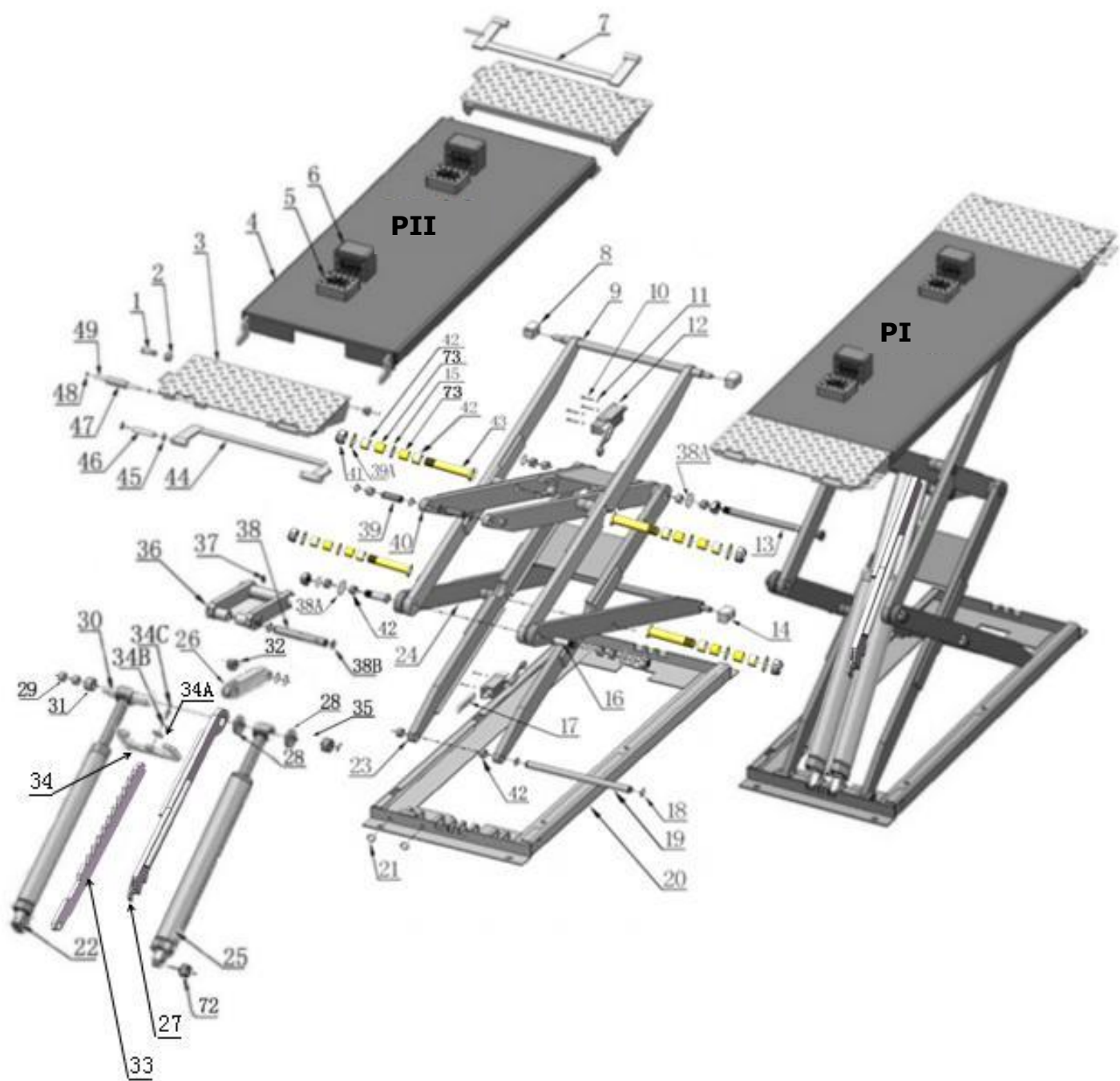

Fig. 26

PARTS LIST FOR XL-7

Item	Part No.	Description	QTY.
1	11620124	Pin for drive in ramp	8
2	10650024	Nylok nut M16	8
3	11620128	Drive-in ramp	4
4	11620001B-01	Platform	2
5	10620034	Rubber Pad 120*100*38	4
6	10610070	Rubber Pad 120*100*70	4
7	11620129	Support frame for drive-in ramp (Left)	2
8	1003105013	Slider block (white) 60*42*23	4
9	11620026B-02	Upper scissor (outer)	2
10	10203018	Socket bolt M5*15	6
11	10420152	Flat washer $\phi 5$	6
12	10206013	Limit switch	2
13	11620011A-01	Scissors pin $\phi 25 \times 370$	2
14	1003105012	Slider block (white) 33*42*80	4
15	10620117	Flat washer	8
16	1103102002A-01	Scissors pin $\phi 25 \times 85$	4
17	11620060	Fix plate for limit switch	1
18	10206032	Clip ring $\phi 25$	16
19	11620014A	Pin for base $\phi 25 \times 392$	2
20	11620017B-02	Base	2
21	1003105011	Protection ring	2
22	C804308	Slave cylinder $\phi 60 \times \phi 70 \times 560$	2
23	11620033A-02	Lower scissor (Inner)	2
24	11620031A-02	Lower scissor (Outer)	2
25	C804307	Master cylinder $\phi 75 \times \phi 85 \times 560$	2
26	11620134-03	Connecting bar of buffer	2
27	11620133A-01	Automatic locking support plate	2
28	1103102003-01	Limit bush $\phi 60 \times \phi 38.5 \times 9$	2
29	1004542002	Bronze bush $\phi 36 \times \phi 30.1 \times 16$	8
30	11620025A-01	Cylinder support pin $\phi 38 \times 223.5$	2
31	11620024A-01	Roller $\phi 52 \times 32$	4
32	10620141	Bronze Bush $\phi 36 \times \phi 30.1 \times 24$	2
33	11620754-02	Self-locking teeth plate	2
34	11620131A	Connecting plate	2
34A	11620122	Limit block	2
34B	10209039	Lock washer $\phi 10$	2
34C	10720002	Socket bolt M10*25	2
35	1103295002	Cushion $\phi 60 \times \phi 38.5 \times 2.8$	2
36	11620010B	Buffer	2
38	11620008A-01	Connecting pin for buffer $\phi 30 \times 192$	2
38A	1003105003	Cushion $\phi 65 \times \phi 25.5 \times 8$	8

Item	Part No.	Description	QTY.
38B	10610008	φ30 Clip ring	4
39	11620028A	Pin for platform φ25*72	4
39A	10640109	Flat washer φ44*φ25.5*2	16
40	11620027B-02	Upper scissor (inner)	2
41	10620022	Nylok nut M24*2.5	14
42	10203004A	Bronze bush φ31*φ25.1*21	40
43	1103102001A	Scissor pin	8
44	11620130	Support frame (right)	2
45	10420037	φ16 clip ring	16
46	11620123	Connecting pin φ16*90	8
47	11610667	Roller for ramp	8
48	10209010	φ10 Clip in	16
49	11620043	Pin for roller	8
50	1003287001	Control cabinet	1
51		Power unit	1
52	10620069	Wood screw M4*30	42
53	10620070	Colloidal screw φ6	42
54	10620071	Anchor bolts M10*100	4
55	10620072	②③④⑤ Oil hose assy. 1/4" x 25 9/16"	4
55A	10620103	O ring φ11*2.5	4
55B	10620102	Seal Ring φ16*φ19*1.8	4
56	1003285010	⑩ Oil hose assy.	1
57	1003285008	⑨ Oil hose assy.	1
58	1003285012	⑧ Oil hose assy.	1
59	1003285013	⑪ Oil hose assy.	1
60	1003285009	⑦ Oil hose assy.	1
61	1003285011	⑫ Oil hose assy.	1
62	10620079	Straight fitting 1/4JIC(M)*1/4JIC(M)	8
63	10209059	Anchor bolts	8
64	10620065	Shim (2mm)	20
64A	10201090	Shim (1mm)	20
65	11620035A	Oil hose protective cover (29 7/16")	3
66	11620066	Oil hose protective cover (23 5/8")	2
67	11510037	Oil hose protective cover (41 3/4")	2
68	11620161	Oil hose protective cover	1
69	10620500A	Parts box	1
70	1003105006	①④ oil hose assy. 1/4" x 25 9/16"	2
71	1003105007	⑭ Oil hose assy.	6
72	1003105010	Bush φ28*φ25*30	4
73	1003105008	Bush φ28*φ25*25	16

4.1 Master Cylinder **C804307** (Old 10620012B)

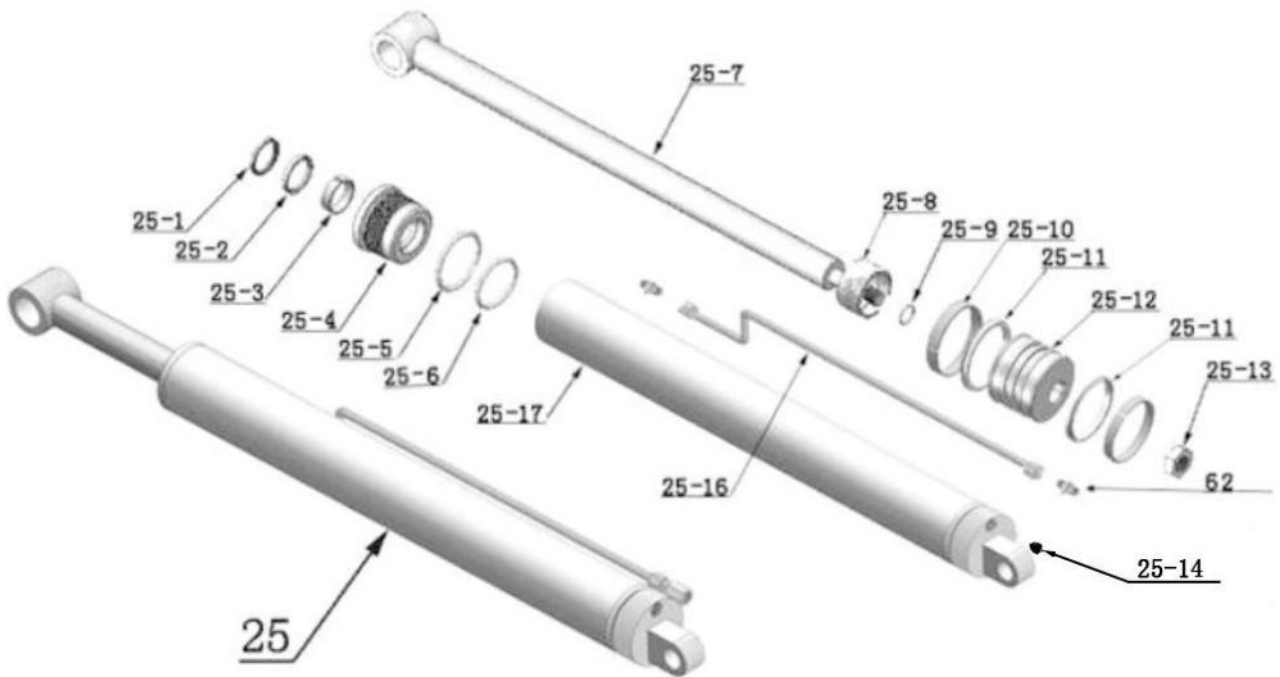

Fig 27

Item	Part No.	Description	QTY.
25-1	10209078	Dust ring	4
25-2	10217243	Y ring	2
25-3	10620047	Support ring	2
25-4	11620192	Head cap	2
25-5	10620171	O ring	2
25-6	10630027	O ring	2
25-7	11620051-01	Piston rod	4
25-8	11620193	Spacer for cylinder	2
25-9	10620197	O ring	4
25-10	10620053	Support ring	2
25-11	10620054	Y ring	4
25-12	11620194	Piston	2
25-13	10206071	Hex nut	4
25-14	C802006	G1/4 anti-explosion valve	2
25-15	10620127	Oil hose fitting	2
25-16	10620125A-01	Oil hose assy.	2
25-17	11620050A-01	Bore weldment	2

4.2 Slave Cylinder **C804308** (Old code 10620186)

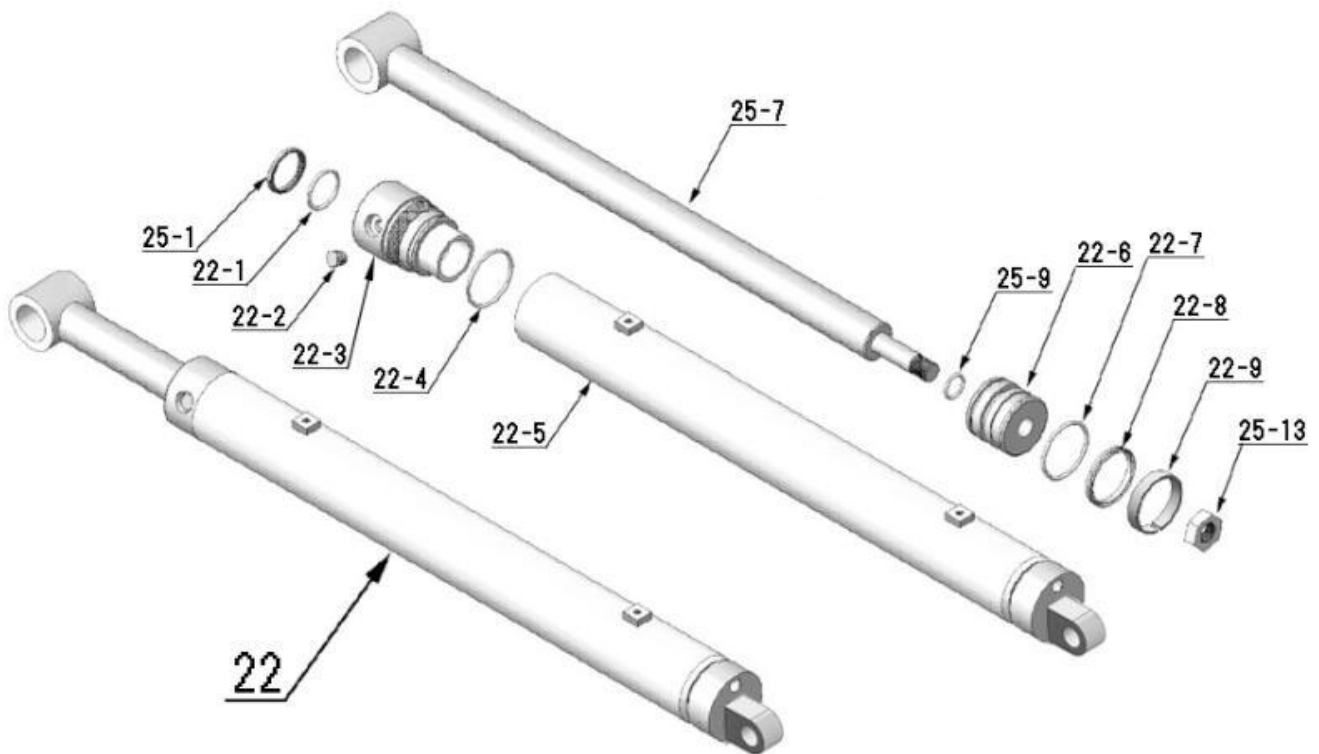

Fig. 28

Item	Part No.	Description	QTY.
22-1	10520058	O ring	2
22-2	10201034	Bleeding plug	2
22-3	11620190	Head cap	2
22-4	10620182	O ring	2
22-5	11620056-01	Bore weldment	2
22-6	11620196	Piston	2
22-7	10217258	O ring	2
22-8	10217257	Y ring	2
22-9	10217256	Support ring	2

4.3 CONTROL CABINET

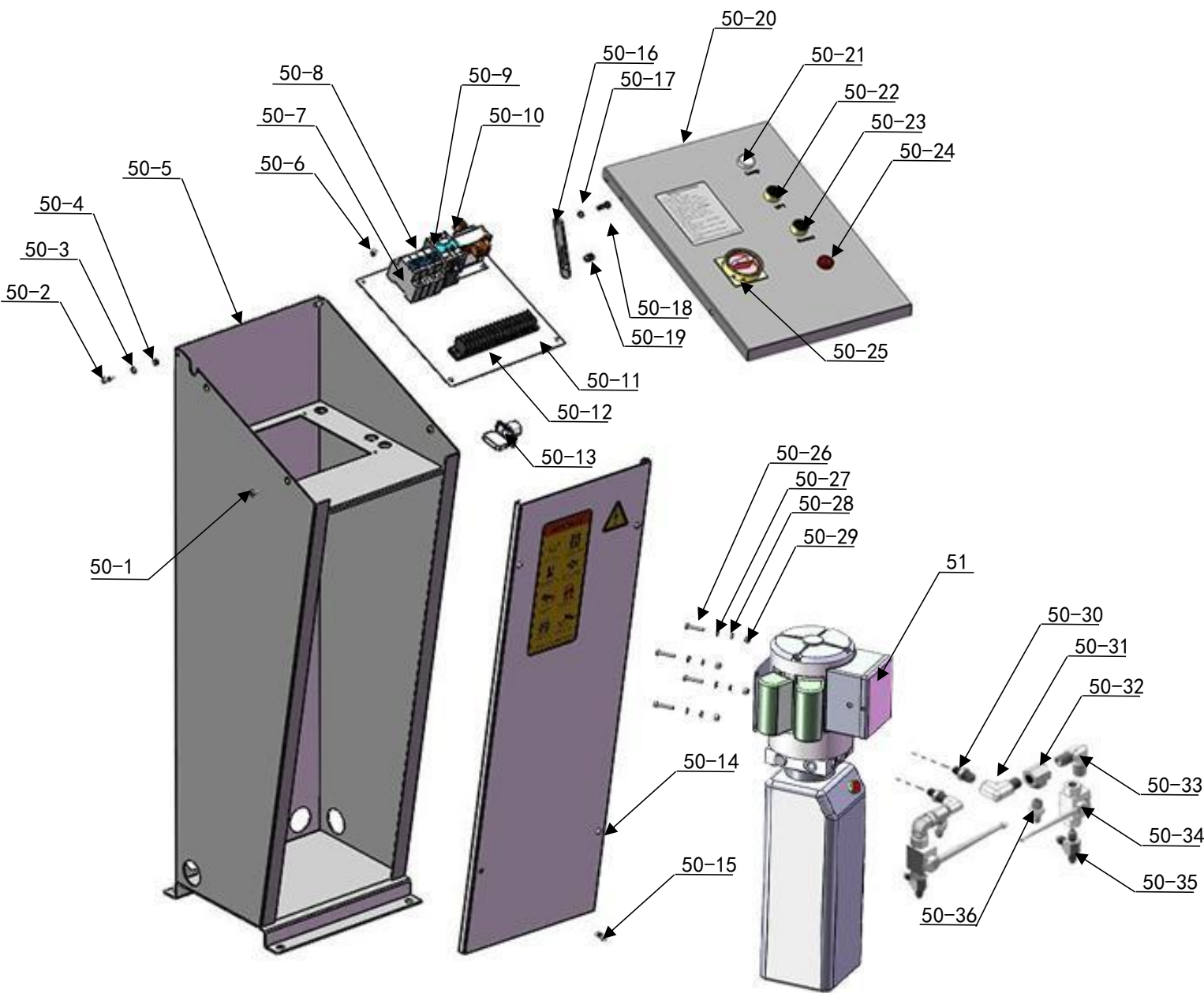

Fig. 29

Item	Part No.	Description	QTY.
50-1	10209145A	Round head boltM6*12(Include flat washer)	2
50-2	10420153	Round head bolt M6*20	2
50-3	10420045	Flat washerφ6	2
50-4	10420018	Self-locking nut M6	2
50-5	1162K001A	Cabinet	1
50-6	1061K052	Round head bolt M4*8(Include flat washer)	15
50-7	10202046	Breaker TGB1N-63/2P 25A (single phase)	1
50-7	10202047	Breaker TGB1N-63/2P 16A (three phase)	1
50-8	10202049	TGB1V-63/1P 6A	2
50-9	10420084A	24V AC Contractor (KM)	1
50-10	10420134	24V Transformer (TC)	1
50-11	10620099	Panel for Installing Element	1
50-12	1002337001	16 Terminal connector	1
50-13	10420142	Lower Alarm Button (Pass)	1
50-14	1162K012	Cabinet door	1
50-15	10720038	Round head boltM6*30(Include flat washer)	4
50-16	11510723	Support plate	1
50-17	10217011	Round head boltM6	1
50-18	10217013	Round head boltM6*20	1
50-19	1061K108	Round head boltM6*12	1
50-20	1162K007	Control panel	1
50-21	10201094	Work indicating lamp	1
50-22	10420070	Button (UP)	1
50-23	10420070	Button (Down)	1
50-24	10420143	Alarm (H)	1
50-25	1004187002	Power Switch (only for single phase)	1
	1004187003	Power Switch (only for three phase)	1
50-26	10201122	Hex bolt M8*35	4
50-27	10209033	Flat washer Φ8	4
50-28	10209004	Rubber ring 8*20*3	4
50-29	10217002	Hex nut M8	4
50-30	10440009	Straight fitting 3/8SAEO/R(M)*1/4NPT(M)	2
50-31	1052K027	90 0 fitting 1/4NPT(M)*1/4NPT(F)	2
50-32	1061K107	T fitting 1/4NPT(F)*1/4NPT(F)*1/4NPT(F)	2
50-33	10680072	90 0 fitting 1/4NPT(M)*1/4NPT(M)	2
50-34	1003105005	Two-way valve KHB-1/4NPT (F)	2
50-35	10209062	T fitting 1/4NPT(M)*1/4JIC(M)*1/4JIC(M)	2
50-36	10209064	Straight fitting 1/4NPT(M)*1/4JIC(M)	2

V. TEST RUN

A. Prepare for synchronization adjustment

1. Fill the reservoir with hydraulic oil. In consideration of hydraulic power unit's durability and keep the equipment running in the perfect condition, **please use Hydraulic Oil 46#**.
2. Turn on the power after connecting oil system correctly. Push the **UP** button, and check the rotated direction of the Motor. Shut off power and exchange the phase connection if the direction is wrong. (only for three phase motor)

B. Synchronous adjustment

1. Lower both platforms to the lowest position.
2. Turn the two-way valves to oil filling position (see Fig.30)
 - a. Push the button **UP** to fill the cylinders. Release the button when the platforms starts to rise.
 - b. Push button **DOWN** and **PASS** at the same time for 5 seconds to bleed the air, with buzzer sound and bleeding sound from oil tank.
 - c. Repeat a and b step 2-3 times until no air in the hydraulic system.
 - d. The lift is in the lowest state, quickly click button **UP** until the platforms just start to rise.
3. Turn the two-way valves to the normal working position (see Fig.31), press button **UP** to rise the lift. Check if both platforms are at the same height, if not, lower the lift to the lowest position and repeat step 2, till the platforms can rise synchronously.



Oil Filling Position

Fig. 30

Vertical down



Normal Working Position

Fig.31

Horizontal

4. After the platform P1 and P2 are confirmed synchronous, test run a full cycle without loading.
 5. Once the lift cannot be lowered from the highest position while press **DOWN** during the test run, turn the two-way valves quickly to oil filling position (Fig.30) and then quickly to normal working position (Fig.31) .
- Note: This operation should be finished quickly, non-stop.

VI. OPERATION INSTRUCTIONS

To lift vehicle

1. Keep clear of site near the lift, and lower the lift to the lowest position;
2. Drive vehicle to the platform and apply the brake;
3. Turn on the power and push the button **UP**, raise the lift to the working position;

Note: make sure the vehicle is steady when the lift is raising.

4. Ensure the platforms are at the same level before working then turn off the power switch

To lower vehicle

1. Clean the obstacles around or under the lift, and make sure no people around under the lift.
2. Turn on the power switch, push the down button **Down** to lower the lift, the lift is lowered continually and stopped at the height 300mm from ground. Keep feet clear off lift, push button **DOWN** while push the **Lowering Alarm Button(PASS)** at the side of control cabinet, the lift will be lowered to ground with alarm tone;
3. Drive away the vehicle when the lift is lowered to the lowest position.
4. Turn off the power, clean the lift's appearance, clean the work site.

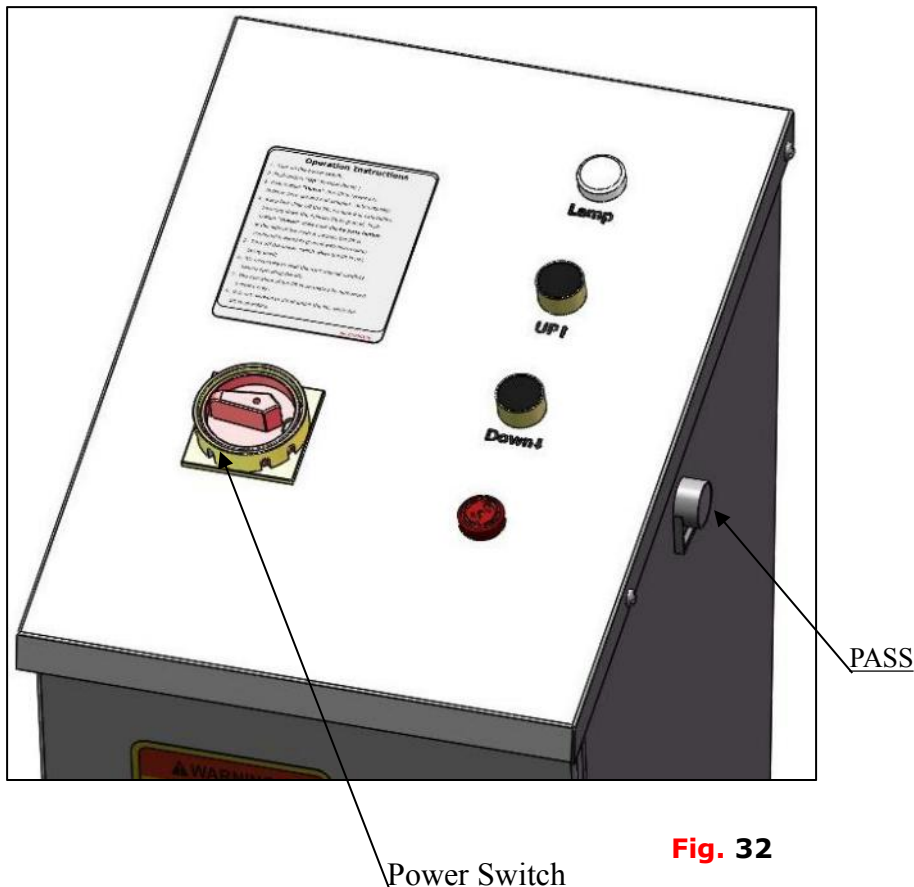

Fig. 32

VII. MAINTENANCE SCHEDULE

Monthly:

1. Re-torque the anchor bolts to 150Nm.
2. Check all fittings, bolts and pins to insure proper mounting.
3. Make a visual inspection of all hydraulic hoses for possible wear or leakage.
4. Adjusting the lifting level on both platforms.

Every six months:

1. Make a visual inspection of all moving parts for possible wear, interference or damage.
2. Check and adjust the platform as necessary to insure level lifting.
3. Check all fastener and re-torque.

Oil cylinder maintenance:

In order to extend the service life of the oil cylinder, please operate according to the following requirements.

1. Recommend to use N46 anti-wear hydraulic oil.
2. The hydraulic oil of the lifts should be replaced regularly during using. Replace the hydraulic oil 3 months after the first installation, Replace the hydraulic oil once a year afterwards.
3. Make at least one full trip raising and lowering per day. For exhausting the air from the system, which could effectively avoid the corrosion of the cylinder and damage to the seals caused by presence of air or water in the system.
4. Protect the outer surface of the oil cylinder's piston rod from bumping and scratching, and timely clean up the debris on the oil cylinder dust-ring and the piston rod.

VIII. TROUBLE SHOOTING

TROUBLE	CAUSE	REMEDY
Motor does not run	<ol style="list-style-type: none"> 1. Button does not work 2. Wiring connections are not in good condition or disconnection 3. AC contactor in damage 4. Motor burned out 	<ol style="list-style-type: none"> 1. Replace button 2. Repair all wiring connection 3. Repair or Replace AC contactor 4. Repair or replace motor
Motor have voice but does not run	<ol style="list-style-type: none"> 1. AC contactor does not contact well 	<ol style="list-style-type: none"> 1. Replace AC contactor
Motor runs but the lift is not raised	<ol style="list-style-type: none"> 1. Motor runs in reverse rotation 2. Low oil level 3. The Gear Pump out of operation 4. Relief valve or check valve in damage 5. Shaft Coupling in damage 	<ol style="list-style-type: none"> 1. Reverse two power wire 2. Fill tank 3. Repair or replace 4. Repair or replace 5. Replace Shaft Coupling
Lift raised slowly	<ol style="list-style-type: none"> 1. Oil line is jammed 2. Gear Pump leaks 3. Overload lifting 4. Power Voltage low 5. Oil mixed with air 	<ol style="list-style-type: none"> 1. Clean the oil line 2. Replace Pump 3. Check load 4. Check electrical system 5. Fill tank and bleeding air
Lift cannot lower	Hydraulic Solenoid valve out of operation	Repair or replace

IX. CAR LIFT SAFETY TIPS

Put this safety tips in a place where you can always alert the operator. Please reference to the lift manufacturer's manual for specific information about the lift.

1. Check the lift daily. If the machine breaks down or has damaged parts, do not operate, and use original equipment parts to repair.
2. **Do not** overload . The rated weight of the manufacturer design is indicated on the label of the lift.
3. Position control of the vehicle and operation of the lift can only be done by a trained and authorized person.
4. **Do not** lift a car with occupants inside. Keep the customers or bystanders away from the lift.
5. Keep the area around the lift free of obstacles, lubricating oil, grease, garbage and other debris for a long time.
6. Carefully drive the vehicle onto the lift and lifting up to the required height for operation. **Noted:** lift it high enough if you are working underneath, and make sure the safety devices are locked.
7. **Noted:** removing(install) parts from(to) a vehicle would cause a sudden shift of gravity which may result in instability of the vehicle. Please refer to the vehicle manufacturer's service manual as a recommended procedure if you need remove/install parts from(to) the vehicle
8. Before lowering the lift , make sure all obstacles underneath, include tool tray, tool rack etc., are all removed.

X. LIFT DISPOSAL

When the car lift cannot meet the requirements for normal use and needs to be disposed, it should follow local laws and regulations.

**Address:**

SC Division: 1931 Joe Rogers Jr Blvd, Manning, SC 29102, USA

TX Division: 4310 Adler Dr., Suite #200, Dallas, TX 75211, USA

<http://www.amgohyd.com>

Manual No.: **72216213**

Revision Date: **2025/10**