

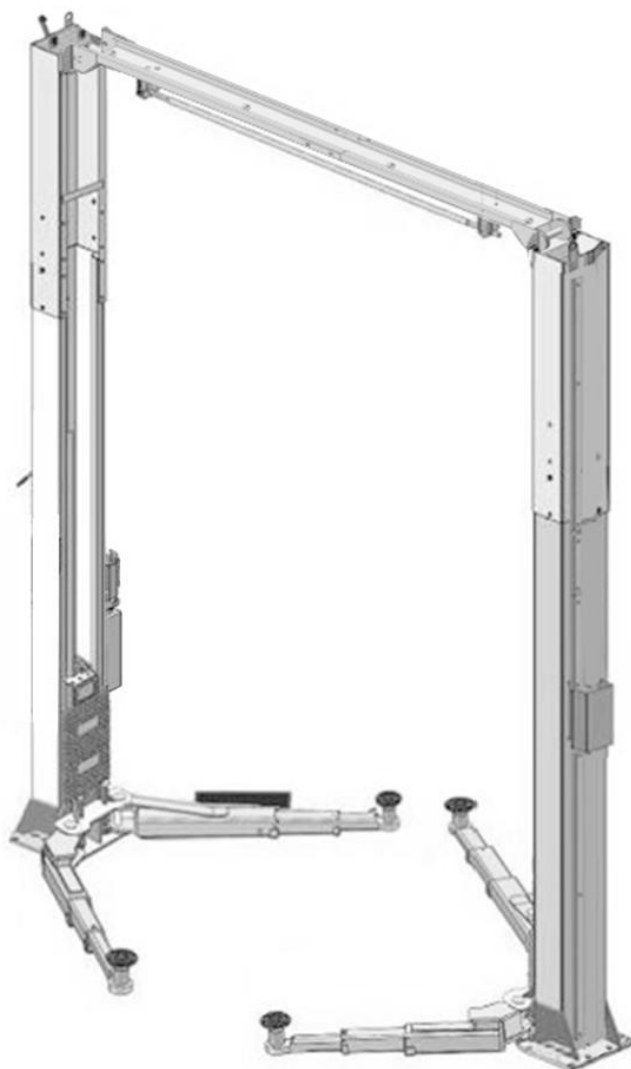

Installation And Service Manual

Original



TWO POST LIFT

Model: OH-9/OH-9H, OH-10/OH-10H

CONTENTS

Product Features and Specifications	1
Installation Requirement	4
Steps of Installation	6
Exploded View	26
Test Run	34
Operation Instruction	35
Maintenance	36
Trouble Shooting	37
LIFT DISPOSAL	37

I. PRODUCT FEATURES AND SPECIFICATIONS

CLEAR-FLOOR DIRECT-DRIVEN MODEL FEATURES

Model OH-9(H), OH-10(H) (See Fig. 1)

- Direct-driven design, minimize the lift spare parts and breakdown ratio
- Dual hydraulic cylinders, designed and made as standards, utilizing oil seal in cylinder
- Self- lubricating UHMW Polyethylene sliders and bronze bush
- Single-point safety release, and dual safety design
- Clear-floor design, provide unobstructed floor use
- Overhead safety shut-off device prevents vehicle damage
- Super-asymmetric arms design can fit extremely wide vehicles, stackable rubber pads
- Standard adjustable heights accommodate varying ceiling heights

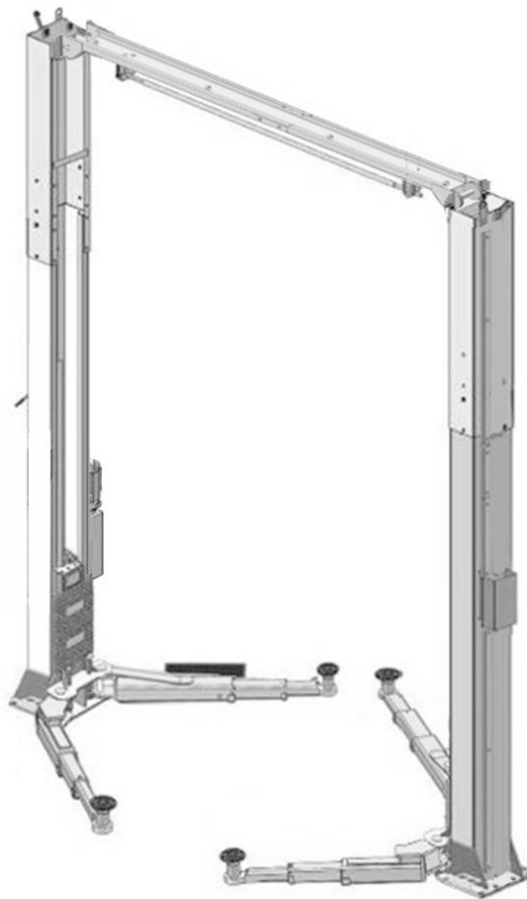

Fig. 1

OH-9, OH-9H, OH-10, OH-10H SPECIFICATIONS

Model	Style	Lifting Capacity	Lifting Time	Lifting Height	Overall Height	Overall Width	Width Between Columns	Minimum Pad Height	Motor
OH-9	Clear-floor Direct-driven	9,000 lbs	56S	71 1/2"-84 1/2"	142-1/2"/150-1/2"	135"	112 1/4"	3 1/2"-12 1/2"	2.0 HP
OH-9H					166-5/8"/174-1/2"				
OH-10		10,000 lbs	56S		142-1/2"/150-1/2"				
OH-10H					166-5/8"/174-1/2"				

**Arm Swings View
For Model OH-9(H) OH-10(H)**

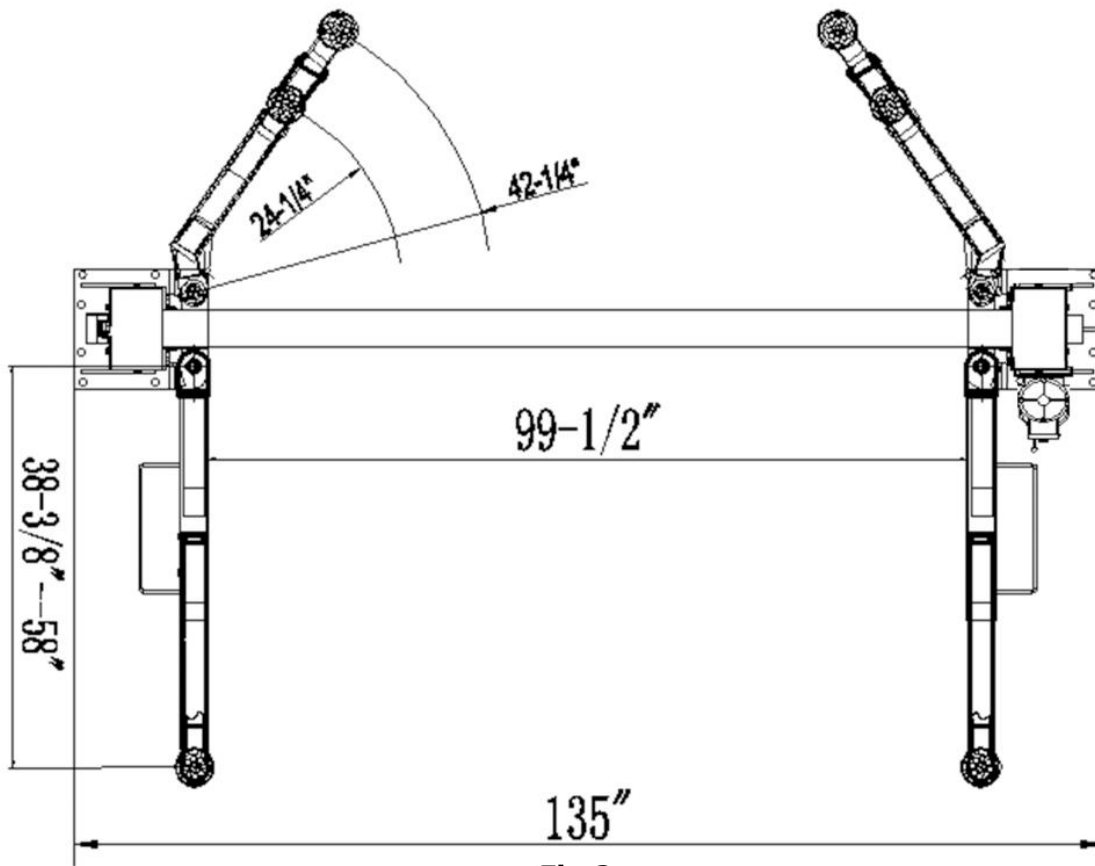

Fig.2

Attention! Please make sure to place the arms in correct position before car drive in!

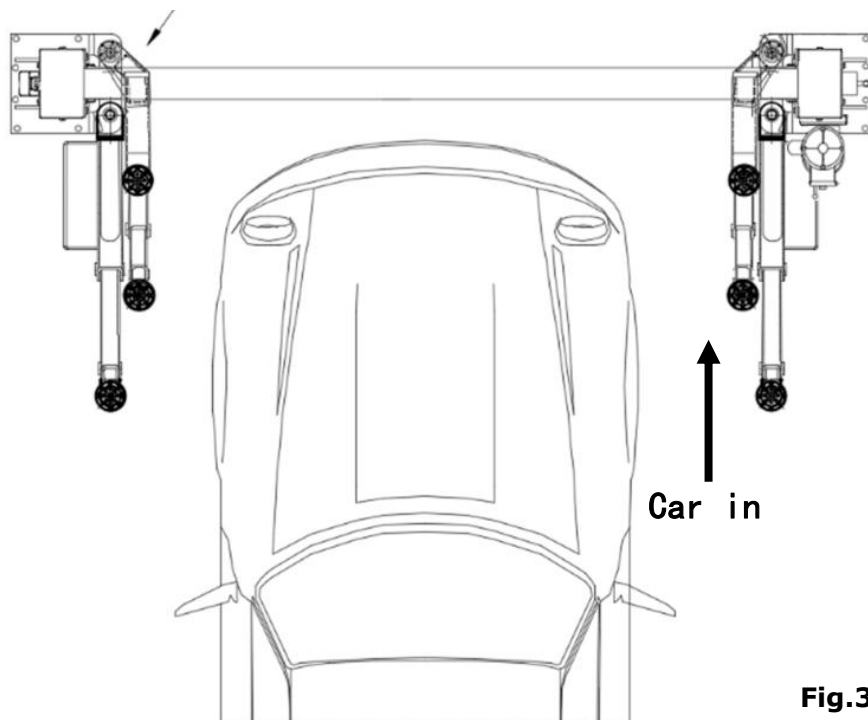

Fig.3

Swing and **extending** the arms to the lifting point of vehicle

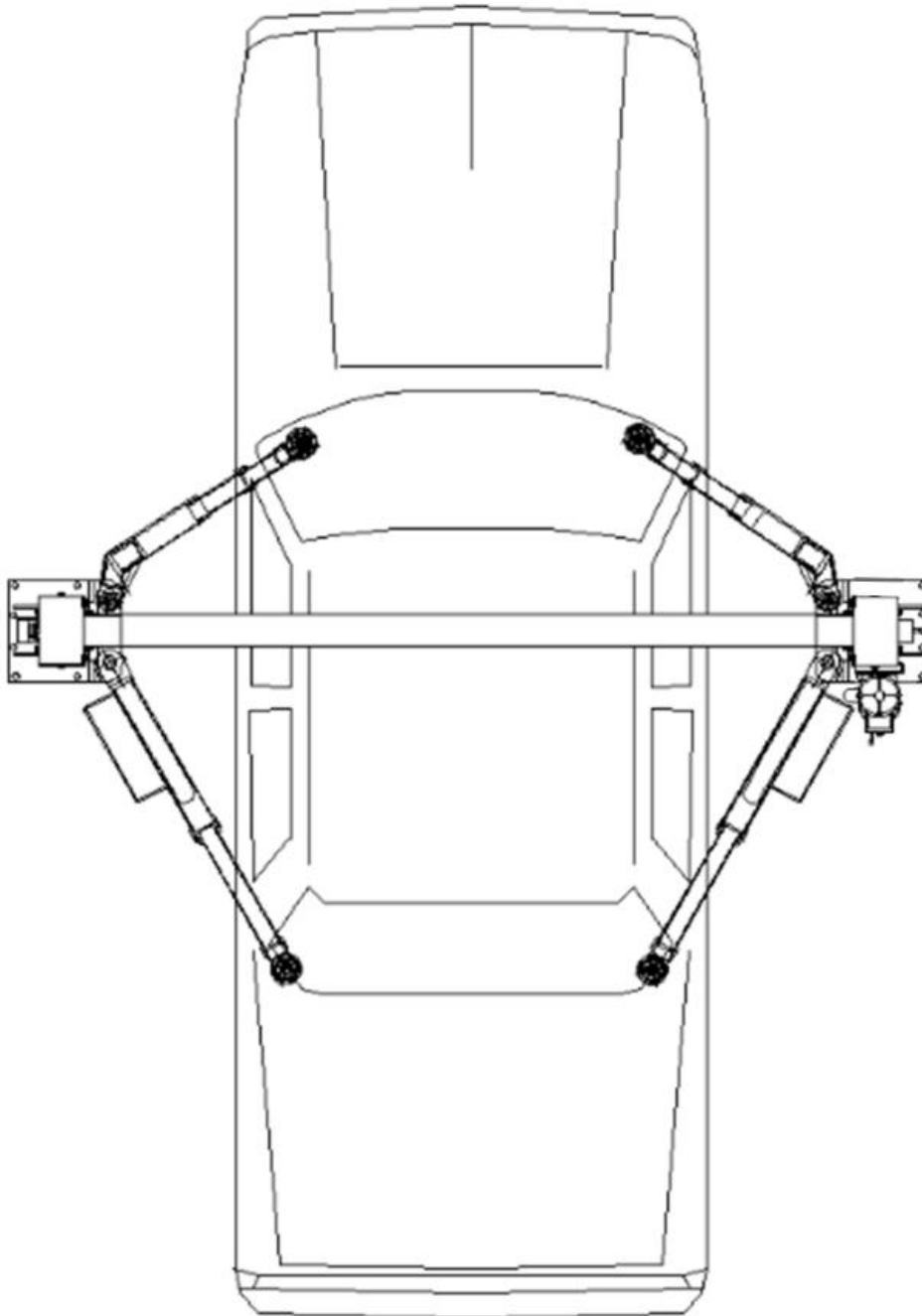

Fig.4

II. INSTALLATION REQUIREMENT

A. TOOLS REQUIRED

- ✓ Rotary Hammer Drill ($\Phi 19$)



- ✓ Hammer



- ✓ Level Bar



- ✓ English Spanner (12")



- ✓ Ratchet Spanner with Socket (28#)



- ✓ Wrench set

(8#, 10#, 13#, 14#, 17#, 19#, 24#)



- ✓ Carpenter's **ink marker**



- ✓ Screw Sets



- ✓ Tape Measure (7.5m)



- ✓ Pliers



- ✓ Socket Head Wrench (3#, 5#, 8#)



- ✓ Lock Wrench



Fig.5

B. Equipment storage and installation requirements.

The equipment should be stored or installed in a shady, normal temperature, ventilated and dry place.

C. The equipment should be unload and transfer by forklift.



Fig.6

D. SPECIFICATIONS OF CONCRETE (See Fig. 7)

Specifications of concrete must be adhered to the specification as following.

Failure to do so may result in lift and/or vehicle falling.

1. Concrete must be thickness 4" minimum and without reinforcing steel bars, and must be dried completely before the installation.
2. Concrete must be in good condition and must be of test strength 3,000psi minimum.
3. Floors must be level and no cracks.

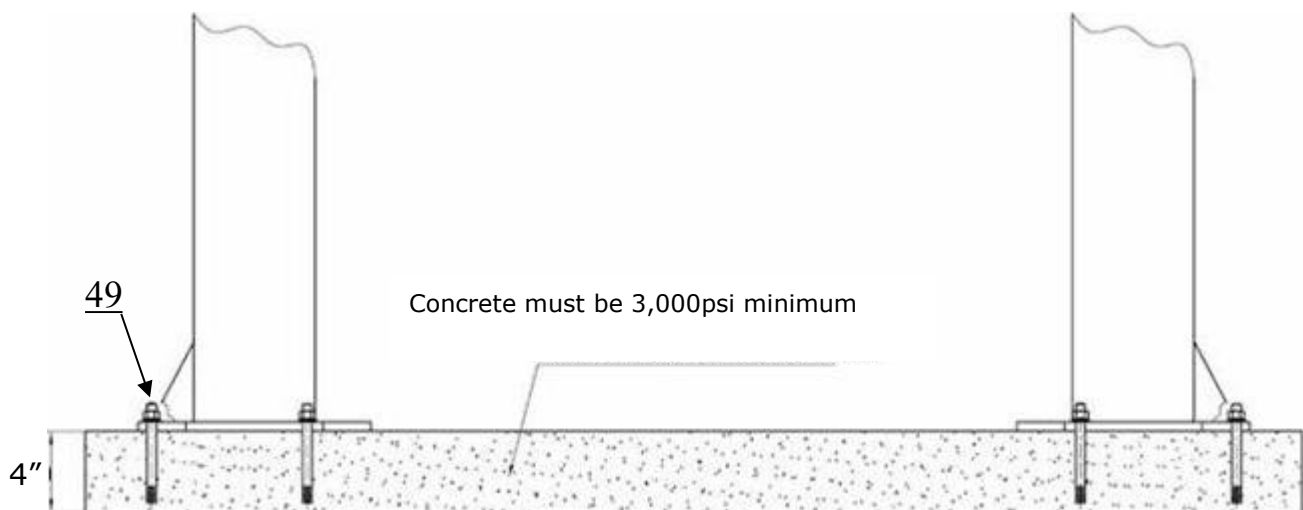

Fig. 7

E. POWER SUPPLY

The electrical source must be 2.0HP minimum. The source cable size must be 2.5mm² and in good condition of contacting with floor.

III. STEPS OF INSTALLATION

A. Location of Installation

Check and insure the installation location (concrete, layout, space size etc.) is suitable for lift installation.

B. Use a carpenter's **ink marker** line to establish installation layout of base-plate (**See Fig.8**).

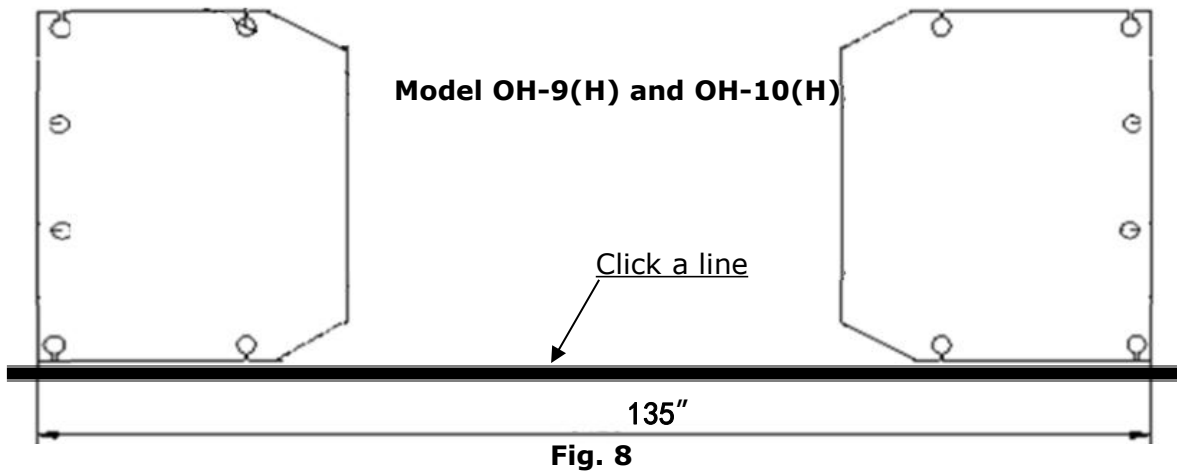

C. Check the parts before assembly.

1. Packaged lift and power unit (**See Fig. 9**).



2. Move aside the lift with fork lift or hoist, and open the extension packing carefully, take off the lifting arms and parts box from upper and inside the column, then move them to location nearby installation site, check the parts according to the shipment parts list (**See Fig.10**).

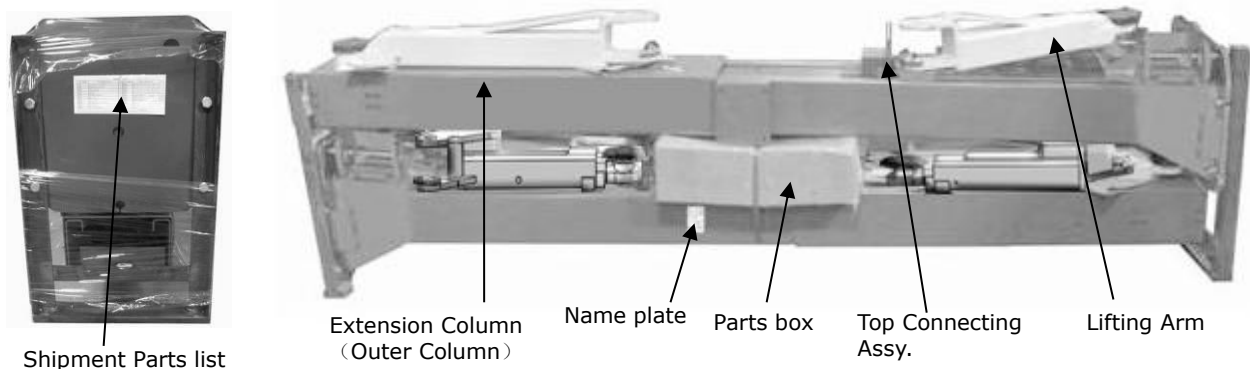

Fig.10

3. Loose the screws of the upper package stand, take off the upper extension columns, take out the parts in the inner column and remove the package stand.
4. Move aside the parts and check the parts according to the shipment parts list.
(See Fig.11, 12).

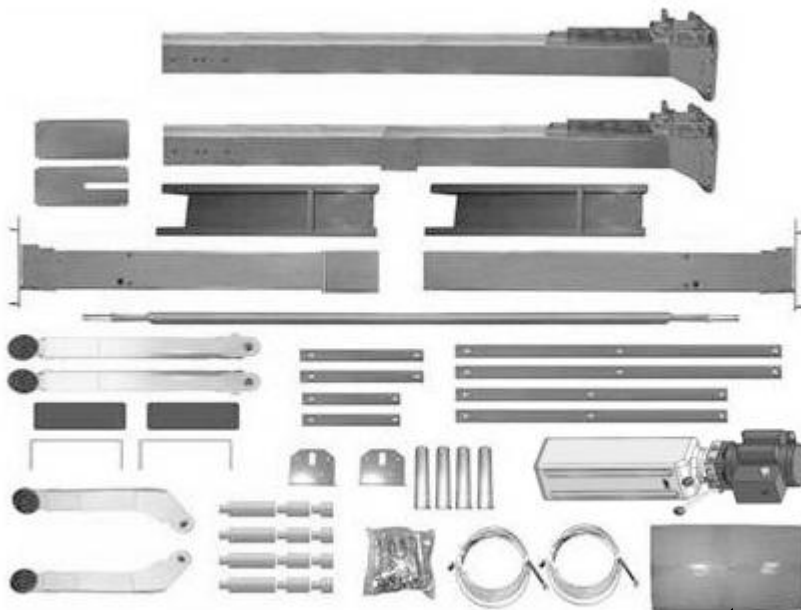

Fig. 11
Parts in the shipment parts list



Fig. 12
Parts in the parts box (50)

5. Open the bag 1 of parts and check the parts according to parts box list (See Fig. 13).



Fig. 13

6. Open the bag 2 of parts and check the parts according to parts bag list (See Fig. 14).

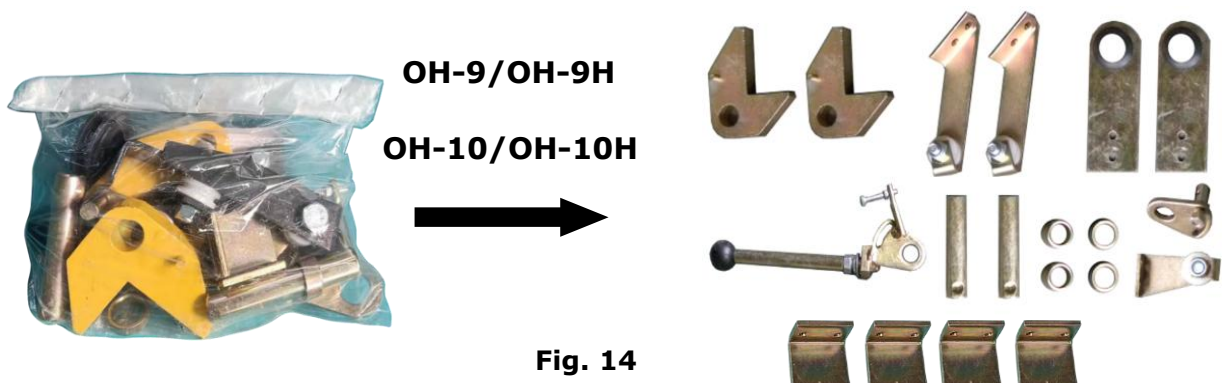

Fig. 14

D. Install parts of extension columns (See Fig. 15).

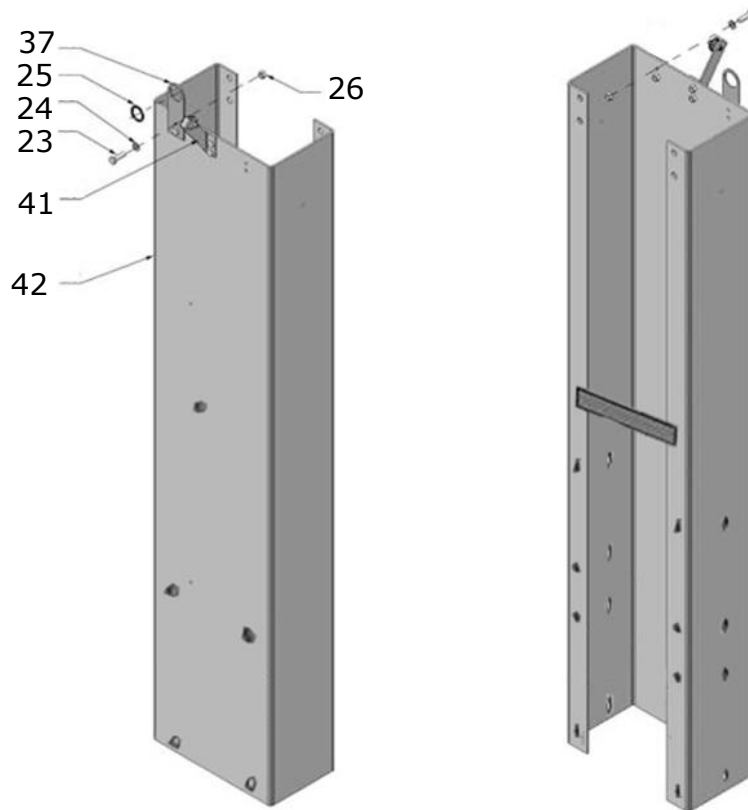

Fig. 15

E. Position power-side column

Lay down two columns on the installation site parallelly, position the power-side column according to the actual installation site. Usually, it is suggested to install power-side column on the front-right side of the direction which vehicles are driven to the lift. This lift is designed with 2-Section columns. Adjust the height according to the ceiling height and connect the inner and extension columns.

OH-9, OH-10: Not suitable for installation when the height of the workshop is less than 143-3/4"; only low setting installation for height between 143-3/4" - 151-1/2 "; the height of the workshop is greater than 151-1/2", installation can be in both high and low setting;

OH-9H, OH-10H: Not suitable for installation when the workshop height is less than 167-3/8"; only low setting installation for height between 167-3/8" ~ 175-1/4"; the height of the workshop is greater than 175-1/4", installation can be in both high and low setting;

1. High setting installation, choose the low holes of the outer column and install with the inner column.

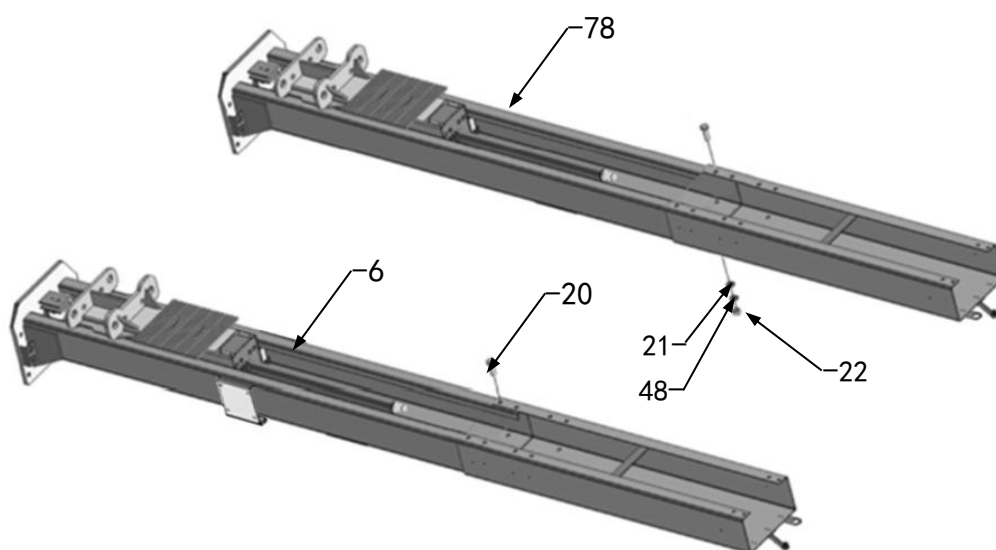

**High setting
Fig.16**

2. Low setting installation, choose the high position holes of the outer column and install with the inner column. (See Fig.17).

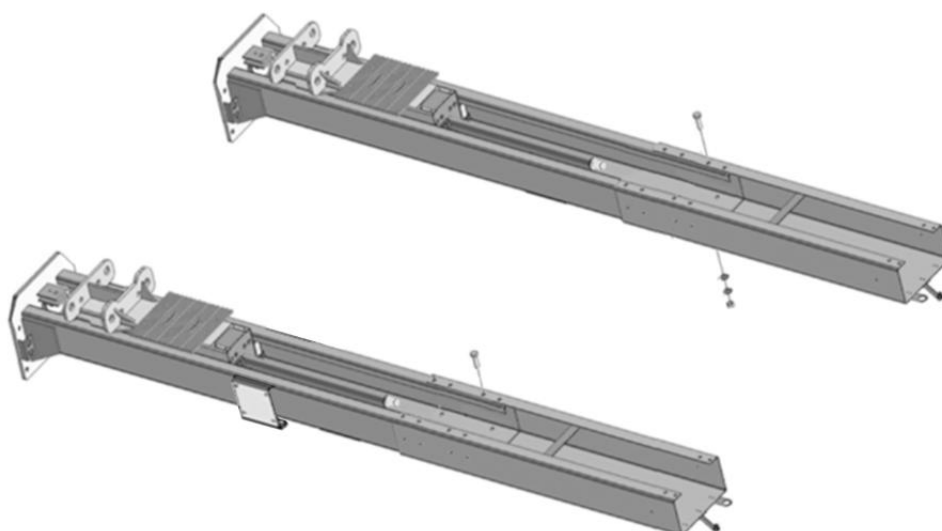

**Low setting
Fig.17**

F. Position columns (See Fig. 18)

Position the columns on the installation layout of base-plate, Install the anchor bolts. Check the Columns plumpness with level bar, and adjusting with the shims if the columns are not vertical. Do not tighten the Anchor Bolts.

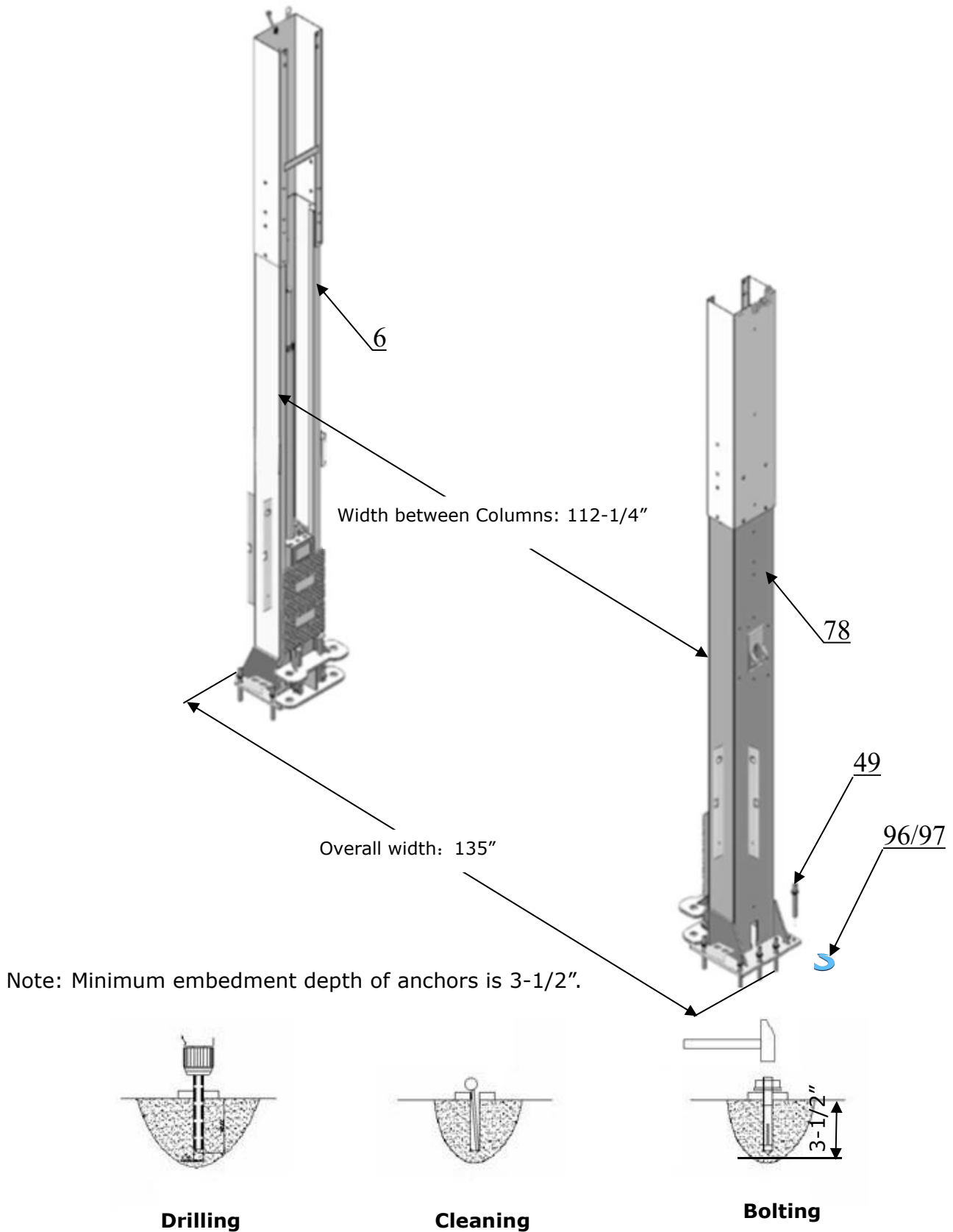

Fig. 18

G. Install overhead top beam

1. The hook on the top coupling assembly is hung on the outer column to lock the screws, and then the top beam is installed (**See Fig. 19**).



Fig. 19

2. Install the top beam, **fix** the anchor bolts.

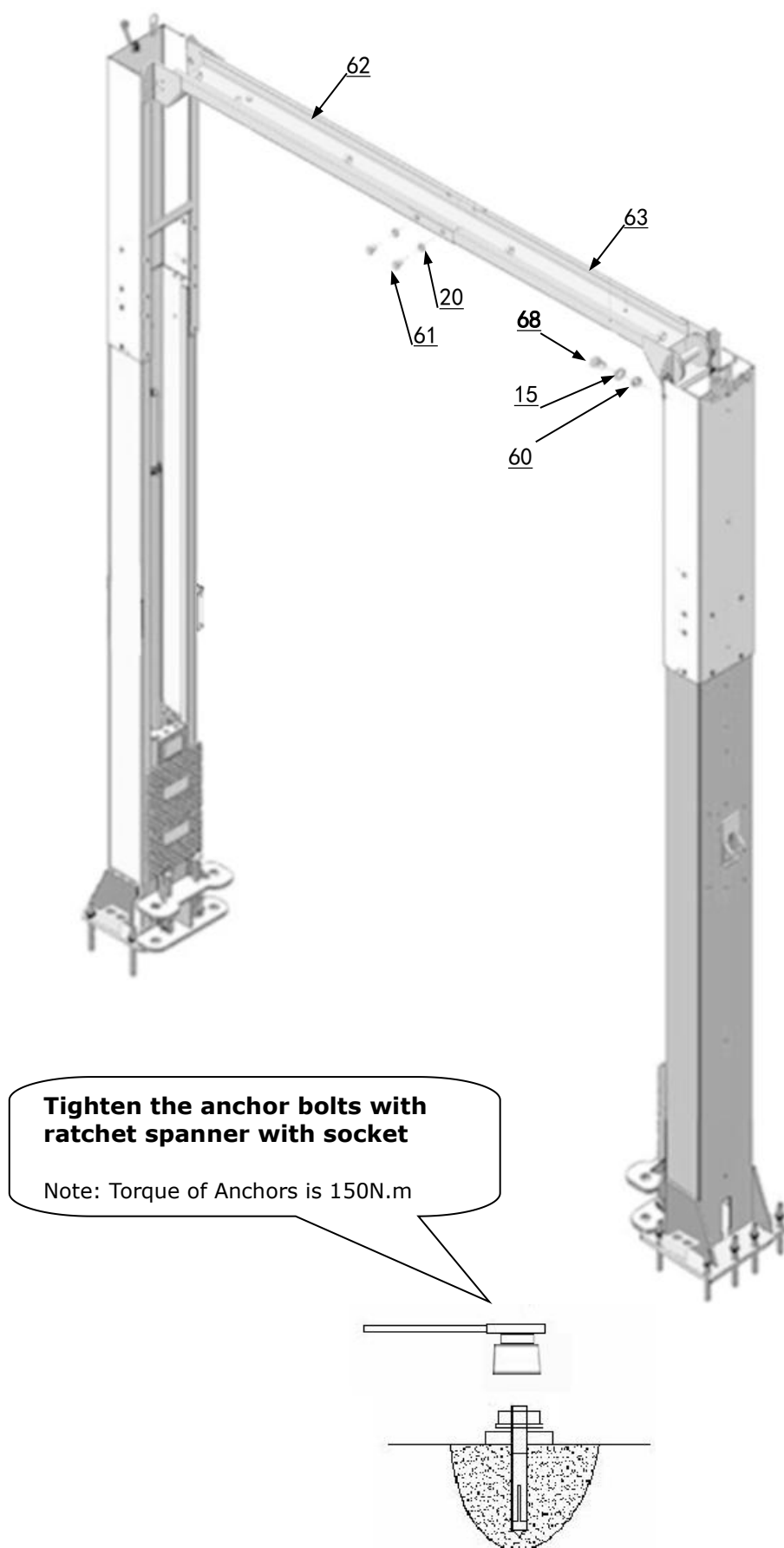

Fig. 20

H. Installing the limit switch control bar and limit switch (See Fig. 21).

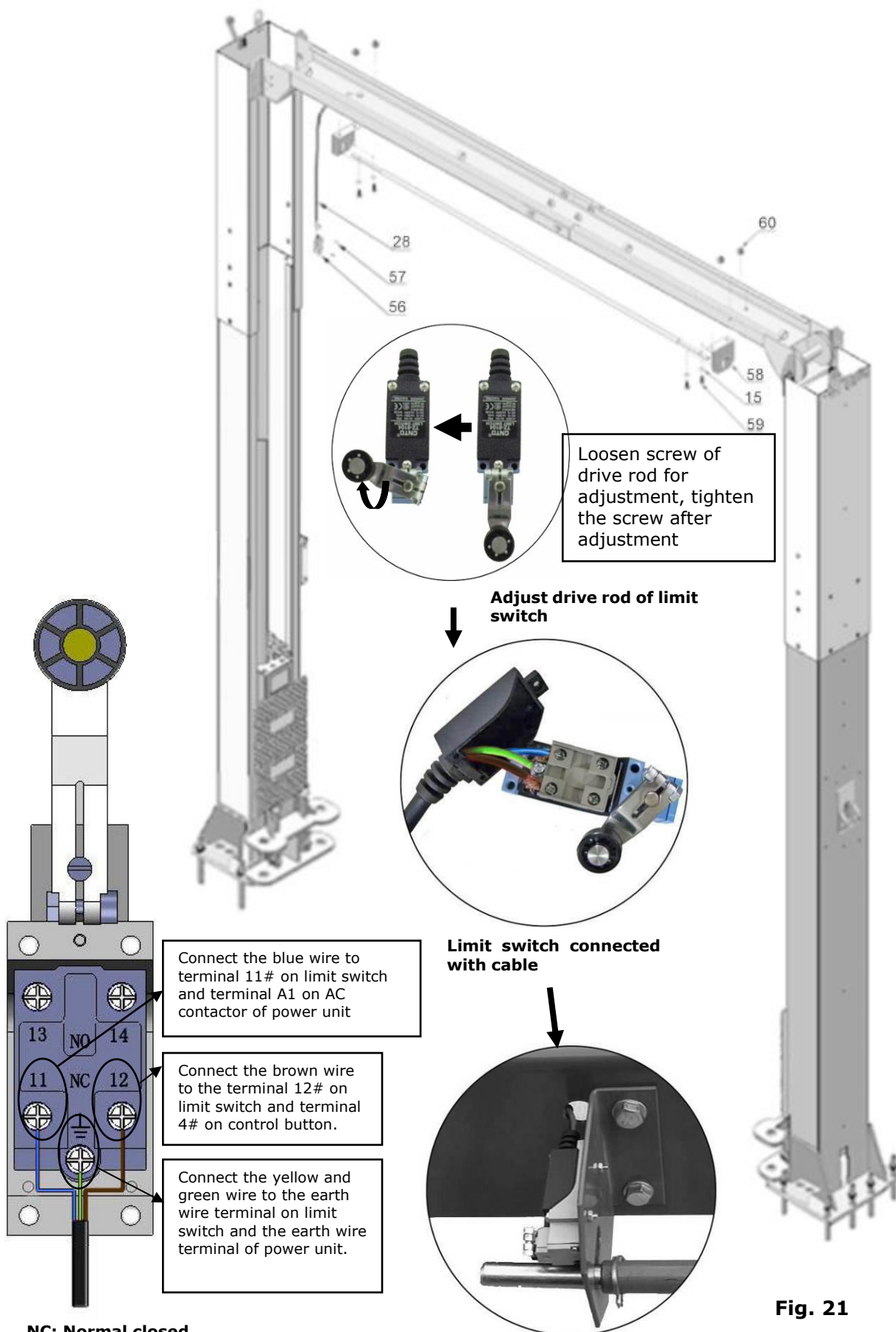
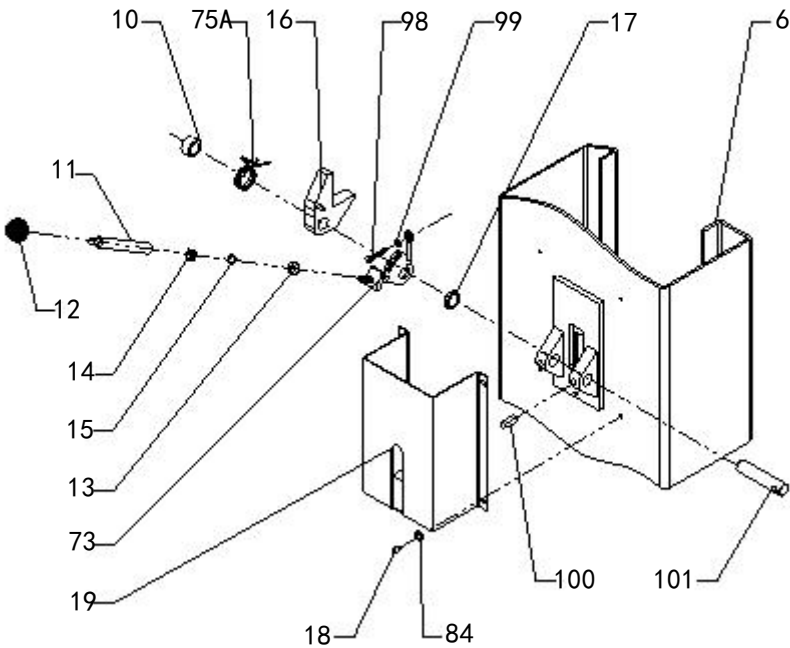
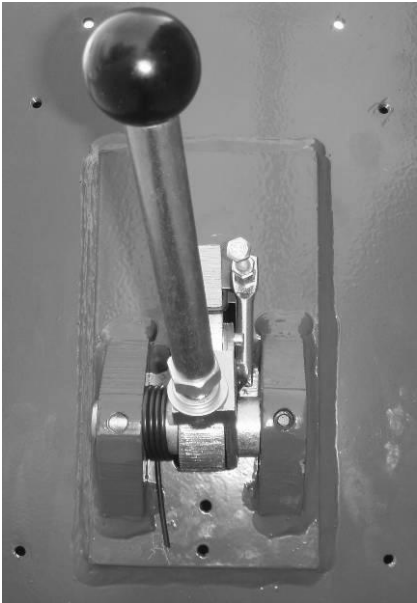
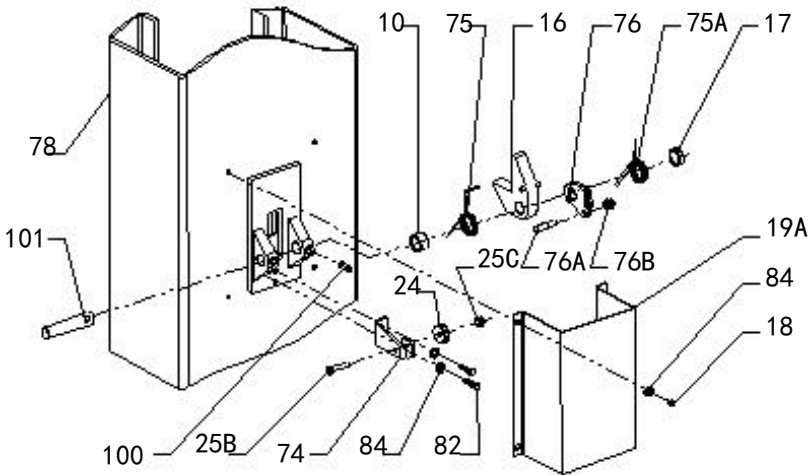
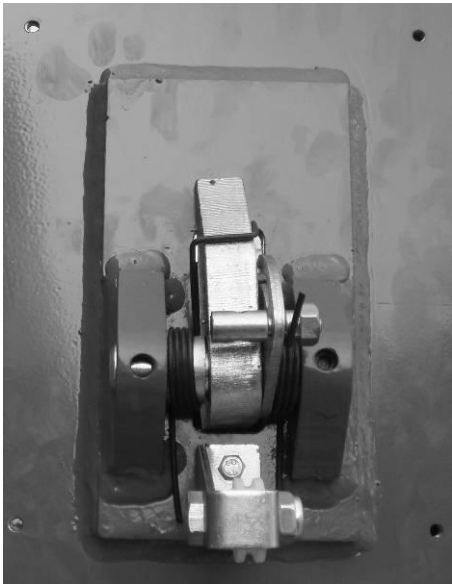

Fig. 21

I. Install safety device (See Fig. 22 & Fig. 23).



Power-side safety device
Fig.22



Off-side safety device
Fig.23

J. Lift the carriages up and make them be locked at the same level (**See Fig. 24**).

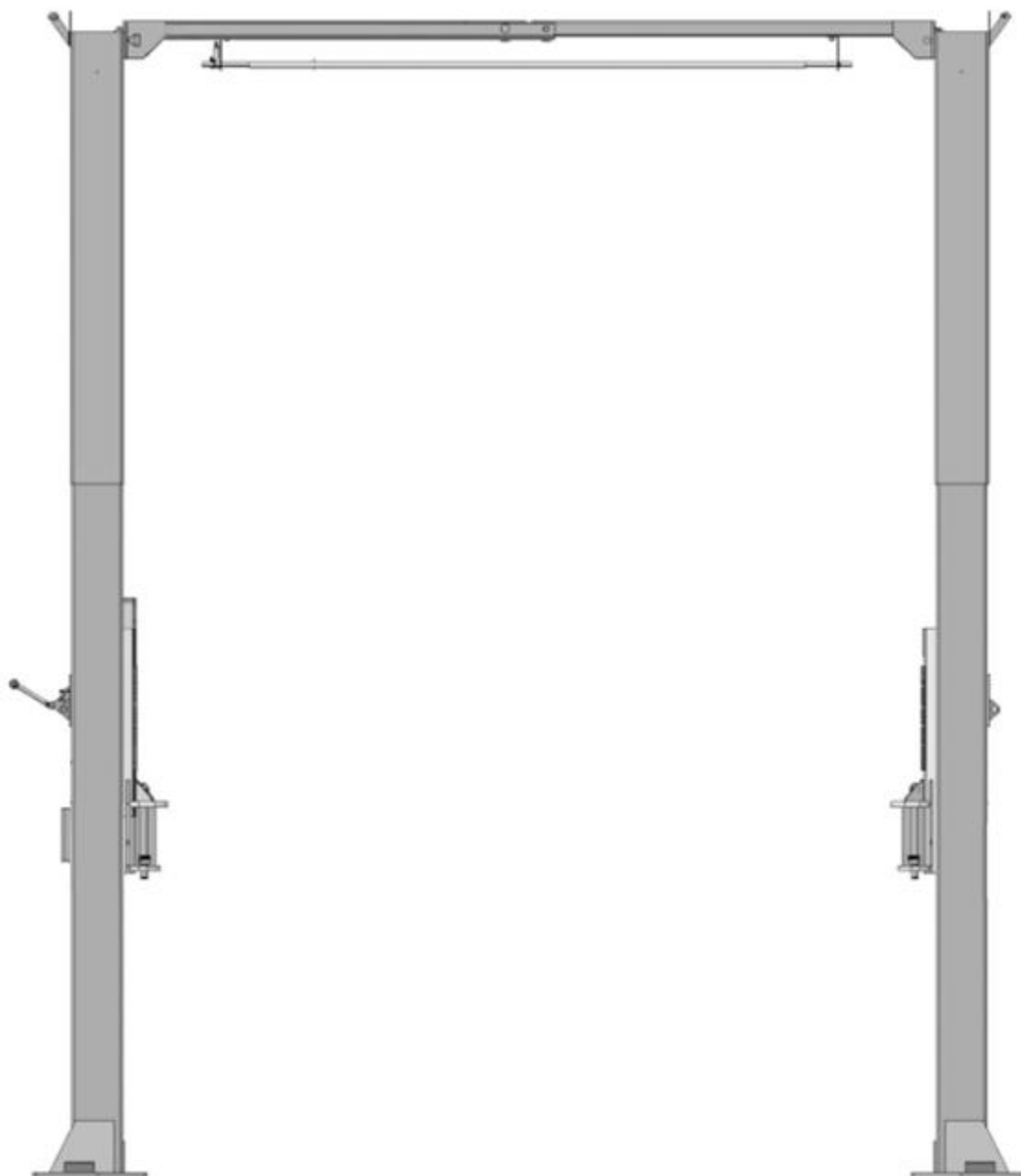

Fig. 24

K. Install cables

1. Low setting cable connection (See Fig. 25).

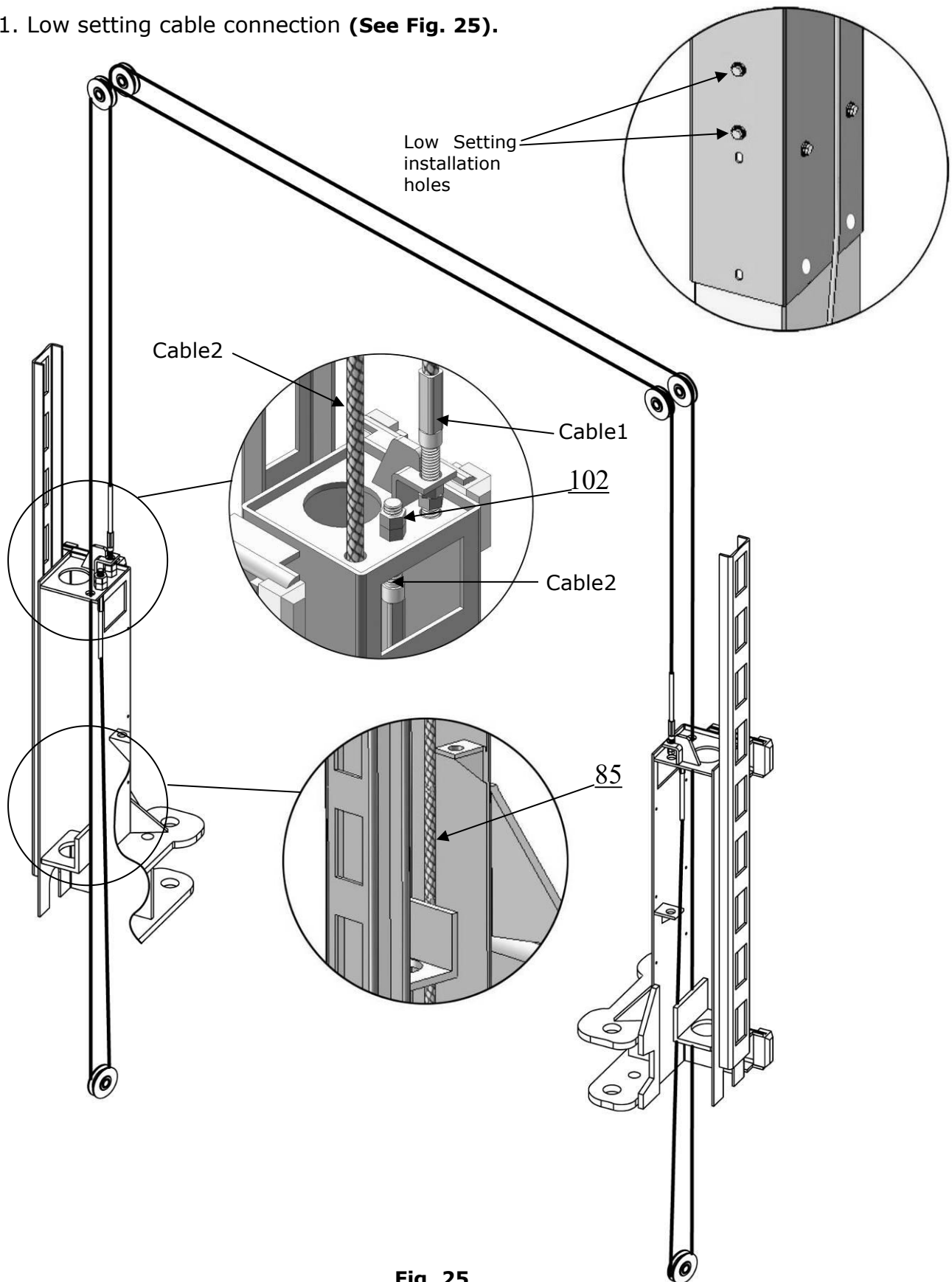

Fig. 25

2. High setting cable connection

2.1. Cable pass through from the bottom of the carriages and be pulled out from the open of carriages, then screw the two cable nuts (**See Fig. 26**).

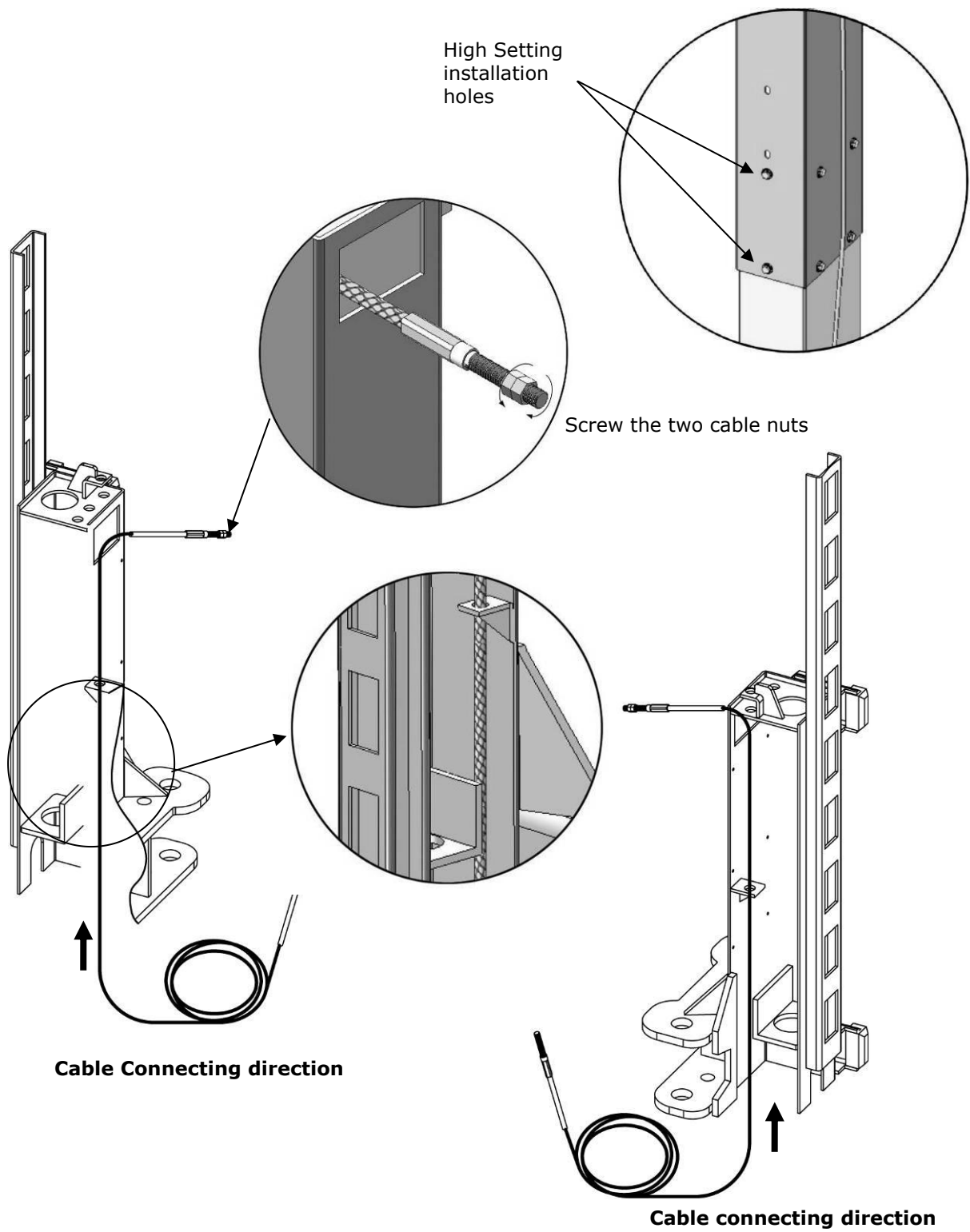

Fig. 26

2.2 Connecting cable for high setting (See Fig. 27).

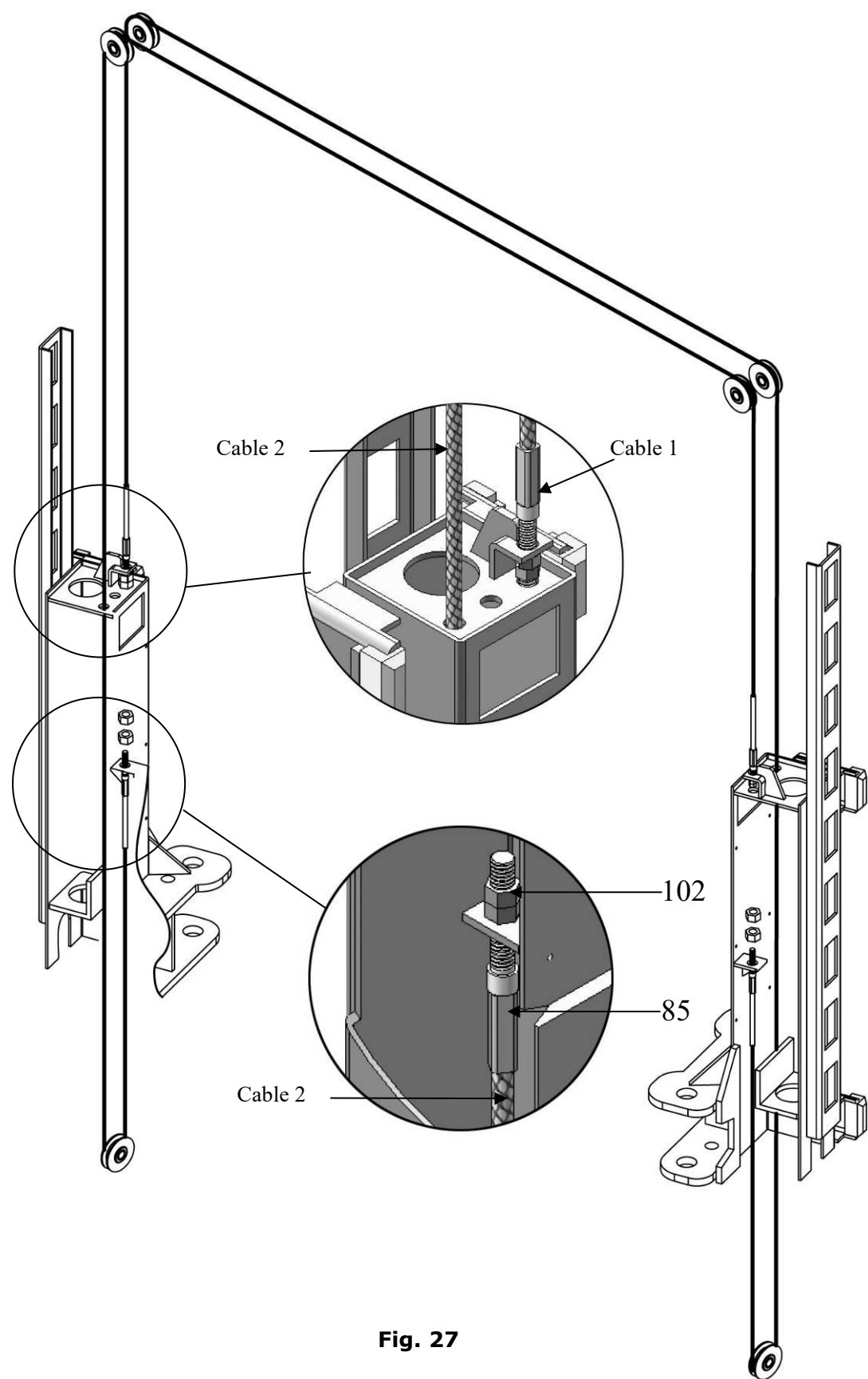

Fig. 27

L. Install oil hose.

1. Oil-line connecting drawing. (See Fig.28)

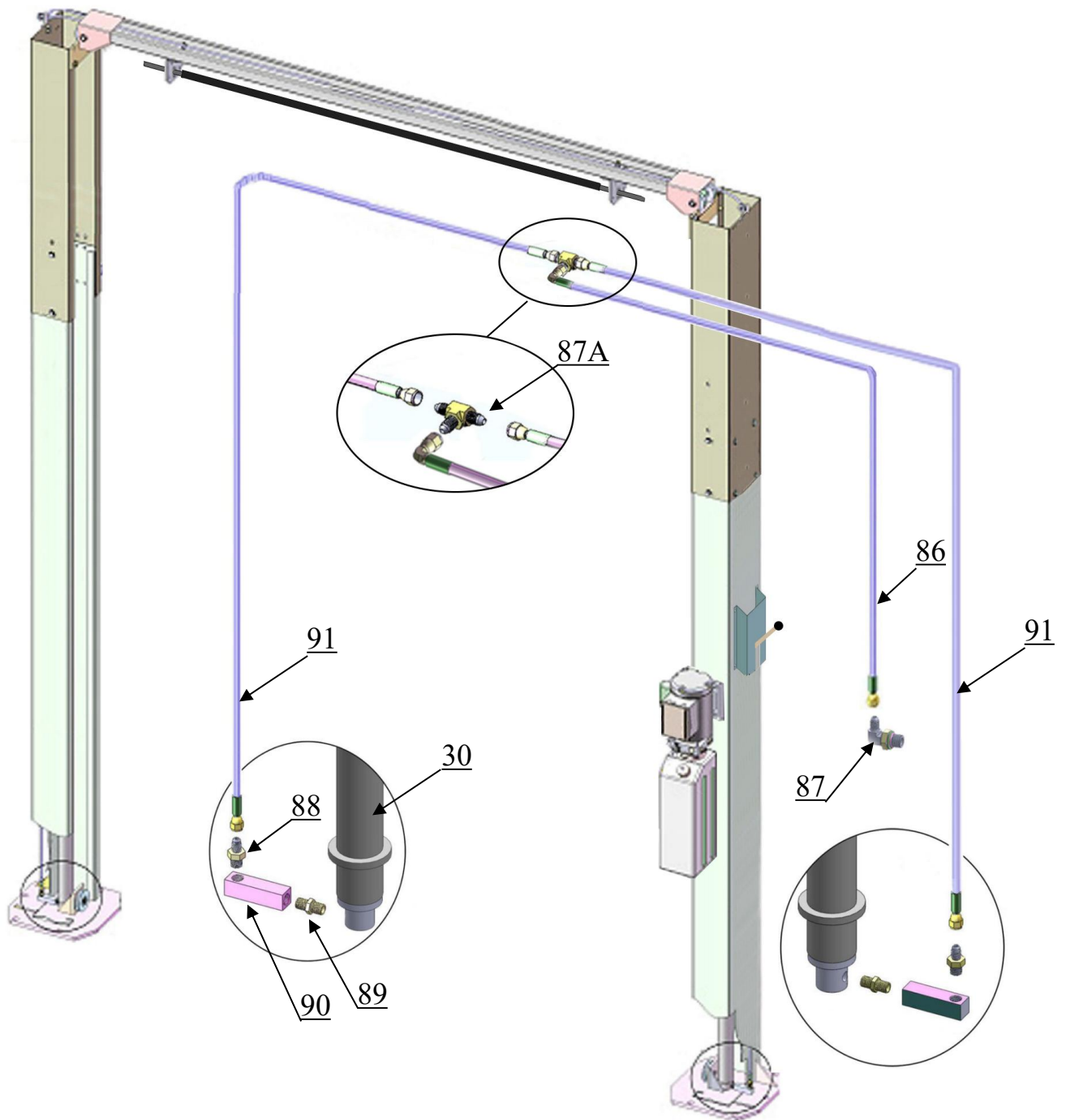

Fig.28

Following the above fig., first fix the cylinder hose with a wire holder, and then tie the power unit hose and the cylinder hose together with two cable ties

2. Follow these step to connect the oil hose of power unit.

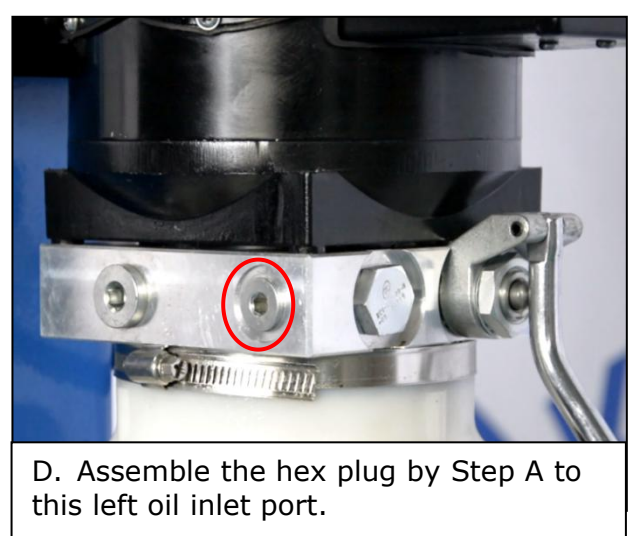
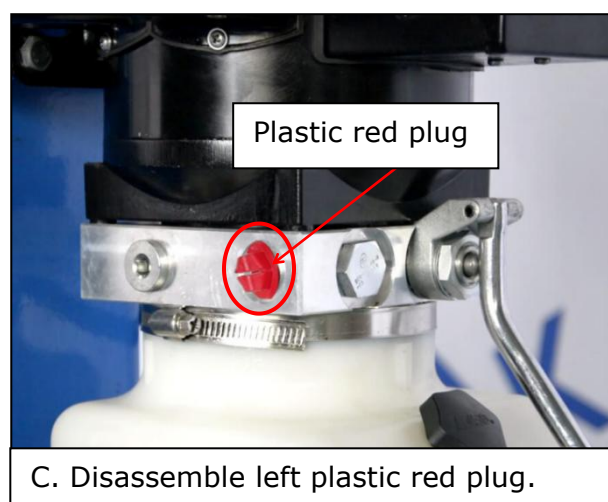
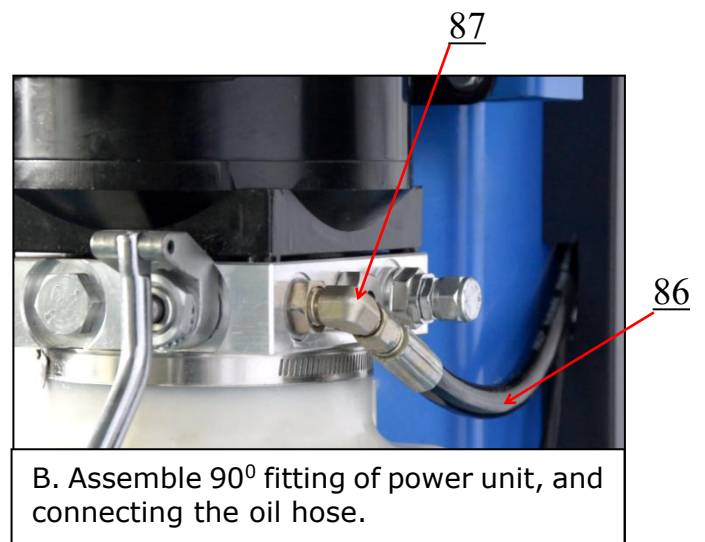
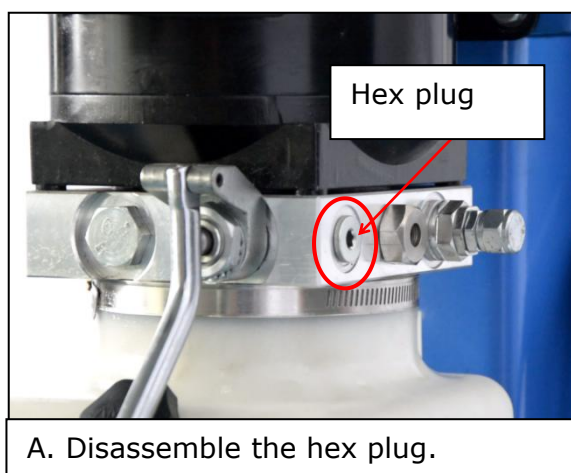
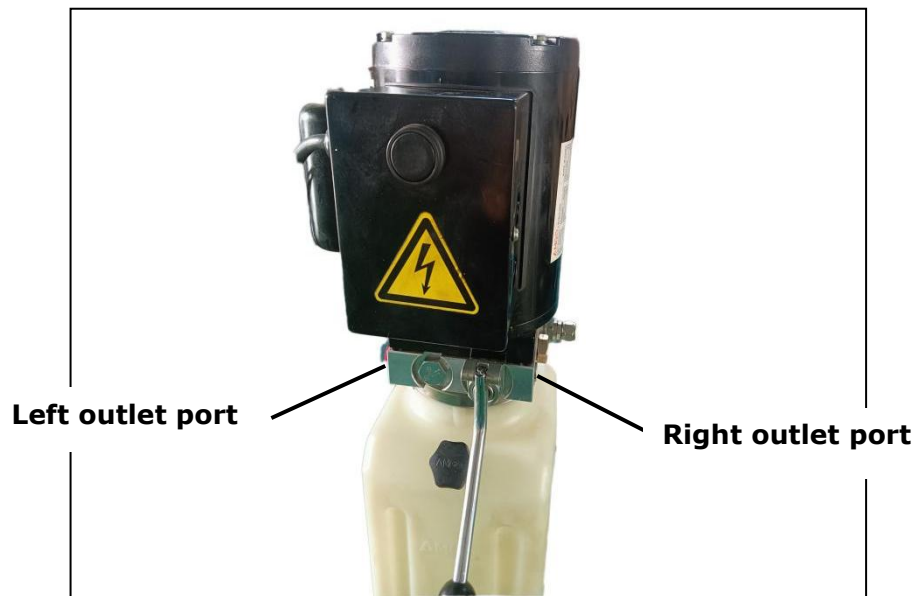

Fig.29

M. Install protective cover. (Fig.30)

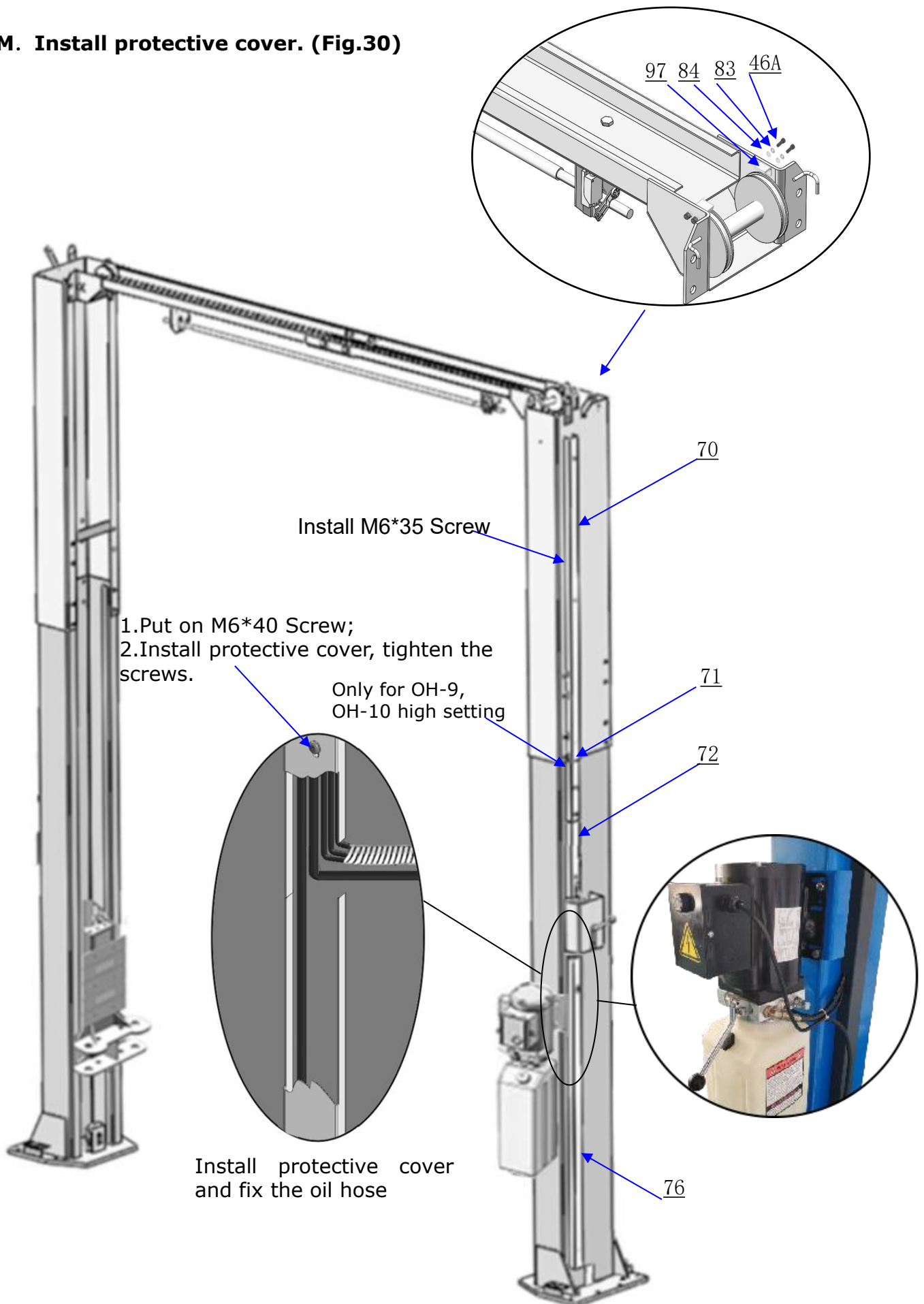
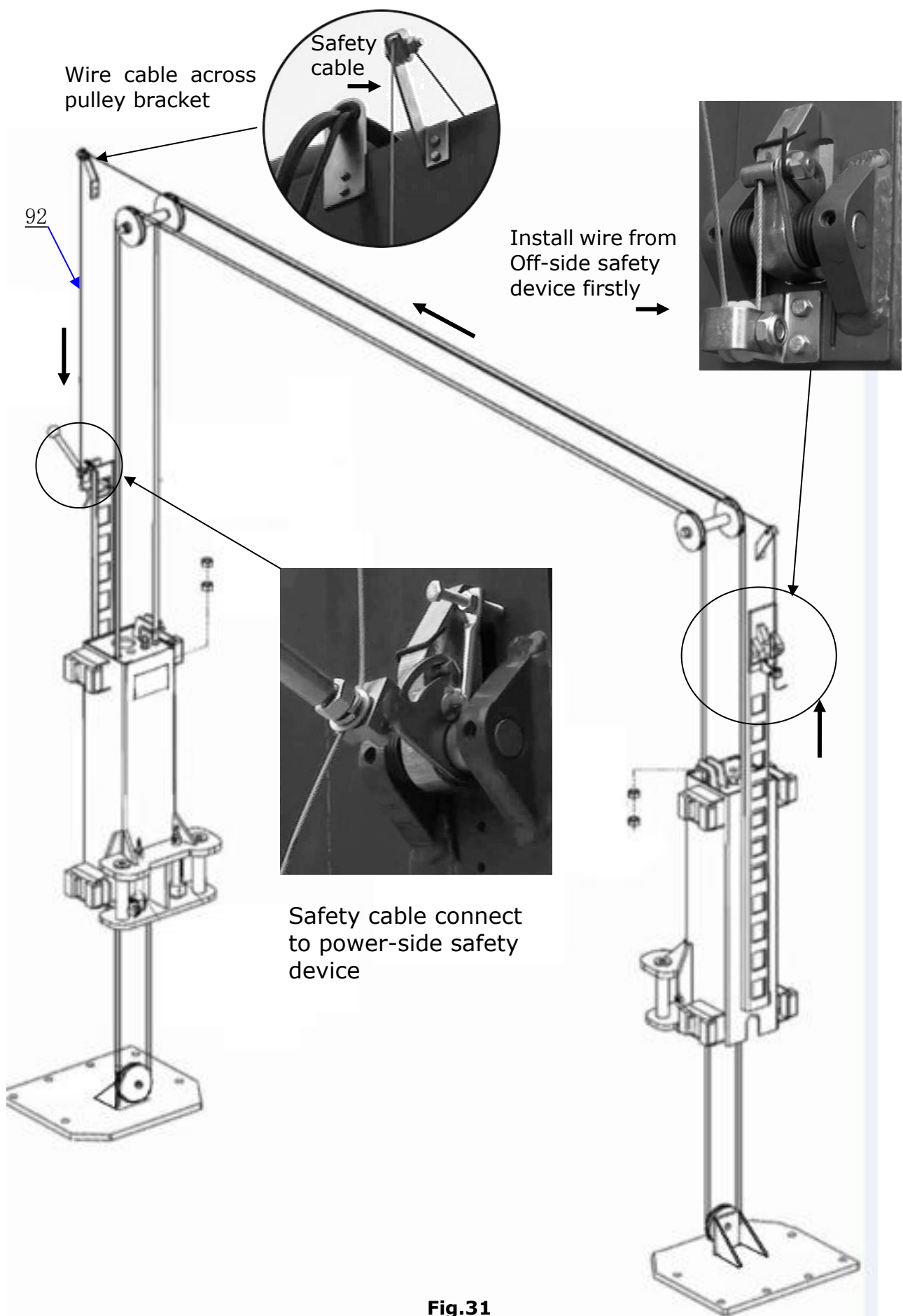

Fig.30

N. Install safety cable (See Fig. 31)



O. Install Protective Covers

Note: Requirement of installation for oil hose and safety device.

1. Install Oil Hose.

Note: Don't cross the oil hose and safety cable together (See Fig. 32 & Fig. 33).

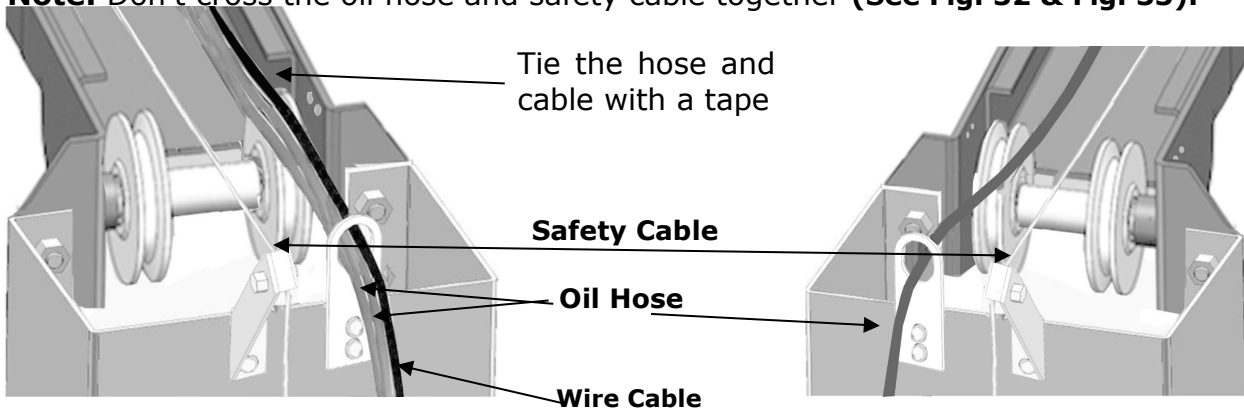

Power-side Safety Device
Fig. 32

Offside Safety Device
Fig. 33

2. Install safety cable, oil hose and protective cover (See Fig. 34 & Fig. 35 & Fig. 36).

Note: Install the protective cover on the extension column with M6*35 Cap head bolt, Install the protective cover on the inner column with M6*40 Cap head bolt.

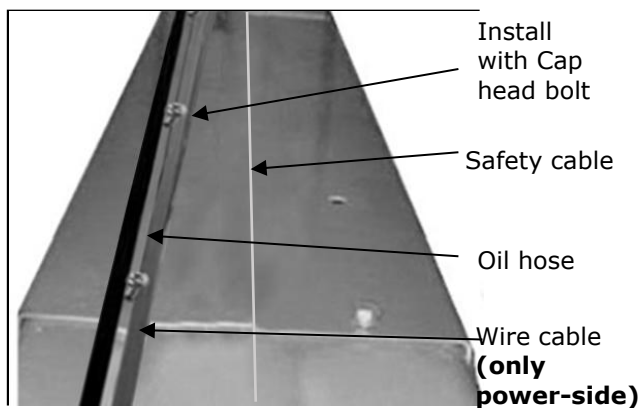

Before install the wire protective cover
Fig. 34

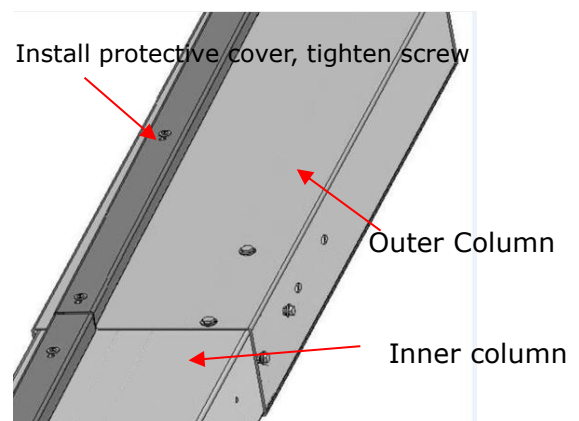

After install the wire protective cover
Fig. 35

The safety cable cannot be put **through** cable clamp on top of overhead beam

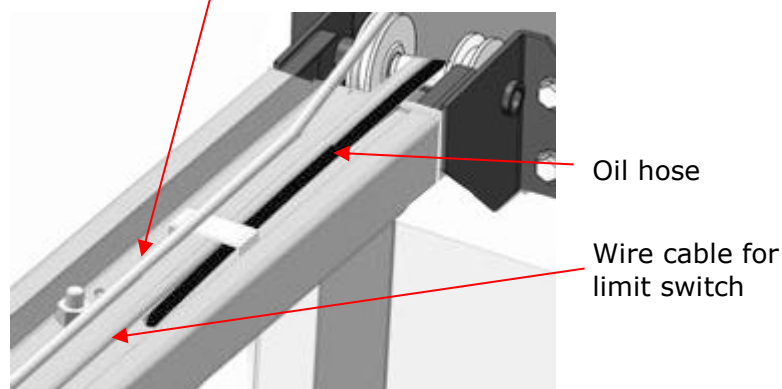

Fig. 36

P. Install lifting arms and adjust the arm locks.

1. Install the lifting arms (**See Fig. 37**).
2. Lowering the carriages down to the lowest position, then use the 8# socket head wrench to loosen the socket bolt (**See Fig. 38**).

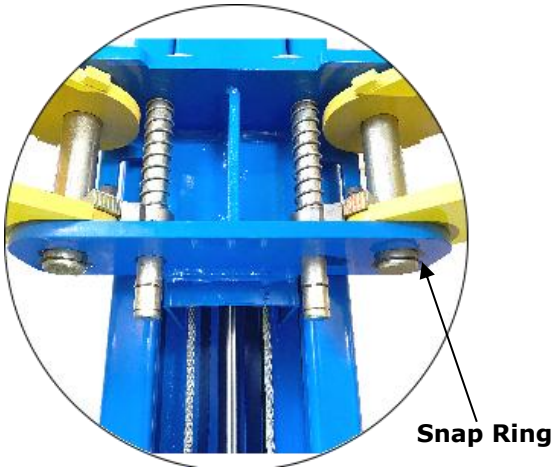

Fig. 37

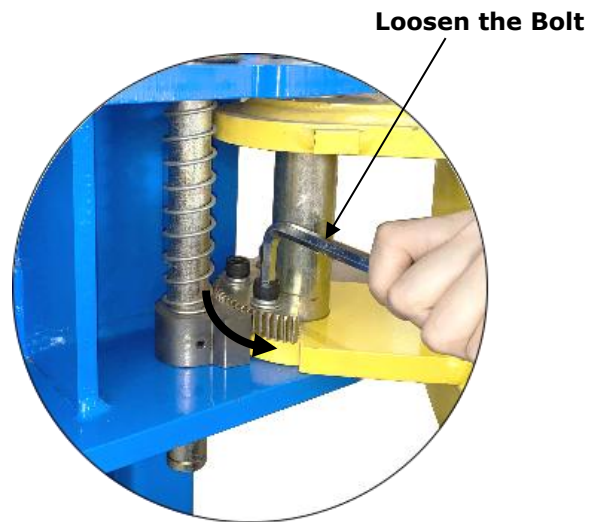

Fig. 38

Use the 8# Socket Head Wrench to loosen the Socket Bolt.

3. Adjust the arm lock as direction of arrow (**See Fig. 39**)

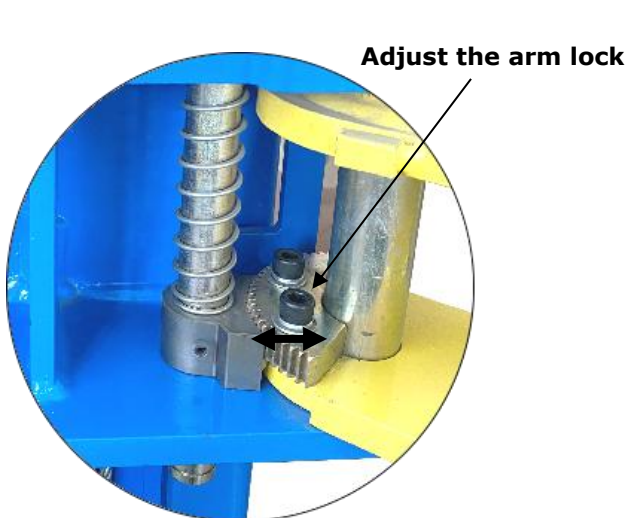

Fig. 39

Adjusting moon gear and arm lock to mesh.

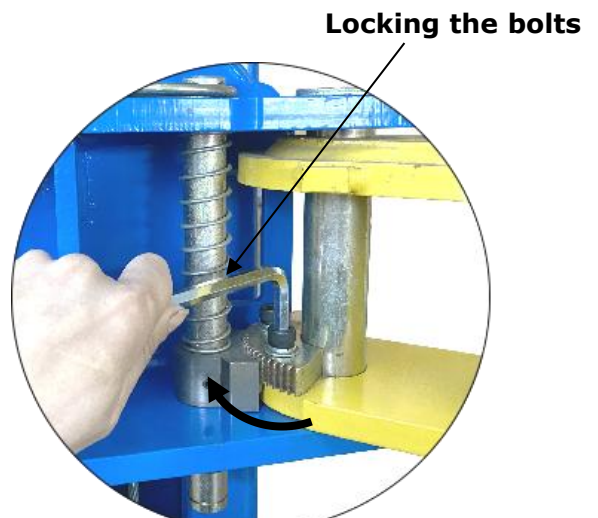

Fig. 40

Locking the bolts after the moon gear and arm lock engaged well.

4. Adjust moon gear and arm lock to make it to be meshed, then tighten the socket bolts of arm lock (**See Fig. 40**).

Q. Tighten all the hydraulic fittings, and fill the reservoir with hydraulic oil.

Note: In consideration of Hydraulic Power Unit's durability and keep the equipment running in the perfect condition, please use Hydraulic Oil 46#.

R. Install electrical system

Connect the power source according to the nameplate of the motor.

Note: 1. Install the limit switch.

2. For the safety of operators, the lift must connect with the ground wire.

Single phase motor wiring

1. Circuit diagram (See Fig.41)

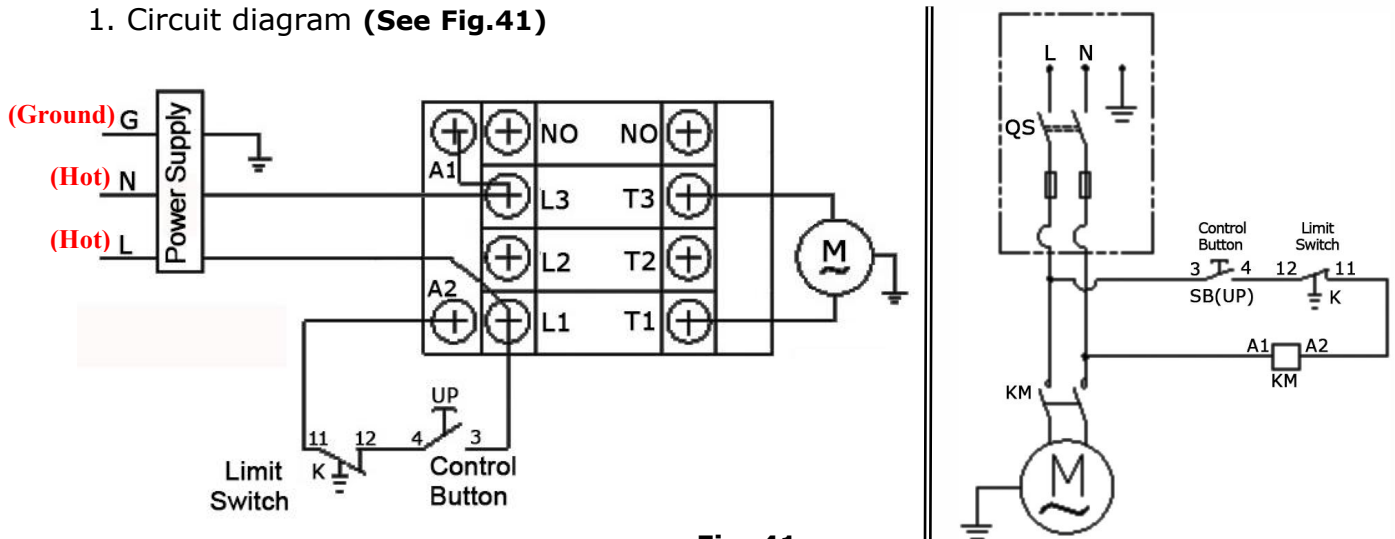

Fig. 41

2. Connection step

a. Connecting the two power supply wires to terminals of AC contactor marked L1, L3 respectively.

b. Connecting the limit switch: Removing the wire of connecting terminal 4# of control button and A2 of AC contactor firstly (See Fig. 42), then connecting wire 12# (brown wire) of limit switch with terminal 4# of control button and connecting wire 11# (blue wire) with terminals A2 of AC contactor respectively. Connecting the earth wire of limit switch to the earth wire terminal on the motor. (See Fig.43).

c. Terminals 3# of control button is connected with L1 terminals of AC contactor.

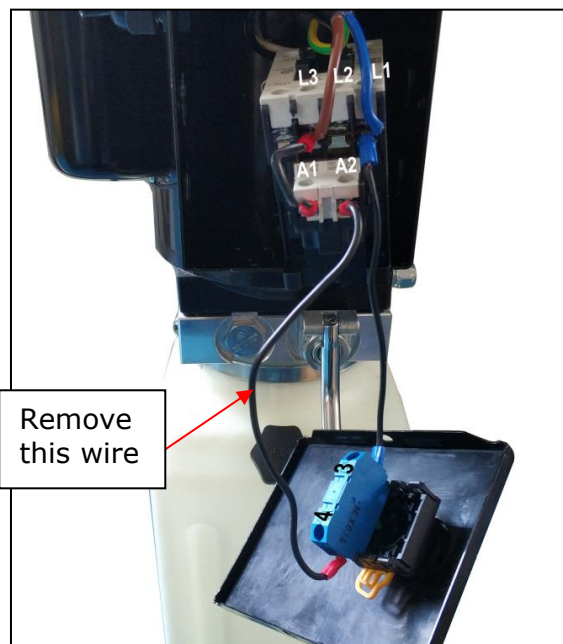

Fig. 42

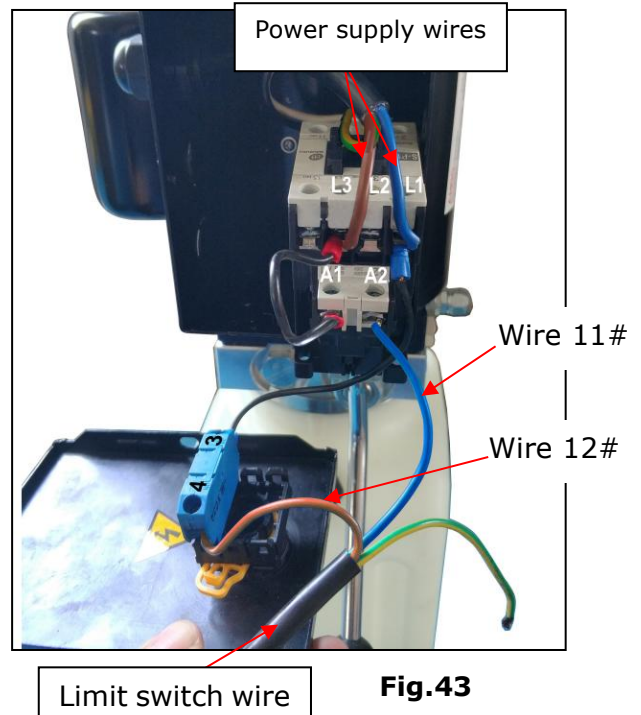

Fig.43

IV. EXPLODED VIEW

OH-9/OH-9H/OH-10/OH-10H

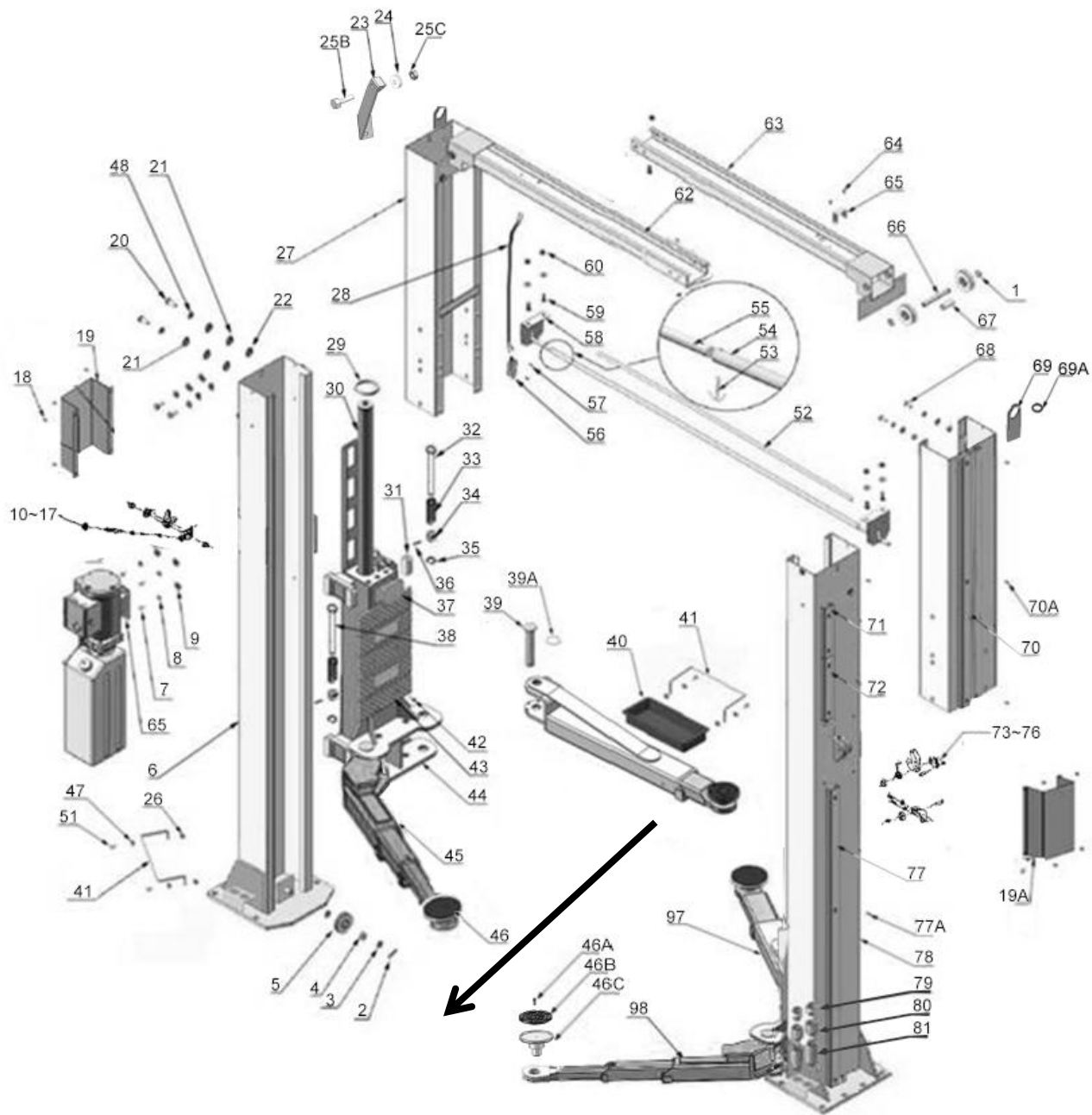

Fig. 44

PARTS LIST

Item	Part No.	Description	QTY.			
			OH-9	OH-9H	OH-10	OH-10H
1	10206019	Snap Ring ϕ 19	4	4	4	4
2	10209012	Elastic latch ϕ 3.2	2	2	2	2
3	10209128	Washer ϕ 20	4	4	4	4
4	10209057A	Bronzed bush for Pulley ϕ *25.4* ϕ 19.1*14.5	6	6	6	6
5	11206020	Pulley	6	6	6	6
6	11206202	Power-side Inner Column	1	1	0	0
	11279023		0	0	1	1
7	10209003	Hex Bolt M8*25	8	8	8	8
8	10209004	Rubber Ring ϕ 8*20*3	4	4	4	4
9	10209005	Self-locking Nut M8	8	8	8	8
10	11217436	Safety device spacer ϕ 27*15	2	2	2	2
11	11217006	Safety device control stick	1	1	1	1
12	10217005	Plastic ball M10	1	1	1	1
13	10206023A	Hex bolt M12	1	1	1	1
14	10420026	Lock Washer ϕ 12	1	1	1	1
15	10206006	Washer ϕ 12	27	27	27	27
16	11217009	Safety device	1	1	1	1
17	11217012	Safety device spacer ϕ 27*10	2	2	2	2
18	10209009	Cap head screw M6*8	10	10	10	10
19	11217405	Cover for power-side safety device	1	1	1	1
19A	11217406	Cover for offside safety device	1	1	1	1
20	10209126	Hex Bolt M10*25	20	20	20	20
21	10209022	Washer ϕ 10	40	40	40	40
22	10209021	Hex Nut M10	20	20	20	20
23	11217379	Safety Cable Bracket	2	2	2	2
24	10206009	Plastic Pulley (white)	3	3	3	3
25	10217013	Hex bolt M6*20	8	8	8	8
25A	10420018	Self-locking nut M6	8	8	8	8
25B	10209046	Hex bolt M10*35	3	3	3	3
25C	10209056	Self-locking nut M10	3	3	3	3
26	10209033	Washer ϕ 8	12	12	12	12
27	11206204	Extension Column L=1240mm	2	0	0	0
	11206207	Extension Column L=1850mm	0	2	0	0
	11203221	Extension Column L=1240mm	0	0	2	0
	11203222	Extension Column L=1850mm	0	0	0	2
28	10206137	Wire Cable L=3700	1	0	1	0
	10206138	Wire Cable L=4310	0	1	0	1
29	10209111	Protective Ring for Cylinder	2	2	2	2
30	11217056	Cylinder ϕ 50*1727	2	2	2	2
31	10209015	Slider Block	16	16	16	16
32	11217046A	Arm Lock Bar (left)	2	2	2	2
33	10206050A	Spring	4	4	4	4
34	10217044-01	Arm Lock	4	4	4	4
35	206032	Snap Ring ϕ 25	4	4	4	4
36	10206036	Hair Pin ϕ 6*40	4	4	4	4
37	10209016	Carriage Plastic Cover	2	2	2	2

Item	Part No.	Description	QTY.			
			OH-9	OH-9H	OH-10	OH-10H
38	11217046	Arm Lock Bar (right)	2	2	2	2
39	11217168	Arm pin assy.	4	4	4	4
39A	10520023	Snap Ring $\phi 38$	4	4	4	4
40	10206190	Tool tray (Short)	2	2	2	2
41	11206191	Toe guard bar	4	4	4	4
42	10209019	Screw M6*16	12	12	12	12
43	10209018	Protective Rubber	2	2	2	2
44	11279004	Carriage	2	2	2	2
45	10279010	Front right Arm	1	1	1	1
45A	10279009	Front left Arm	1	1	1	1
46	10201046A	Rubber pad assy.	4	4	4	4
46A	10420138	Hex bolt M6*16	12	12	12	12
46B	10209134	Rubber pad	4	4	4	4
46C	11680030C	Rubber pad bracket	4	4	4	4
47	10209034	Lock Washer $\phi 8$	14	14	14	14
48	10209039	Lock washer $\phi 10$	32	32	32	32
49	10209059	Anchor bolt 3/4*5-1/2	12	12	12	12
50	10206500B	Parts box	1	0	1	0
	10206501B		0	1	0	1
51	10201002	Hex Bolt M8*16	14	14	14	14
52	10206025A	Foam Cushion with handle	1	1	1	1
53	10201005	Split Pin $\phi 4*50$	2	2	2	2
54	11206129	Control Bar L=2400mm	1	1	1	1
55	11206025C	Connecting Pin for Control Bar	2	2	2	2
56	10206013	Limit Switch	1	1	1	1
57	10206011	Cap Head Bolt M5*12	2	2	2	2
58	11206042	Control Bar Support Bracket	2	2	2	2
59	10206041	Hex Bolt M12*20	4	4	4	4
60	10206023	Self-locking Nut M12	12	12	12	12
61	10209056	Self-locking Nut M10	4	4	4	4
62	11206195	Top Beam (Part A)	1	1	1	1
63	11206196	Top Beam (Part B)	1	1	1	1
64	10206028	Cap Head Bolt M5*8	4	4	4	4
65	071101	Power unit	1	1	1	1
66	11206021	Pin for Pulley	2	2	2	2
67	11206022	Top Pulley spacer	2	2	2	2
68	10206024	Hex Bolt M12*25	8	8	8	8
69	11217024	Oil hose retainer	2	2	2	2
69A	1061K074	Wire guard	2	2	2	2
70	11203752	Wire protective cover L=1140	2	0	2	0
	11203756	Wire protective cover L=1750	0	2	0	2
70A	10206110	Cap head bolt M6*35	6	6	6	6
71	11206084	Protective Cover(L=200mm)	2	2	2	2
72	11206083	Protective Cover(L=385mm)	2	2	2	2
73	11217004	Active safety control block	1	1	1	1
74	11217029	Safety Pulley Bracket	1	1	1	1
75	10217008	Torsion spring $\phi 2.5*145^\circ$	1	1	1	1

Item	Part No.	Description	QTY.			
			OH-9	OH-9H	OH-10	OH-10H
75A	10217030	Torsion spring $\phi 2.5 \times 120^\circ$	2	2	2	2
76	11217031	Driven safety control block	1	1	1	1
76A	10217032	Wire cable connecting pin	1	1	1	1
76B	11217033	Tension nut	1	1	1	1
77	10203778	Protective Cover L=1545	2	2	2	2
77A	10206079	Cap Head Bolt M6*40	14	14	14	14
78	11206203	Offside Inner column	1	1	0	0
	11279024		0	0	1	1
79	11209051B	Stackable Adapter (1.5")	4	4	4	4
80	11209052B	Stackable Adapter (2.5")	4	4	4	4
81	11209053B	Stackable Adapter (5")	4	4	4	4
82	10217066	Anchor Bolt M6*15	2	2	2	2
83	10209149	Washer $\phi 6$	10	10	10	10
84	10420045	Washer $\phi 6$	26	26	26	26
85	10206064A	Cable l=10048mm	2	0	2	0
	10206064B	Cable L=11268mm	0	2	0	2
86	10206132-01	Oil hose L=4470mm	1	0	2	0
	10206133-01	Oil hose L=5080mm	0	1	0	2
87	10209060	90° fitting for power unit	1	1	1	1
87A	10211016	T fitting	1	1	1	1
88	10209064	Straight Fitting	2	2	2	2
89	10206062	Straight Fitting	2	2	2	2
90	11233009	Oil hose straight fitting(square)	2	2	2	2
91	10206130-01	Oil Hose L=5350mm	2	0	2	0
	10206131-01	Oil Hose L=5960mm	0	2	0	2
92	10260149	Safety cable L=7750mm	1	0	1	0
	10206065A	Safety cable L=8970mm	0	1	0	1
93	10209066	Hex nut M16	8	8	8	8
94	10201090	Shim (1mm)	10	10	10	10
	10620065	Shim (2mm)	10	10	10	10
95	10209152	Ties 3*150mm	4	4	4	4
96	10279011	Rear Arm assy.	2	2	2	2
97	1102075001	Cable limit plate	4	4	4	4
98	10217010	Hex bolt M6*40	1	1	1	1
99	10217011	Hex nut M6	1	1	1	1
100	10217051	Socket bolt M10*10	2	2	2	2
101	11217050	Safety device pin	2	2	2	2
102	10209066	Nut M16	8	8	8	8

4.1 Rear arm assy. (10279011) explosive view

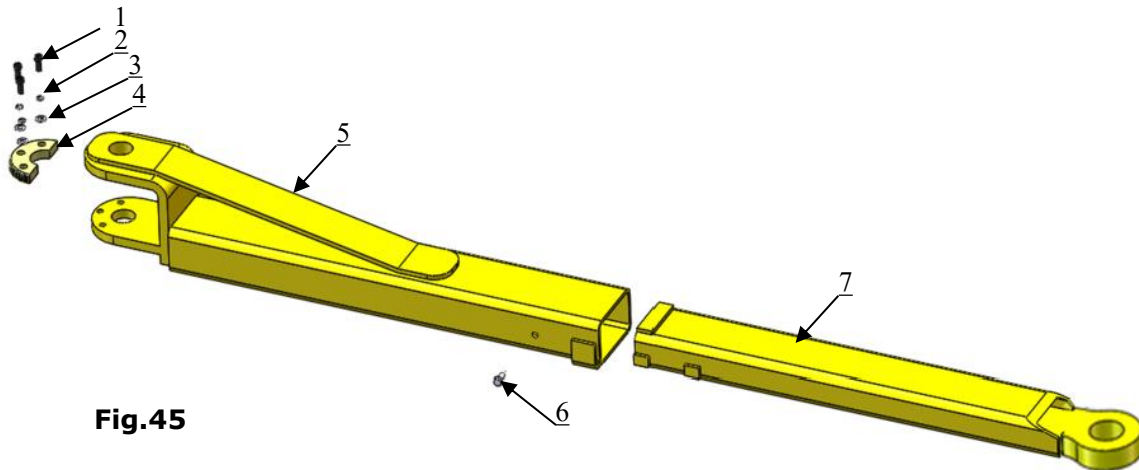

Fig.45

Item	Part No.	Description	QTY.
1	10206048	Hex nut M10*30	6
2	10209039	Washer $\phi 10$	6
3	10209022	Washer $\phi 10$	6
4	11206049	Moon gear	2
5	11206192	Rear outer arm	2
6	10201149	Cap head bolt M8*12	2
7	11206193	Rear inner arm	2

4.2 Left front arm assy. (10279009) explosive view

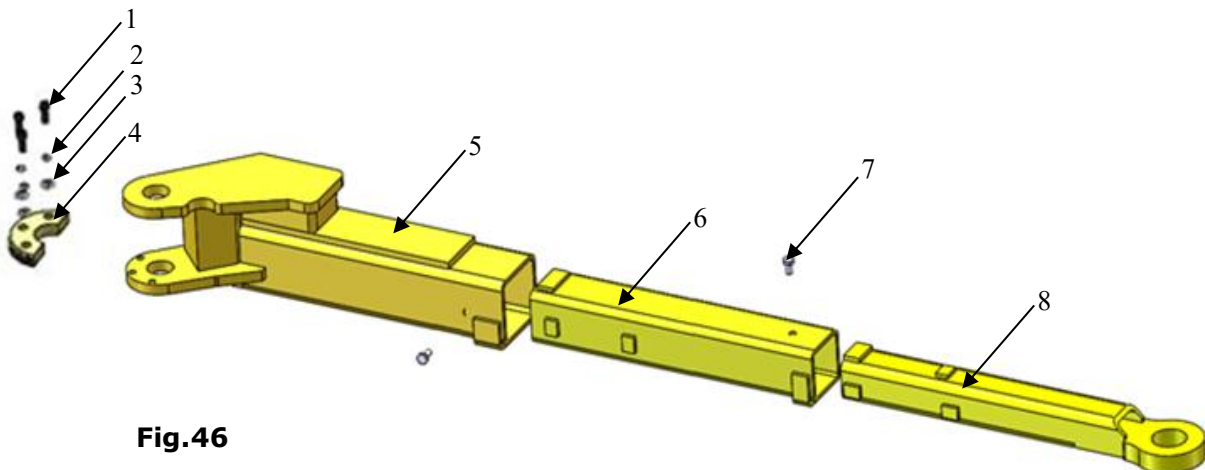

Fig.46

Item	Part No.	Description	QTY.
1	10206048	Hex nut M10*30	3
2	10209039	Washer $\phi 10$	3
3	10209022	Washer $\phi 10$	3
4	11206049	Moon gear	1
5	11206182	Front left outer arm	1
6	11206189	Front middle arm	1
7	10201149	Cap head bolt M8*12	2
8	11201049A	Front inner arm	1

4.3 Right front arm assy. (10279010) explosive view

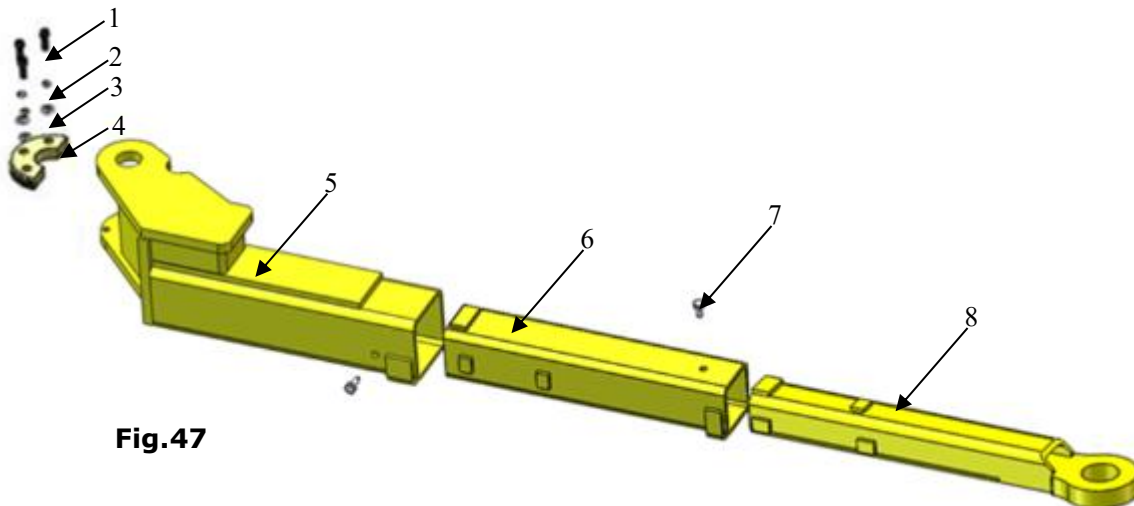

Fig.47

Item	Part No.	Description	QTY.
1	10206048	Hex nut M10*30	3
2	10209039	Washer φ10	3
3	10209022	Washer φ10	3
4	11206049	Moon gear	1
5	11206183	Front right outer arm	1
6	11206189	Front middle arm	1
7	10201149	Cap head bolt M8*12	2
8	11201049A	Front inner arm	1

4.4 Cylinder (11217056) explosive view

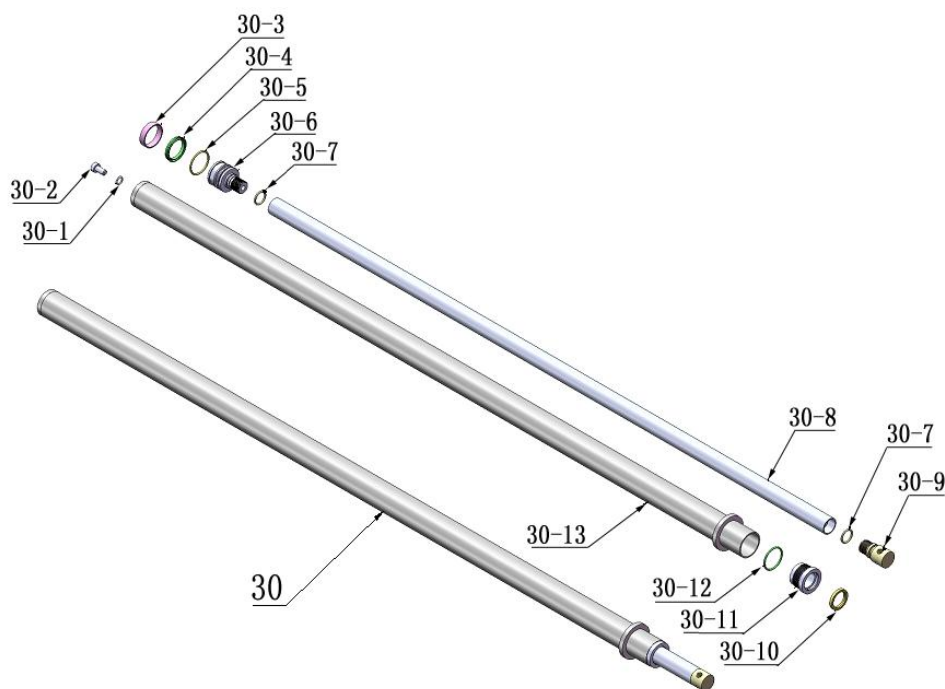

Fig. 48

Part list for cylinder

Item	Part No.	Description	QTY.
30-1	10209069	O-ring	2
30-2	10209070	Bleeding Plug	2
30-3	10209071	Support Ring	2
30-4	10209072	Y-ring OSI	2
30-5	10209073	O-ring	2
30-6	11209074	Piston	2
30-7	10209075	O-Ring	2
30-8	11217076	Piston rod	2
30-9	11209077	Piston Rod Fitting	2
30-10	10209078	Dust wing	2
30-11	11209079	cover	2
30-12	10209080	O ring	2
30-13	11209081A	Bore Weldment	2

4.5 Power unit (071101) explosive view

single phase,220V/60HZ

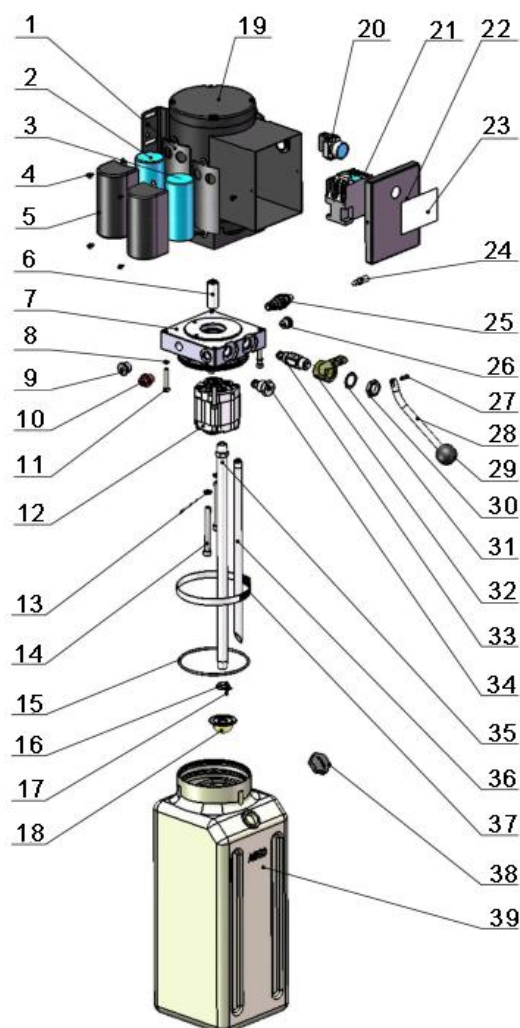

Fig. 49

Part list of power unit (220V/60HZ/single phase)

Item	Part No.	Description	QTY.	Item	Part No.	Description	QTY.
1	81400180	Rubber pad	2	21	41030055	AC contractor	1
2	81400250	Starting capacitor	1	22	81400287	Motor wiring cover	1
3	81400200	Running capacitor	1	23	71111104	AMGO label	1
4	10420148	Screw with washer	4	24	81400560	Throttle valve	1
5	81400066	Capacitor cover	2	25	81400266	Relief valve	1
6	81400363	Motor connector	1	26	81400284	Plug	1
7	090101	Manifold block	1	27	10720118	Elastic pin	1
8	10209149	Washer	4	28	81400451	Release handle	1
9	81400276	Iron Plug	1	29	10209020	Plastic ball for handle	1
10	81400259	Red rubber plug	1	30	81400421	Release valve nut	1
11	85090142	Hex bolt	4	31	81400422	Self-locking washer	1
12	81400280	Gear pump	1	32	81400449	valve seat(short)	1
13	10209034	washer	2	33	81400567	Release valve	1
14	81400295	Hex nut	2	34	81400566	Check valve	1
15	81400365	O-ring	1	35	81400288	Oil suction hose	1
16	10209152	Ties	1	36	81400289	Oil return hose	1
17	85090167	Magnet	1	37	81400364	Clamp(stainless steel)	1
18	81400290	Filter	1	38	81400263	Oil tank cap	1
19	81400413	Motor	1	39	81400275	Oil tank	1
20	10420070	Button switch	1				

4.6 Illustration of hydraulic valve for hydraulic power unit

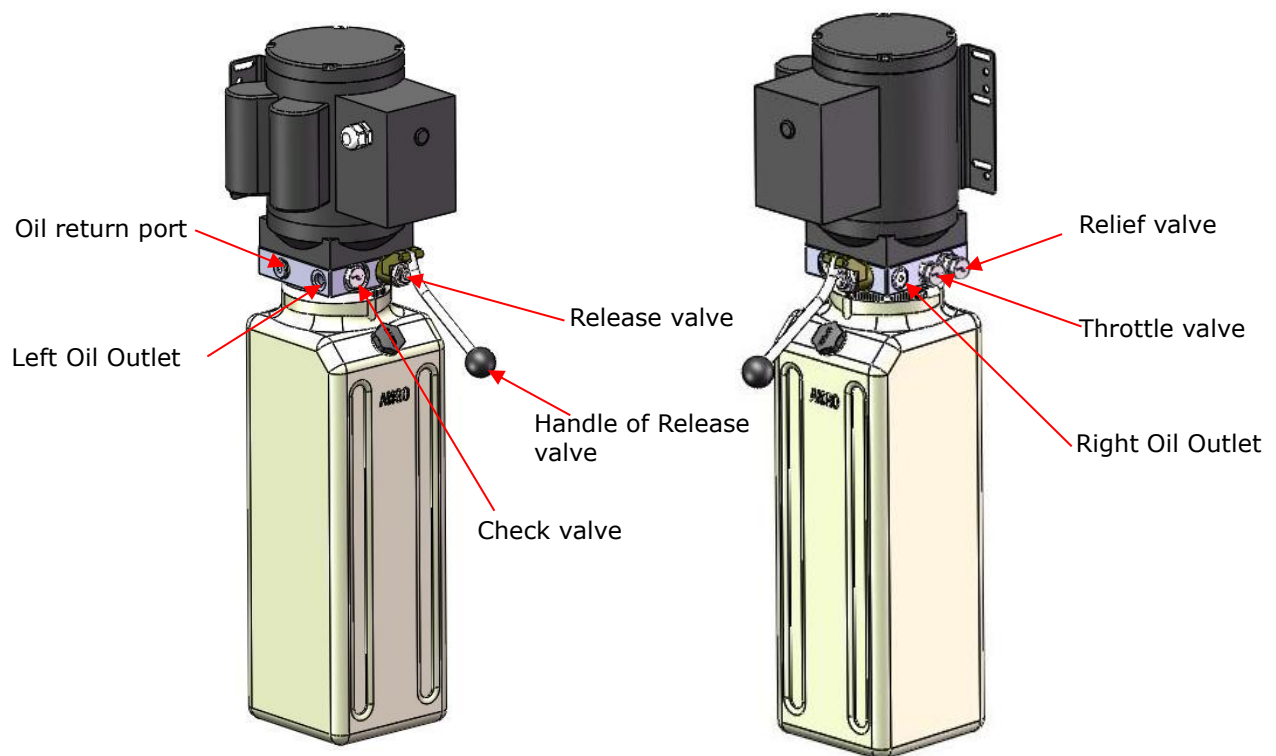

Fig.50

V. TEST RUN

1. Adjustment of synchronous cable (See Fig. 51)

Use wrench to hold the cable fitting, meanwhile using ratchet spanner to tighten the cable nut until the two cables are in the same tension.

If the two vehicle carriages do not Synchronized when lifting and lowering, please screw and tighten the cable nut on the lower side carriage.

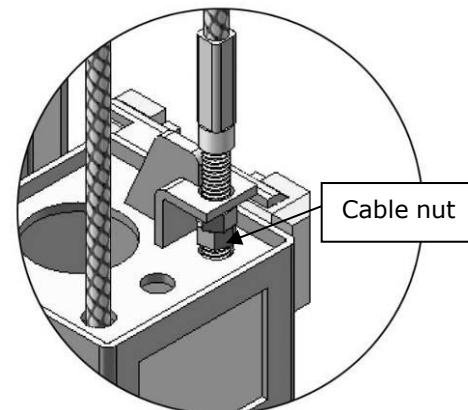

Fig. 51

2. Adjust safety cable

Rise the vehicle carriages and lock them at the same height, strain the safety cable and then release a little, and then tighten the safety cable nuts. Make sure the safety device can always lock the carriages properly.

At last, install the plastic cover of the safety device.

3. Bleeding air from oil cylinder (See Fig. 52)

Rise the vehicle carriages and lock them at the same height, strain the safety cable and then release a little, and then tighten the safety cable nuts. Make sure the safety device can always lock the carriages properly.

At last, install the plastic cover of the safety device.

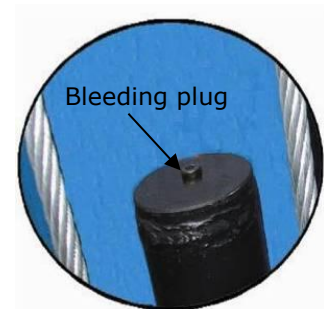
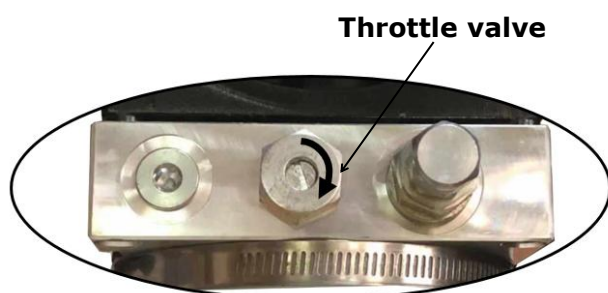

Fig. 52

4. Adjust the lowering speed

You can adjust the lowering speed of the lift if needing: screw the throttle valve clockwise to decrease the lowering speed, or counterclockwise to increase the lowering speed.



Adjust clockwise, decrease lowering speed

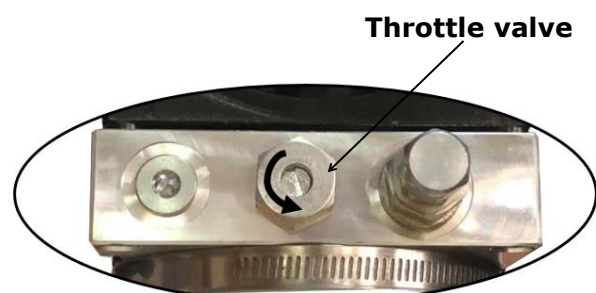

Counterclockwise, increase lowering speed

Fig. 53

5. Test with load

After finishing the above adjustment, test running the lift with load. Run the lift in low position for several times firstly, make sure the lift can rise and lower synchronously, the Safety Device can lock and release synchronously. And then test run the lift to the top completely. If there are anything improper, repeat the above adjustment.

NOTE: It may be vibrated when lifting at start, please lifting it with load for several times, the air would be bled and the vibration would be disappeared automatically.

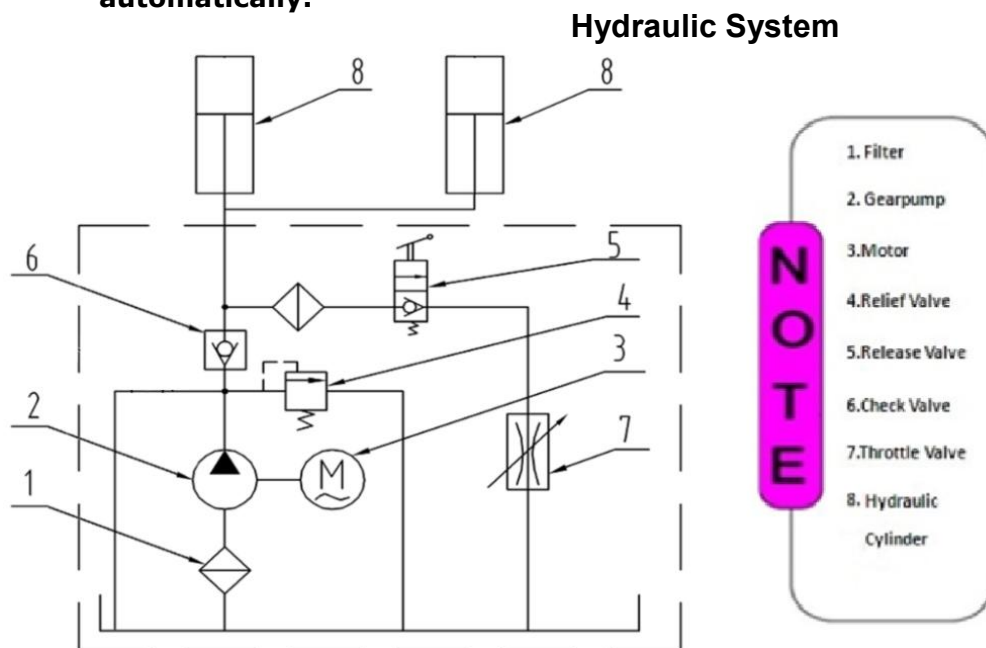

Fig.54

VI. OPERATION INSTRUCTIONS

Please read the safety tips carefully before operating the lift

To lift vehicle

1. Keep clean of site near the lift;
2. Position lift arms to the lowest position;
3. To shortest lift arms;
4. Open lift arms;
5. Position vehicle between columns;
6. Move arms to the vehicle's lifting point;

Note: The four lift arms must contact the vehicle's lifting point at the same time where manufacturers recommended

7. Push button **UP** until the lift pads contact underside of vehicle totally. Recheck to make sure vehicle is secure;
8. Continue to raise the lift slowly to the desired working height, ensuring the balance of vehicle;
9. Push release handle to lower lift onto the nearest safety. The vehicle is ready to repair.

To lower vehicle

1. Be sure clear of around and under the lift, only leaving operator in lift area;
2. Push button **UP** to raise the vehicle slightly, and then release the safety device, lower vehicle by pushing release handle.
3. Open the arms and position them to the shortest length;
4. Drive away the vehicle.
5. Turn off the power.

Note: In order to extend the service life of the cylinder and seals, raise the machine to top at least once a day

VII. MAINTENANCE SCHEDULE

Monthly:

1. Re-torque the anchor bolts with 150 N·M;
2. Check all connectors, bolts and pins to insure proper mounting;
3. Lubricate cable with lubricant;
4. Make a visual inspection of all hydraulic hoses/lines for possible wear or leakage;
5. Check Safety device and make sure proper condition;
6. Lubricate all Rollers and Pins with 90wt. Gear oil or equivalent;

Note: All anchor bolts should take full torque. If any of the bolts is malfunction for any reason, DO NOT use the lift until the bolt has been replaced.

Every six months:

1. Make a visual inspection of all moving parts for possible wear, interference or damage.
2. Check and adjust as necessary, equalizer tension of the cables to insure level lifting.
3. Check columns for plumbness.
4. Check Rubber Pads and replace as necessary.
5. Check Safety device and make sure in proper condition.

Oil cylinder maintenance:

In order to extend the service life of the oil cylinder, please operate according to the following requirements.

1. Recommend to use N46 anti-wear hydraulic oil.
2. The hydraulic oil of the lifts should be replaced regularly during using. Replace the hydraulic oil 3 months after the first installation, Replace the hydraulic oil once a year afterwards.
3. Make at least one full trip raising and lowering per day. For exhausting the air from the system, which could effectively avoid the corrosion of the cylinder and damage to the seals caused by presence of air or water in the system.
4. Protect the outer surface of the oil cylinder's piston rod from bumping and scratching, and timely clean up the debris on the oil cylinder dust-ring and the piston rod.

VIII. TROUBLE SHOOTING

TROUBLE	CAUSE	REMEDY
Motor does not run	<ol style="list-style-type: none">1. Button does not work2. Wiring connections are not in good condition3. Motor burned out4. Height Limit Switch is damaged5. AC contactor burned out	<ol style="list-style-type: none">1. Replace button2. Repair all wiring connections3. Repair or replace motor4. Replace the Limit Switch5. Replace AC Contactor
Motor runs but the lift is not raised	<ol style="list-style-type: none">1. Motor runs in reverse rotation2. Gear Pump out of operation3. Release Valve in damage4. Relief Valve or Check Valve in damage5. Low oil level	<ol style="list-style-type: none">1. Reverse two power wire2. Repair or replace3. Repair or replace4. Repair or replace5. Fill tank
Lift does not stay up	<ol style="list-style-type: none">1. Release Valve out of work2. Relief Valve or Check Valve leakage3. Cylinder or Fittings leaks	Repair or replace
Lift raises too slow	<ol style="list-style-type: none">1. Oil line is jammed2. Motor running on low voltage3. Oil mixed with air4. Gear Pump leaks5. Overload lifting	<ol style="list-style-type: none">1. Clean the oil line2. Check Electrical System3. Fill tank4. Replace Pump5. Check load
Lift cannot lower	<ol style="list-style-type: none">1. Safety device are in activated2. Release Valve in damage3. Safety cable broken4. Oil system is jammed	<ol style="list-style-type: none">1. Release the safeties2. Repair or replace3. Replace4. Clean the oil system

IX. Lift disposal.

When the car lift cannot meet the requirements for normal use and needs to be disposed, it should follow local laws and regulations.



AMGO HYDRAULIC CORPORATION

1931 Joe Rogers Blvd, Manning, South Carolina,
Zip: 29102

Tel: (803) 505-6410

Fax: (803) 505-6410

Manual No.: 72228005

Revised date: 2022/05